

Dear customer!

Thank you for choosing this quality product from ASKO.

We hope it will meet your expectations and fulfil your needs for many years to come. Scandinavian design combines clean lines, everyday functionality and high quality. These are key characteristics of all our products and the reason they are greatly appreciated throughout the world.

To get the most out of your new dishwasher, we recommend that you read the operating instructions before using the dishwasher. The operating instructions also include information on how you can help protect the environment.

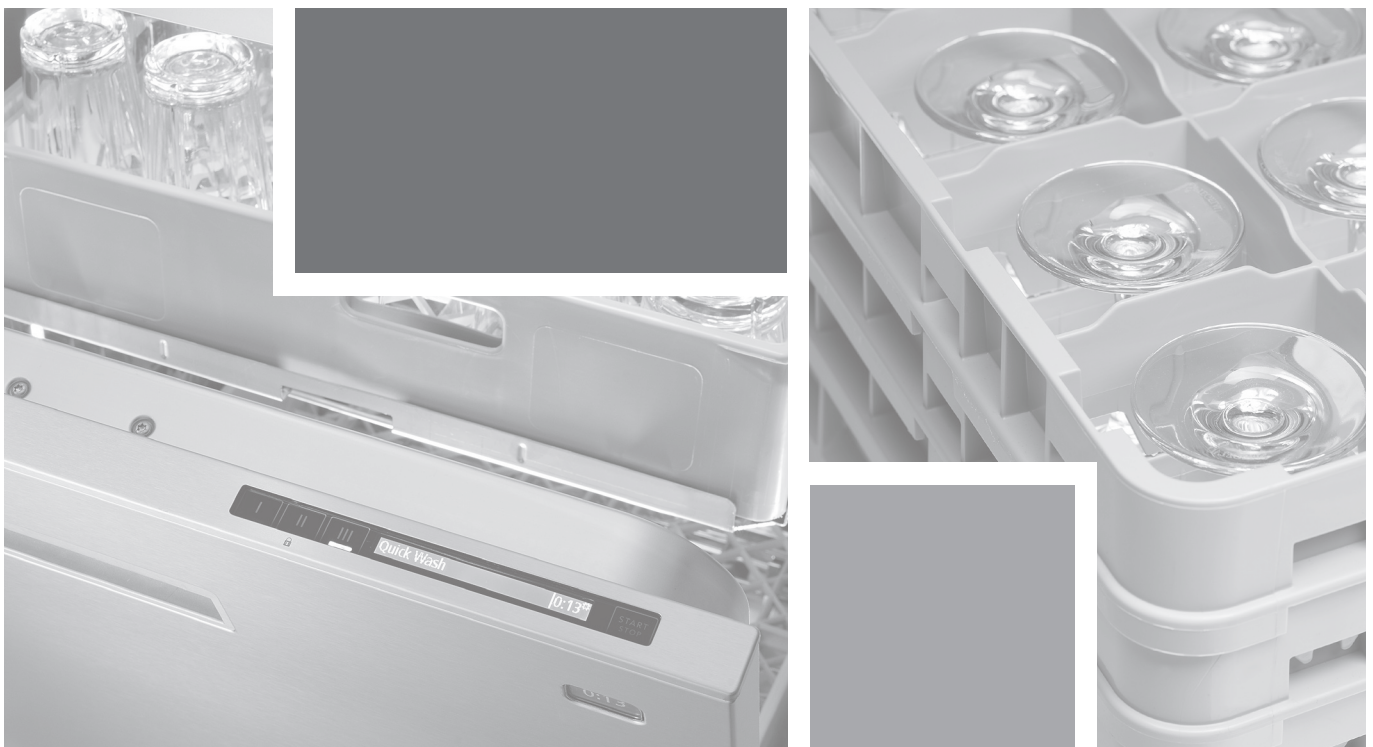

Operating instructions

Dishwasher
ASKO DWCF5936

Contents

Front panel	2	Care and cleaning	12
Safety instructions	3	Troubleshooting	14
Before washing for the first time	4	Technical information	18
Loading the dishwasher	5	Installation	19
Using the dishwasher	7	Service	23
Settings	9	Program chart	24

Front panel

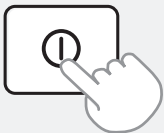

To start the machine, press and hold the main power switch until the display lights up.

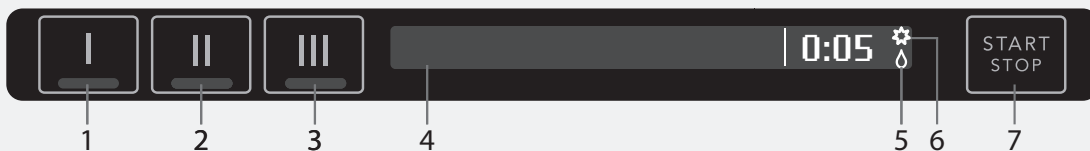

1. Program button 1*
2. Program button 2*
3. Program button 3*
4. Display
5. Rinse aid indicator (not active if an automatic dosing system is connected)
6. Salt indicator
7. Start/Stop

*Optional program. (To programme the program buttons, see Select programs in section Settings on page 9.)

The panel is fitted with touch buttons with audible feedback (see the chapter Settings).

NOTE!

- 60 minutes after the last button press, the machine will switch off to save energy.

Safety instructions

General

- Read the operating instructions and keep them in a safe place!
- Never use the dishwasher for any purpose other than that specified in these operating instructions.
- Do not load the dishwasher door, basket carriers or dishwasher baskets with anything other than dishes.
- Never leave the dishwasher door open as someone may trip on it.
- Only use powder and liquid dishwasher detergent in the dishwasher's detergent compartment. (If an automatic dosing system is connected, the dishwasher's detergent compartment must not be used).
- Only use commercial detergent and rinse aid in external compartments if an automatic dosing system is connected. (Commercial dishwasher detergent adapted for automatic dosing systems should not be used in the dishwasher's detergent dispensing compartment. Commercial rinse aid adapted for automatic dosing systems should not be used in the dishwasher's rinse aid dispensing compartment.)
- Follow the supplier's safety regulations concerning the handling and storage of detergent and rinse aid.
- Place knives and other sharp items so that they cannot harm anyone or damage the dishwasher.
- The inside of the dishwasher reaches high temperatures when a program is in progress. Be careful when opening the door. Let the dish load cool before taking it out.
- Do not touch the heating elements in the bottom of the dishwasher, as they are very hot during and just after a dishwashing program has ended.
- This machine can be used by children aged 8 and upwards, and by people with reduced physical capacity, mental ability, memory loss or lacking experience and knowledge. These individuals must be supervised when using the machine or have instructions on how to use the machine and understand the risks that can occur. Cleaning of the machine must not be carried out by children without supervision.
- Children must be watched to ensure they do not play with the dishwasher.
- Damaged mains cables must only be replaced by a qualified electrician.
- This dishwasher is for household or similar use, such as:
 - staff kitchens in shops, offices and other workplaces.
 - farms.
 - for guests at hotels, motels and other types of accommodation.
 - bed & breakfast hotels.

The dishwasher can also be used in professional work environments such as restaurants, cafés/bistros, bars, bed & breakfast hotels, campsites and marinas.

- Never place dishes with solvent residues in the dishwasher due to the risk of explosion. Nor may dishes that contain ash, wax or lubricants be washed in the dishwasher.
- For repairs and maintenance, original spare parts must be used.

WARNING!

The property's main power switch must be switched off or power to the socket turned off during cleaning, maintenance or when replacing parts!

Installation

Read the safety instructions before installing. See section Installation.

Child safety

- Always close the door and start the program immediately after you have added the detergent.
- Keep children away from the dishwasher when the door is open. Some detergent may remain inside!
- Do not allow children to use or play with the dishwasher. Be especially vigilant when the door is open.

WARNING!

Children must be supervised – dishwasher detergent is corrosive! Follow the supplier's safety regulations concerning the handling and storage of detergent and rinse aid.

Store detergent and rinse aid out of the reach of children! If anyone swallows dishwasher detergent, they should immediately drink one or two glasses of milk or water. Do not attempt to induce vomiting. Contact a doctor! If anyone gets dishwasher detergent in their eyes, rinse (for at least 15 minutes) with plenty of water.

Activate child lock (button lock)

You can activate the child lock (button lock) to prevent children from starting the dishwasher (see the section Settings on page 9).

Winter storage/transport

- Store the dishwasher where the temperature remains above freezing.
- Avoid long transport distances in very cold weather.
- Transport the dishwasher upright.

Overflow guard

The overflow protection starts draining and ends any program in progress if the water level in the dishwasher exceeds the normal level. If the protective cap is triggered, turn off the water supply and call the service department.

Cleaning

When cleaning the edge around the door, use only a slightly damp cloth. Do not spray water around the edge! Moisture can make its way into the lock, which contains electrical components.

Packaging

Please sort waste materials in accordance with local guidelines.

Disposal

The dishwasher is manufactured and labelled for recycling.

When the dishwasher has reached the end of its service life and is to be disposed of, it should immediately be made unusable. Pull out the power cable and cut it as short as possible.

Contact your local authority for information about where and how your dishwasher should be correctly recycled.

Before washing for the first time

Automatic dosing system

The dishwasher can be connected to an automatic dosing system for commercial detergent and rinse aid which simplifies daily use and reduces the risk of overdosing.

In section Installation on page 19 and in section Settings on page 9 the process for connecting and activating an automatic dosing system is described.

Add the commercial detergent and rinse aid adapted for automatic dosing systems to their respective external compartments in good time to prevent air getting into the system. Acid rinse aid is recommended for hard water (water with a high mineral content).

! WARNING!

Note that there are risks involved in handling commercial detergent and rinse aid. Protective gloves and goggles must be used when handling these products.

Follow the supplier's safety regulations concerning the handling and storage of detergent and rinse aid.

Checking water hardness

In order to achieve good dishwashing results, the dishwasher needs soft water (water with low mineral content). Hard water leaves a white coating on dishes and the dishwasher.

Water hardness is specified using the German water hardness scale (°dH) or the French water hardness scale (°fH).

A water supply with a water hardness in excess of 6°dH (9°fH) must be softened. This is done automatically with the aid of the built-in water softener. In order for the water softener to function optimally, it must be adjusted to the hardness of the water supply. Once you have adjusted the water softener, use detergent and rinse aid doses suitable for soft water. test

Contact the local waterworks to check the water hardness in your area.

Make a note of the water hardness: _____

German water hardness scale	French water hardness scale	Recommended setting
0-3°dH	0-5°fH	0
4-5°dH	6-9°fH	1
6-8°dH	10-14°fH	2
9-11°dH	15-20°fH	3
12-14°dH	21-25°fH	4
15-19°dH	26-34°fH	5
20-24°dH	35-43°fH	6
25-29°dH	44-52°fH	7
30-39°dH	53-70°fH	8
40°dH	71°fH	9

If the water hardness exceeds 20°dH (36°fH), we recommend connecting an external water softener.

! WARNING!

Hard water leaves a white coating on dishes and the dishwasher. It is therefore important that you select the right setting for the water softener!

Never run the dishwasher with an empty salt compartment if the water supply has a water hardness in excess of 6°dH (9°fH).

Adjusting the water softener

In section Settings on page 9 the process for setting the water softener is described. Do not forget to put salt in the salt compartment after you have set the water softener.

Pre-selected at factory: 6

Top up with salt

Before you begin using a dishwasher with a water softener, you must fill the salt compartment with salt. Use large grain salt or special dishwasher salt.

! WARNING!

Top up the salt just before running a program. To avoid the risk of rust stains, the dishwasher must be rinsed immediately after topping up the salt.

Never pour dishwasher detergent into the salt compartment. This destroys the water softener!

Do as follows the first time:

1. Unscrew the lid as illustrated.
2. Place the funnel supplied with the dishwasher in the salt compartment top-up hole. First, pour in about 1 l of water.
3. Then add salt, a maximum of 1.5 kg, until the compartment is full.
4. Wipe up any excess salt so that the lid can be screwed on firmly.
5. Run a program to ensure that any salt in the dishwasher is rinsed away.

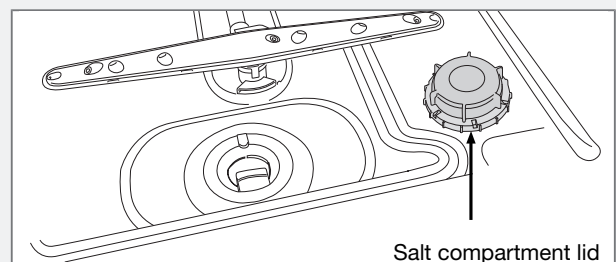

Refill salt indicator

When the salt needs topping up, the above symbol lights on the display.

When the salt runs out, unscrew the cap and fill the container with salt. Water is only needed the first time! Wipe clean and tighten. Run a program to ensure that any salt in the dishwasher is rinsed away.

NOTE!

After topping up, it may take a while before the symbol goes out.

Loading the dishwasher

Top up with rinse aid

Add the rinse aid to the rinse aid compartment if the dishwasher is not connected to an automatic dosing system for commercial rinse aid.

Drying is faster and a better result is achieved if you use rinse aid. You will also achieve a better dishwashing result with clear and spotless dishes. Acid rinse aid is recommended for hard water (water with a high mineral content).

1. Open the rinse aid compartment lid.
2. Carefully top up with rinse aid. Only add rinse aid to the level marked **max**.
3. Wipe up any splashes of rinse aid around the compartment.
4. Close the lid firmly.

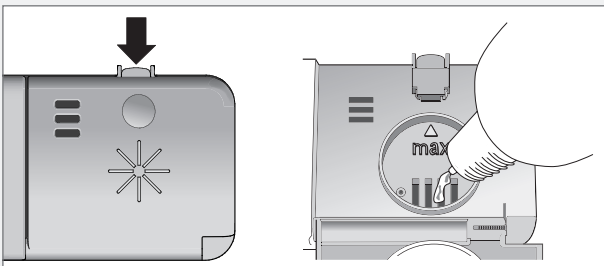

NOTE!

Commercial rinse aid adapted for automatic dosing systems should not be used in the dishwasher's rinse aid dispensing compartment.



Refill rinse aid indicator

When the dishwasher's rinse aid compartment needs topping up, the above symbol lights on the display.

NOTE!

After topping up, it may take a while before the symbol goes out.

Setting the rinse aid dosage

The section Settings describes how to set the rinse aid dosage. Rinse aid dispensing can be set to On or Off.

Activate rinse aid dosage:

- If the dishes have water marks.
- Spots or films on the dishes.

Deactivate rinse aid dosage:

- If the dishes have a sticky white/blue film.
- If the dishes are streaked.
- Build-up of foam. If you have very soft water, the rinse aid can be diluted 50:50 with water.

Fragile dishes

Some cookware is not dishwasher safe. This can be for several reasons. Some materials cannot withstand strong heat, others can be damaged by dishwashing detergent.

Fragile decoration

Porcelain with decoration on top of the glazing (the items feel rough) should not be washed in a dishwasher.

Crystal/Glass

Place items so that they do not touch each other during the wash. Use a short program with the lowest possible wash temperature. Antique and very fragile items should not be washed in a dishwasher.

Glass washed in a dishwasher at high temperatures can gradually develop a grey film that cannot be removed. Wash fine glassware at a low temperature and with a small amount of detergent.

Silver

Silver and stainless steel items should not come into contact, as the silver can become discoloured.

Cutlery with glued handles

Some types of glue are not dishwasher safe. In such cases, the handles may loosen.

Wood

Wooden items should only be washed in a dishwasher if marked dishwasher safe.

Aluminium

Aluminium can lose its shine if washed in a dishwasher. However, good quality aluminium pans can be washed in a dishwasher, even if some of the shine will be lost.

Plastic items

Avoid washing plastic items that cannot withstand high temperatures.

Dishwasher baskets and basket carriers

There is space for two standard-sized plastic dishwasher baskets in the dishwasher 500 x 500 mm. The dishwasher baskets are placed into the dishwasher's adapted basket carriers.

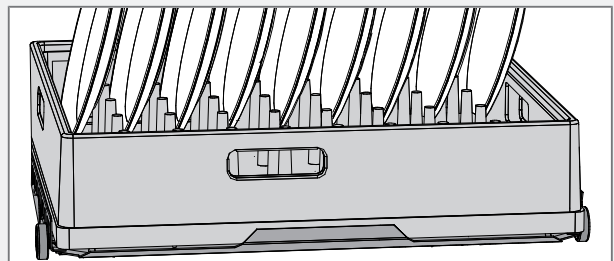

NOTE!

Check that the plastic dishwasher baskets are placed within the edges of the basket carriers.

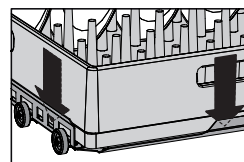

Upper basket carrier

Place dishes into a plastic dishwasher basket with dirty surfaces facing inwards and downwards. Place the dishwasher basket onto the dishwasher's upper basket carrier.

Check that the spray arms can rotate freely.

The upper basket carrier is supplied in the lower position, but can be moved up to make more space for the lower dishwasher basket if large items are being washed.

Raising the upper basket carrier

1. Pull out the basket carrier. (Lift out any plastic dishwasher baskets.)
2. Turn the basket catch outwards at the end of both runners.
3. Grip the basket carrier with both hands, pull it out and move the basket carrier to the upper position.
4. Slide the spray pipe connection up to the upper position to connect it with the upper spray arm.

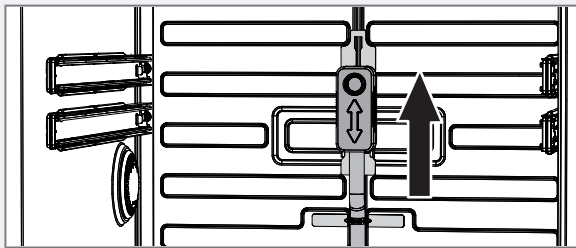

5. Turn back the basket catch at the end of both runners.

NOTE!

Check the spray pipe connection is connected to the upper spray arm.

Lowering the upper basket carrier

1. Pull out the basket carrier. (Lift out any plastic dishwasher baskets.)
2. Turn the basket catch outwards at the end of both runners.
3. Grip the basket carrier with both hands, pull it out and move the basket carrier down to the lower position.
4. Slide the spray pipe connection down to the lower position to connect it with the upper spray arm.

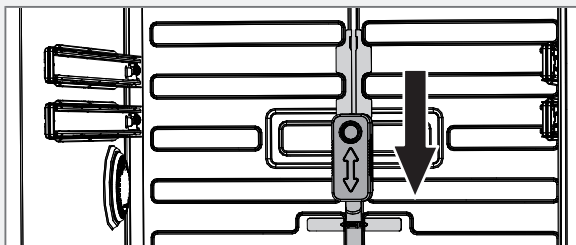

5. Turn back the basket catch at the end of both runners.

NOTE!

Check the spray pipe connection is connected to the upper spray arm.

Lower basket carrier

Place dishes into a plastic dishwasher basket with dirty surfaces facing inwards and downwards. Place the dishwasher basket

onto the dishwasher's lower basket carrier. Check that the spray arms can rotate freely.

Cutlery

Use adapted cutlery baskets. Place cutlery with the handles facing down, except for knives, and spread them out as much as possible. Ensure that spoons do not stack inside each other. Alternatively, lie the cutlery horizontally in a dishwasher basket.

! WARNING!

Knives and other pointed items must be placed with the points down in an adapted cutlery basket or lain horizontally in a dishwasher basket.

NOTE!

Do not place cutlery made of different materials, such as silver and stainless steel, in the same place (risk of discolouration).

NOTE!

Check that the spray arms can rotate freely.

Using the dishwasher

Automatic dosing system

The dishwasher can be connected to an automatic dosing system for commercial detergent and rinse aid which simplifies daily use and reduces the risk of overdosing.

In section Installation on page 19 and in section Settings on page 9 the process for connecting and activating an automatic dosing system is described.

Add the commercial detergent and rinse aid adapted for automatic dosing systems to their respective external compartments in good time to prevent air getting into the system.

⚠ WARNING!

Note that there are risks involved in handling commercial detergent and rinse aid. Protective gloves and goggles must be used when handling these products.

Follow the supplier's safety regulations concerning the handling and storage of detergent and rinse aid.

NOTE!

Powder or liquid dishwasher detergent must not be used in the dishwasher's detergent compartment if the dishwasher is connected to an automatic dosing system.

Add detergent

Add the detergent to the detergent compartment if the dishwasher is not connected to an automatic dosing system for commercial detergent.

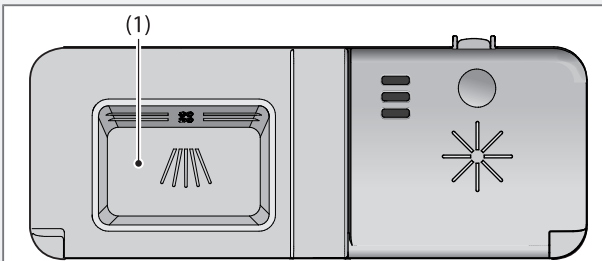

1. Main wash detergent compartment

Detergent is added according to water hardness.

Follow the instructions on the detergent packaging. This dishwasher is fitted with a water softener, so use detergent and rinse aid doses suitable for soft water.

Too much detergent can result in less effective dishwashing and also entails greater environmental impact.

Add the detergent to the detergent compartment. Contact the detergent manufacturer if you have questions about the detergent.

⚠ WARNING!

Children must be supervised – dishwasher detergent is corrosive!

NOTE!

Only use powder and liquid dishwasher detergent in the dishwasher's detergent compartment. Dishwasher tablets are not recommended. Washing up liquid must not be used as the foam that forms prevents the dishwasher from operating effectively.

Commercial dishwasher detergent adapted for automatic dosing systems should not be used in the dishwasher's detergent dispensing compartment.

Detergent with high enzyme content

If detergent with high enzyme content will be used, we recommend a program with a low temperature for the main wash and a high temperature for the final rinse. Program A, Program B and Program C can be designed according to the business's specific needs. Create a program with prewash, long main wash at a low temperature (40 °C) and final rinse at a high temperature (60 °C or 70 °C). See "Create program" in section Settings on page 9.

ⓘ The main power switch

Press and hold the main power switch until the display lights up. The message "Open to unlock" is shown on the display. Open the door to activate the panel.

Program selection

Press one of the program buttons 1, 2 and 3. (To program the program buttons, see Select programs in section Settings on page 9.)

Quick Wash

Short programs for lightly soiled/rinsed dishes such as glasses and coffee cups.

Quick Wash Universal

Short programs for rinsed dishes. (Not dried leftovers.)

Universal

Standard program for normally soiled/scraped dishes. (Not dried leftovers.)

Universal Plus¹⁾

Efficient program for very dirty dishes with slight dried leftovers. (Not burnt-on food such as in gratin dishes.)

Intensive¹⁾

Powerful program for extremely dirty dishes.

Wine Glasses

Gentle program for fragile dishes such as fine glassware.

Beer Glasses

Program specially adapted for robust beer glasses. No rinse aid is dispensed during the final rinse. The final rinse is carried out automatically in cold water if it is connected.

Rinse

Program for rinsing dishes.

Drain

Program for pumping out water, for example in the event of programs being interrupted.

¹⁾ An automatic dosing system for detergent must be connected for the program to function optimally in both prewash and main wash (otherwise the program's prewash will be deactivated). In section Installation on page 19 and in section Settings on page 9 the process for connecting and activating an automatic dosing system is described.

Program A / Program B / Program C ¹⁾

Programs which can be adapted for specific needs. See "Create program" in section Settings on page 9.

Starting the dishwasher

Press and hold Start/Stop until the display shows "Program started". This indicates that the dishwasher is ready to start. Close the door properly, or the dishwasher will not start.

NOTE!

If the machine does not start within 2 minutes of the last button press, the display returns to showing the last program run.

Information on the front display.

The front display shows Show remaining time, Show temperature and/or Show wash sequence. Select the information you want displayed on the front display. See "Operating information" in section Settings on page 9.

Show time

Once you have selected a program, the display indicates how long the program took last time it was used. Once you have started the dishwasher, the display indicates how much program time remains.

This may differ somewhat from time to time depending on the temperature of the water supply, the amount of dishes, the ambient temperature and other factors.

While the program is running, the time counts down and the remaining program time is shown on the display. The remaining time is shown, for example, as 1:15, which means the program will run for another 1 hour and 15 minutes.

NOTE!

During the first run of each program, the remaining time displayed can be slightly misleading, as the dishwasher is estimating the time. When you run the program a second time, the dishwasher will calculate the remaining time based on the previous duration of the program.

Show temperature

The washing water's current temperature is shown on the display.

Show dishwashing sequence

The current dishwashing sequence is shown on the display.

Stopping or changing a program

A program should only be interrupted if it is absolutely necessary.

Open the door, press and hold Start/Stop for three seconds if you want to interrupt the program after you have started the dishwasher. Refill the detergent (this happens automatically if an automatic dosing system is connected). Then select a new program, press Start/Stop and close the door.

WARNING!

Risk of burns if the dishwasher door opens while a program is in progress. Note that the inside of the dishwasher reaches a high temperature, especially during the final rinse.

If the dishwasher is switched off using the main power switch or during a power cut

If the dishwashing program was not finished, the interrupted program continues when power is restored.

Once the program has finished

Once the program has finished, "END" appears on the display.

A buzzer also sounds at the end of the program. See the section Settings, which describes how to change this function.

The dishwasher switches off automatically 60 minutes after the program ends. Shut off the water tap if the dishwasher is not used for a long time.

WARNING!





The inside of the dishwasher reaches high temperatures when a program is in progress. Be careful when opening the door. Let the baskets cool before taking them out.

Do not touch the heating elements in the bottom of the dishwasher, as they are very hot during and just after a dishwashing program has ended.



Settings



Open the Function Menu:

	Button press	Description
1.		Turn off the machine. Open the door. Press and hold the main power switch until the display lights up.
2.	 	Within 20 seconds; - press the button 2, 5 times. - press the button 3, 5 times.
3.		The display shows Function Menu. Confirm your selection by pressing Start/Stop. (Exit the menu by pressing on the button PROG until Exit? is shown on the display. Confirm your selection by pressing Start/Stop.)

Navigate the Function Menu:

	Button press	Description
		Press the program button 1 to scroll through the settings.
		Press Start/Stop to save the setting and continue to the next menu stage. (Exit the menu by pressing on the button PROG until Exit? is shown on the display. Confirm your selection by pressing Start/Stop.)

TIP!

To make any future servicing easier, make note of selected settings in the Function Menu.

You can change the following settings in the Function Menu:

Settings	Alternatives																																		
1. Language	English/Svenska/Dansk/Norsk/ Suomi/Français/Deutsch/Italiano/ Español/Nederlands/Русский	You can choose the language used for the display.																																	
2. Temp. in last program		The washing water's highest temperature in the last run program is shown in the display.																																	
3. Automatic dosing system	Dispense detergent	Vent the automatic dosing system by activating Dispense detergent and Dispense rinse aid.																																	
	Dispense rinse aid																																		
	Detergent: On/Off	Activate Detergent if the dishwasher is connected to an automatic dosing system. <i>Detergent will be added for 30 seconds during the main wash.</i>																																	
	Rinse aid: On/Off	Activate Rinse aid if the dishwasher is connected to an automatic dosing system. <i>Rinse aid will be added for 30 seconds during the final rinse.</i>																																	
	Spray pressure: High/Normal	Only select High if the dishwasher is connected to an automatic dosing system.																																	
4. Child lock	Child lock: On/Off	You can activate the child lock (button lock) to prevent children from starting the dishwasher.  To temporarily deactivate and activate the child lock, press and hold the button above the symbol for five seconds. (The child lock activates automatically again after two minutes.)																																	
5. Temperature unit	Celsius/Fahrenheit	Temperatures can be displayed in °C (Celsius) or °F (Fahrenheit).																																	
6. Operating information	Show remaining time: On/Off	Select what information should be shown on the front display under the program in progress. (If Off is selected on all programs, the remaining time will be shown.)																																	
	Show temperature: On/Off																																		
	Show wash sequence: On/Off																																		
7. Signal volume	Off/Low/Mid/High	The dishwasher uses a buzzer to indicate when a program is finished or when a fault has occurred.																																	
8. Button volume	Off/Low/Mid/High	This sound is used to confirm each button press.																																	
9. LCD contrast	LCD contrast: 1/2/3/4	For adjusting the contrast in the displays.																																	
10. Rinse aid	Rinse aid: On/Off	Settings for dispensing rinse aid. (Only active if Automatic dosing system for rinse aid is set on Off.)																																	
11. Water hardness	Water hardness: 0-9	Adjusting the water softener. Select a setting depending on the hardness of the water supply. It is important that this setting is correct!																																	
		<table border="1"> <thead> <tr> <th>German water hardness scale</th> <th>French water hardness scale</th> <th>Recommended setting</th> </tr> </thead> <tbody> <tr> <td>0-3°dH</td> <td>0-5°fH</td> <td>0</td> </tr> <tr> <td>4-5°dH</td> <td>6-9°fH</td> <td>1</td> </tr> <tr> <td>6-8°dH</td> <td>10-14°fH</td> <td>2</td> </tr> <tr> <td>9-11°dH</td> <td>15-20°fH</td> <td>3</td> </tr> <tr> <td>12-14°dH</td> <td>21-25°fH</td> <td>4</td> </tr> <tr> <td>15-19°dH</td> <td>26-34°fH</td> <td>5</td> </tr> <tr> <td>20-24°dH</td> <td>35-43°fH</td> <td>6</td> </tr> <tr> <td>25-29°dH</td> <td>44-52°fH</td> <td>7</td> </tr> <tr> <td>30-39°dH</td> <td>53-70°fH</td> <td>8</td> </tr> <tr> <td>40°dH</td> <td>71°fH</td> <td>9</td> </tr> </tbody> </table>	German water hardness scale	French water hardness scale	Recommended setting	0-3°dH	0-5°fH	0	4-5°dH	6-9°fH	1	6-8°dH	10-14°fH	2	9-11°dH	15-20°fH	3	12-14°dH	21-25°fH	4	15-19°dH	26-34°fH	5	20-24°dH	35-43°fH	6	25-29°dH	44-52°fH	7	30-39°dH	53-70°fH	8	40°dH	71°fH	9
		German water hardness scale	French water hardness scale	Recommended setting																															
		0-3°dH	0-5°fH	0																															
		4-5°dH	6-9°fH	1																															
		6-8°dH	10-14°fH	2																															
		9-11°dH	15-20°fH	3																															
		12-14°dH	21-25°fH	4																															
		15-19°dH	26-34°fH	5																															
		20-24°dH	35-43°fH	6																															
		25-29°dH	44-52°fH	7																															
30-39°dH	53-70°fH	8																																	
40°dH	71°fH	9																																	
		<i>High setting for the water softener in the event of problems with white coatings on the dishes and in the dishwasher.</i>																																	

Settings	Alternatives			
12. Water connection	Water connection: Single/Mix	Select Single if the dishwasher is connected to cold or hot water. Select Mix if the dishwasher is connected to both cold and hot water.		
13. Create program	Design your own dishwashing program (Program A, Program B and Program C) according to your business's specific needs.			
	<table border="1"> <tr> <td>NOTE!</td> </tr> <tr> <td>If an automatic dosing system is connected or disconnected, check the following settings for the each program: Spray pressure, Prewash 1, Prewash 2.</td> </tr> </table>		NOTE!	If an automatic dosing system is connected or disconnected, check the following settings for the each program: Spray pressure, Prewash 1, Prewash 2.
NOTE!				
If an automatic dosing system is connected or disconnected, check the following settings for the each program: Spray pressure, Prewash 1, Prewash 2.				
-Create program A	<i>Pre-programmed: Prewash 1: Off, Prewash 2: Off, Main wash temp.: 45 °C, Main wash time: 5 min., Spray pressure: Normal, Rinse 1: Cold, Rinse 2: Off, Rinse 3: Off, Final rinse temp.: 45 °C, Final rinse hold. time: 1 min.</i>			
-Create program B	<i>Pre-programmed: Prewash 1: Warm, Prewash 2: Off, Main wash temp.: 60 °C, Main wash time: 20 min., Spray pressure: Normal, Rinse 1: Warm, Rinse 2: Cold, Rinse 3: Off, Final rinse temp.: 65 °C, Final rinse hold. time: 5 min.</i>			
-Create program C	<i>Pre-programmed: Prewash 1: Cold, Prewash 2: Warm, Main wash temp.: 70 °C, Main wash time: 45 min., Spray pressure: Normal, Rinse 1: Warm, Rinse 2: Cold, Rinse 3: Off, Final rinse temp.: 75 °C, Final rinse hold. time: 15 min.</i>			
	1. Prewash 1 ¹⁾	Off/Cold/Warm (50 °C) <i>Only activate Prewash if the dishwasher is connected to an automatic dosing system.</i>		
	2. Prewash 2 ¹⁾	Off/Cold/Warm (50 °C) <i>Only activate Prewash if the dishwasher is connected to an automatic dosing system.</i>		
	3. Main wash temp.	Select the temperature for the main wash (20 °C-70 °C).		
	4. Main wash time	Select the time for the main wash (5-20 min.).		
	5. Spray pressure	High/Normal <i>Only select High if the dishwasher is connected to an automatic dosing system.</i>		
	6. Rinse 1	Off/Cold/Warm (50 °C)		
	7. Rinse 2	Off/Cold/Warm (50 °C)		
	8. Rinse 3	Off/Cold/Warm (50 °C)		
	9. Final rinse temp.	Select the temperature for the final rinse (40 °C- 85 °C). <i>The maximum temperature may increase somewhat (2 °C) to guarantee that the final rinse maintains a fixed temperature the entire time.</i>		
	10. Final rinse hold. time	Select a holding time for the selected temperature during final rinse (1-15min.).		
	-Save Program	Confirm the settings by pressing Start/Stop.		
14. Select programs	Quick Wash, Quick Wash Universal, Universal, Universal Plus, Intensive, Wine Glasses, Beer Glasses, Rinse, Drain, Program A, Program B, Program C	Select the program to be active on the program buttons 1, 2 and 3.		

¹⁾ An automatic dosing system for detergent must be connected and must in the Function Menu Automatic dosing system be set at Detergent:On, otherwise the program's Prewash 1 and Prewash 2 will be deactivated.

Care and cleaning

⚠ WARNING!

The property's main power switch must be switched off or power to the socket turned off while work is being carried out!

Coarse filter

The coarse filter traps larger food particles, which cannot get past the drainage pump. Empty the coarse filter when necessary.

1. Lift the coarse filter by the handle.
2. Empty the coarse filter. Remember to refit it!

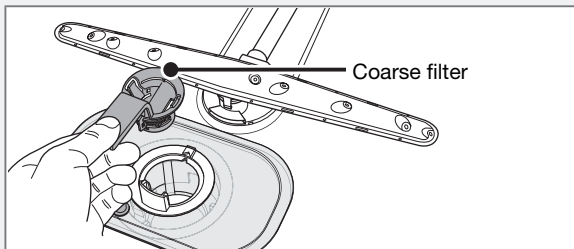

Fine filter

Debris that collects on the fine filter is automatically rinsed away during each wash. Clean the fine filter when necessary.

1. Turn the handle anticlockwise once.

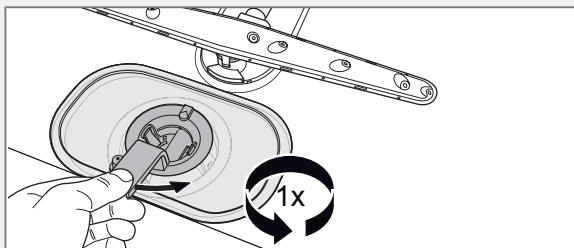

2. Lift the filter straight up using the handle. Free the coarse filter to clean the fine filter.

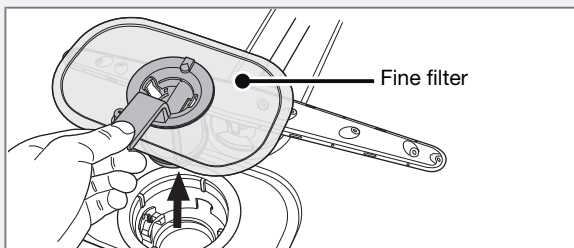

3. Check that the coloured stop on the right in the bottom drain is in place.
4. Refit in reverse order. Check that the edges seal properly when refitting the fine filter.

5. Lock the filter in place by turning the handle clockwise to the stop position. The handle should point straight out from the dishwasher.

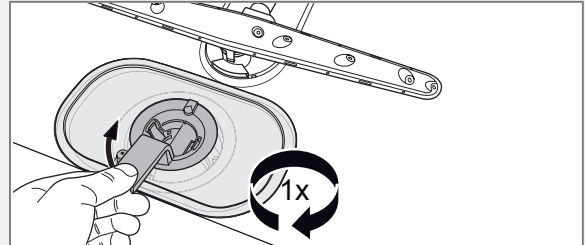

NOTE!

Dishwashing results may be affected if the filters are incorrectly fitted. Note that the dishwasher must not be used without the filters in place!

Drainage pump

If the water has not been pumped out of the dishwasher when the dishwashing program ends, the drainage pump may be blocked by foreign matter. The pump can be accessed from inside the dishwasher.

1. Cut the power to the dishwasher by switching off the property's main power switch.
2. Remove the coarse filter and the fine filter.
3. Remove the small yellow fitted piece to the left of the bottom drain by depressing the catch in the direction of the arrow (see illustration below).

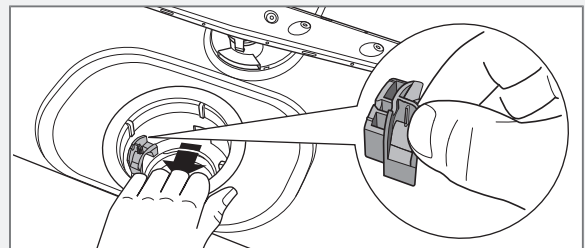

4. By inserting your finger into the hole you can turn the pump blade to release anything blocking it.

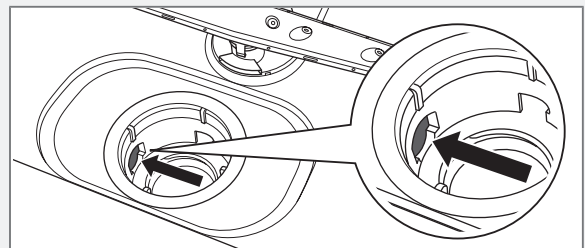

5. Reinstall the fitted piece and then the filters.
 6. Switch on the property's main power switch.
- If the dishwasher still does not start and a whirring sound is heard, the overflow protection has been activated.

- Shut off the water.
- Switch off the property's main power switch.
- Call the service department.

NOTE!

Do not forget to reinstall the fitted piece.

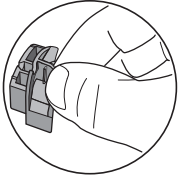

Spray arms

Holes and bearings can sometimes become blocked. Remove any debris using a pin or the like. The spray arms also have holes underneath.

To facilitate cleaning you can remove the spray arms. Do not forget to refit them.

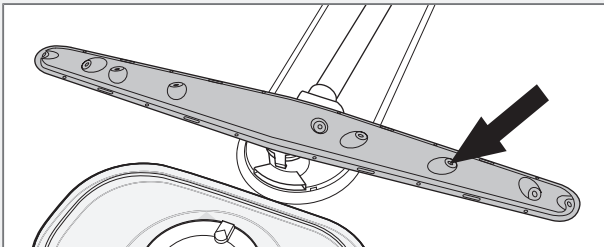

Lower spray arm

- Pull the lower spray arm straight up to release it.

Upper spray arm

1. Pull out the basket carrier.
2. Unscrew the spray arm bearings as illustrated to remove the spray arm from the upper basket carrier.

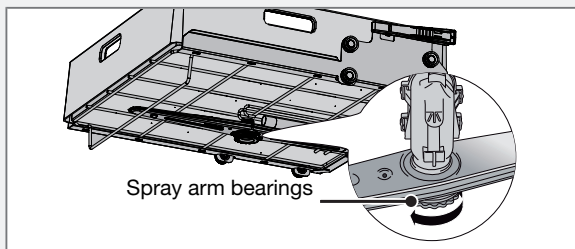

Cleaning the outside of the machine

Clean the outside of the machine and the program panel with a mild cleaner. Do not use any solvents, as these can damage the machine.

NOTE!

Do not hose down the machine with water!

Door

When cleaning the edge around the door, use only a slightly damp cloth (with a little cleaner if necessary).

! WARNING!

Do not use a spray bottle or the like around the door lock. This is to ensure that water does not penetrate the door catch and come into contact with the electrical components.

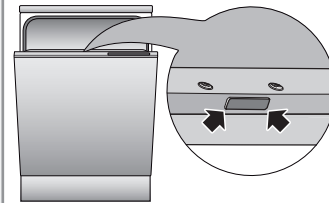

Limescale deposits

The dishwasher tub is made of stainless steel and is kept clean through normal use. If you have hard water, limescale deposits may build up in the dishwasher. If this happens, run a program with two tablespoons of citric acid in the detergent compartment (with no dishes in the machine). (If an automatic dosing system is connected, it should be deactivated when cleaning with citric acid to achieve the desired effect.)

Front panel

Keep the sensor buttons clean and free from grease. Dry them with a dry or slightly damp cloth. Never use cleaning agents – these may scratch the surface. Turn off the dishwasher using the main power switch when cleaning the sensor buttons to avoid involuntary button pressing.



Troubleshooting

Front display	Type of fault on the display	Action
F10	Overfilling 1	Clear the drainage pump. See the chapter Care and cleaning. If the problem persists, call the service department.
F11	Water outlet fault	See "Water remains in the dishwasher" in the table "Problem" below. If the problem persists, call the service department.
F12	Water inlet fault	Check that the water tap is on. Check that the outer filter on the inlet hose is not blocked. If the problem persists, call the service department.
F40	Inlet valve leakage	Turn off the water tap and call the service department.
F41	Temp. stop fault 3	Check plugs/fuses. Also check that the drainage hose is fitted in accordance with the installation instructions. If the problem persists, cut the power using the property's main power switch and call the service department.
F42	Thermistor fault 1	Call the service department.
F43	Pressure sensor fault 1	Call the service department.
F47	Pressure sensor fault 2	Call the service department.
F48	Thermistor fault 2	Call the service department.
F49	Temp. stop fault 1	Call the service department.
F50	Temp. stop fault 2	Call the service department.
F51	Temp. stop fault 4	Check plugs/fuses. If the problem persists, cut the power using the property's main power switch and call the service department.
F52	Water level fault	Check that the outer filter on the inlet hose is not blocked. Also check that the drainage hose is fitted in accordance with the installation instructions. If the problem persists, call the service department.
F53	Circulation fault	Check that the filters are not clogged. Restart the dishwasher. If the problem persists, call the service department.
F54	Overfilling 2	Turn off the water tap and call the service department.
F55	Communication fault MCU	(MCU is an abbreviation of "Motor Control Unit"). Call the service department.
F56	Circulation fault	Call the service department.
F57	Version MCU Fault	(MCU is an abbreviation of "Motor Control Unit"). Call the service department.
F58	Communication fault UIC	(UIC is an abbreviation of "User Interface Control"). Call the service department.
F59	Version UIC fault	(UIC is an abbreviation of "User Interface Control"). Call the service department.
F60	Unknown fault	Call the service department.

Press any button to clear the error message.

Problem	Possible causes	Action
The dishes are not clean.	The spray arms do not rotate.	Remove the arms and clean them. Check that the dishes are not blocking the spray arms.
	Spray arm holes or bearings blocked.	Clean the spray arms. See the chapter Care and cleaning.
	Dishwashing program too weak.	Select a more powerful program.
	Incorrect detergent dosage.	Dose according to water hardness. Far too much or far too little detergent results in poorer dishwashing results.
	Old detergent. Detergent is a perishable product.	Avoid large packages.
	Dishes loaded incorrectly.	Do not cover porcelain with large bowls or the like. Avoid placing very tall glasses in the corners of the baskets. Avoid arranging large items, i.e. big plates and pots, in such a way that the water cannot pass from the inside out towards the dishwasher door.
	Glasses and cups have toppled over during the program.	Place dishes to sit steady.
	The filters are not fitted correctly.	Check that the filter handle is locked in the stop position. The handle should point straight out from the dishwasher.
	Drainage pump stop missing.	Check that the coloured stop on the right in the bottom drain is in place. See the chapter Care and cleaning.
Spots or films on the dishes.	The water softener is leaking salt.	Check that the salt compartment lid is properly tightened. Otherwise call the service department.
	Incorrect water softener setting.	See "Water hardness" in section Settings.
	Incorrect rinse aid dosage setting.	See section Before washing for the first time and "Rinse aid" in section Settings.
	Salt compartment empty.	Top up with salt. See the chapter Before washing for the first time.
	Limescale deposits due to water that is too hard (water with high mineral content).	Switch to an acid rinse aid. See section Limescale deposits in chapter Care and cleaning.
	Too high temperature and/or too much detergent can cause etching on crystal. Unfortunately, this cannot be repaired, only prevented.	Wash crystal at a low temperature and with a conservative amount of detergent. Contact the detergent manufacturer.
The dishes have a sticky white/blue film.	Rinse aid dosage setting too high.	Lower the dosage. See section Before washing for the first time and "Rinse aid" in section Settings. If the water is very soft, you may want to dilute the rinse aid 50:50 with water.
Spots on stainless steel or silver.	Some foodstuffs, such as mustard, mayonnaise, lemon, vinegar, salt and dressings, can cause spots on stainless steel if left for too long.	Rinse off these types of foodstuffs if not starting the dishwasher immediately. Use the Rinse program.
	All stainless steel can cause spots on silver if they come into contact during dishwashing. Aluminium can also cause spots on dishes.	Silver and stainless steel items should not come into contact during dishwashing.
Spots left after washing.	Lipstick and tea can be difficult to wash off.	Use a detergent with a bleaching agent.

Problem	Possible causes	Action
Residue from the detergent remains in the dishwasher.	The Function Menu is set incorrectly.	Check that the Spray pressure setting under Automatic dosing system is set correctly.
		Check that the Spray pressure setting under Program A, Program B and Program C is set correctly.
Noises when dishwashing.	The Function Menu is set incorrectly.	Check that the Spray pressure setting under Automatic dosing system is set correctly.
		Check that the Spray pressure setting under Program A, Program B and Program C is set correctly.
Rattling sound when dishwashing.	The dishes are not correctly placed or the spray arms are not rotating.	Check that the dishes are placed securely. Spin the spray arms to make sure they can rotate.
The dishwasher does not start.	The Start/Stop start button has been pressed for too short a time.	Press and hold Start/Stop until "Program started" is shown on the display. This indicates that the dishwasher is ready to start.
	The door is not properly closed.	Check.
	A fuse/circuit breaker has been tripped.	Check.
	The property's main power switch is switched off.	Check.
	The water tap is turned off.	Check.
	Overflow/leaks.	Check.
	A whirring sound (the drainage pump) is heard from the dishwasher and does not stop when the main power switch is turned off.	Shut off the water tap. Switch off the property's main power switch and then call the service department.
1 minute appears in the display.	The program is taking longer than estimated.	None, next time the program is run the corrected time will be displayed.
	Regeneration of the water softener occurs, extending the program duration.	
Water remains in the dishwasher.	The filters are clogged.	Clear the coarse and fine filters.
	The filters are not fitted correctly.	Check that the filter handle is locked in the stop position. The handle should point straight out from the dishwasher.
	Debris in the drainage pump.	Clean the drainage pump. See the chapter Care and cleaning.
	Drainage pump stop missing.	Check that the coloured stop on the right in the bottom drain is in place. See the chapter Care and cleaning.
	Kink in drainage hose.	Check that the hose is free from kinks and sharp bends.
	Blocked drainage hose.	Loosen the drainage hose where it connects to the sink unit's water trap. Check that no debris has fastened. Is the cone-shaped part of the pipe cut to an inner diameter of at least 14 mm?
Bad odour in dishwasher.	Dirt around the seals and in corners.	Clean with washing-up brush and low foaming cleaner.
	Low temperature programs have been selected for a prolonged period.	Run a program with a higher temperature about once a month.

Problem	Possible causes	Action
The dishes are not dry enough.	The dishwasher is not fully loaded.	Fully load the dishwasher.
	Rinse aid needs topping up or dosage is set too low.	Top up or increase the rinse aid dosage. See section Before washing for the first time and "Rinse aid" in section Settings.
		Select a program with a higher temperature in the final rinse.
		Open the door a little once the program has finished.
Cannot close door.	The baskets are not correctly positioned.	Check that the plastic dishwasher baskets are placed within the edges of the basket carriers and that these are in the correct horizontal position.
		Check that the dishes are not preventing the basket carriers with dishwasher baskets from sliding properly into place.
The touch buttons do not react when pressed.	You have pressed the touch buttons too soon after opening the door.	Wait a moment then try again.
	Dirt on the touch buttons.	Clean with a dry or slightly damp cloth.
	The door is not open wide enough.	Open the door to activate the panel.



Technical information

Technical data

Brand:	ASKO
Height:	847-902 mm
Width:	600 mm
Depth:	596 mm
Weight:	67 kg ¹⁾
Water pressure:	0.03–1.0 MPa 0.3–10 kp/cm ² 3–100 N/cm ²
Electrical connection:	See the serial number plate
Rated power:	See the serial number plate
Noise emissions:	51 dB(A) re 1 pW

¹⁾ *Weight can vary due to different specifications.*

Installation

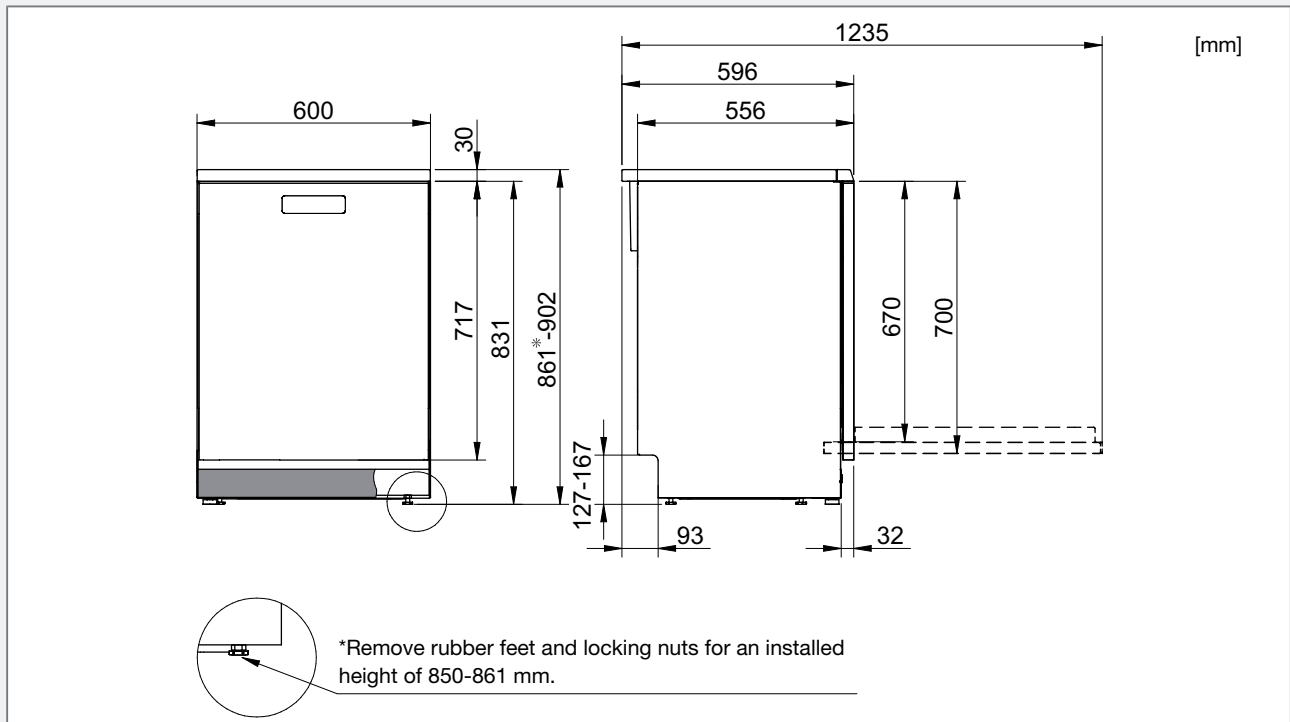

Safety instructions

- Connections to electricity, water and drainage must be performed by a qualified professional.
- Always follow applicable regulations for water, drainage and electricity.
- Take care during installation! Wear protective gloves! There must always be two people!
- Place a drip tray on the floor beneath the dishwasher to prevent damage from any water leaks.
- Before screwing the dishwasher into place, test the dishwasher by running the Rinse program. Check that the dishwasher fills with water and drains. Check also that none of the connections leak.

⚠ WARNING!

Turn off the water supply when installing the dishwasher!

⚠ WARNING!

The property's main power switch must be switched off or power to the socket turned off while work is being carried out!

Transport protection for the door

Do not forget to remove the transport protection for the door when unpacking the dishwasher.

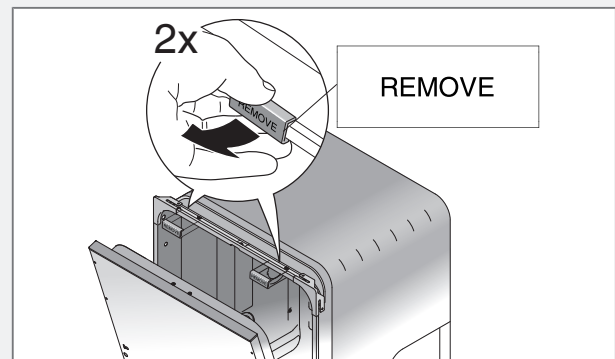

Suggested machine installations

The dishwasher is intended for freestanding installation, but can also be installed under a worktop. Check that there is an air gap of 10 mm between the underside of the worktop and the top edge of the dishwasher, as well as behind the dishwasher when it is being built-in.

A cable and hose hole does not need to be bigger than 38 mm in diameter. Increase the cable and hose hole to 50 mm in diameter if the dishwasher is also to be connected to an automatic dosing system. Make sure that the cable and hose hole's edges are even and will not damage the drainage and inlet hoses or the power cable.

The interior design around the dishwasher should be adapted for commercial use to clear the hot condensed water.

Adjust the height and slide the dishwasher into place

Freestanding

1. Make sure the area on which the dishwasher is to be installed is firm. Adjust the dishwasher's height using the four steel feet so that the dishwasher is level. The dishwasher may lean no more than 5 mm.
2. Lock the steel feet with the lock nuts.

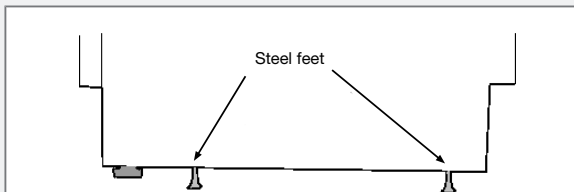

3. Once the steel feet are properly adjusted, tighten the two rubber feet against the floor. The rubber feet now prevent the machine from tipping over.

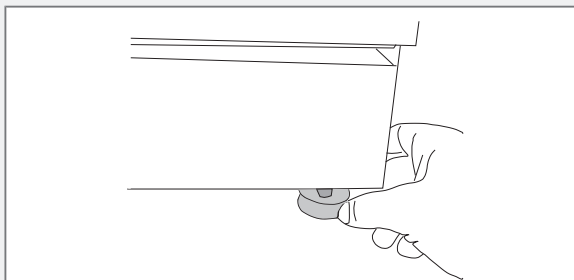

Built-in

1. Start by measuring the height from the floor to the bottom edge of the worktop.
2. Measure the height from the floor to the top edge of the dishwasher.
3. Adjust all feet by turning them clockwise to raise or anticlockwise to lower the dishwasher.

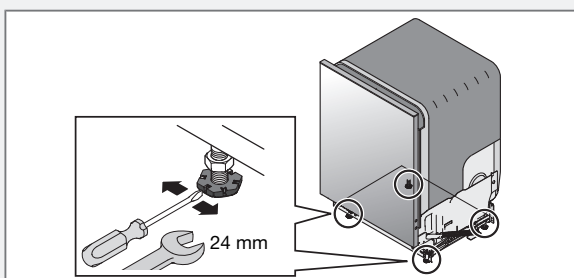

4. Check that there is an air gap of 10 mm between the underside of the worktop and the top edge of the dishwasher, as well as behind the dishwasher.
5. Tighten the lock nuts (lock nut) on the rear feet.
6. Slide the dishwasher into place.
 - Pull through the drainage and supply hoses when the machine is slid into place. Also pull through the hoses and wiring for the automatic dosing system, if one is connected.
 - Check that the hoses have no kinks or sharp bends, and check that there is nothing that can damage the hoses.

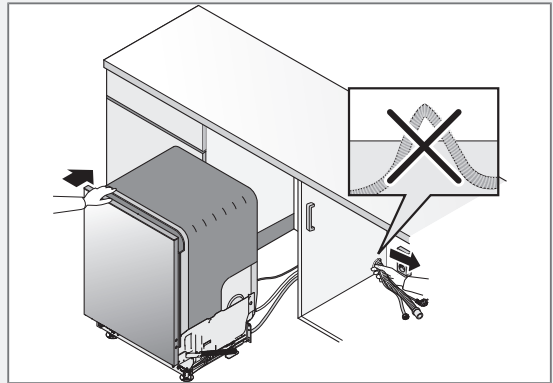

7. Make any final adjustments to the front feet (the dishwasher may lean no more than 5 mm) and tighten the lock nuts.
8. Once the steel feet are properly adjusted, tighten the two rubber feet against the floor. The rubber feet now prevent the machine from tipping over.

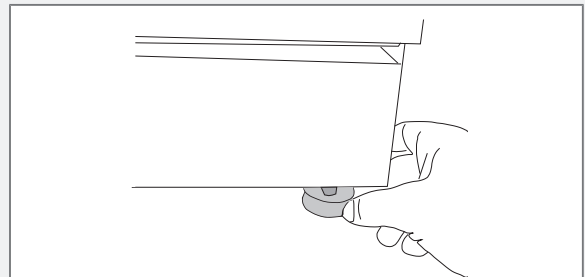

Attach the light shielding film

Mount the light shielding film (enclosed documents) above the touch buttons below the worktop. The purpose of the light shielding film is to get the touch buttons to function optimally, and to protect the worktop from moisture.

NOTE!

The surface on which the light shielding film is affixed must be clean and dry.

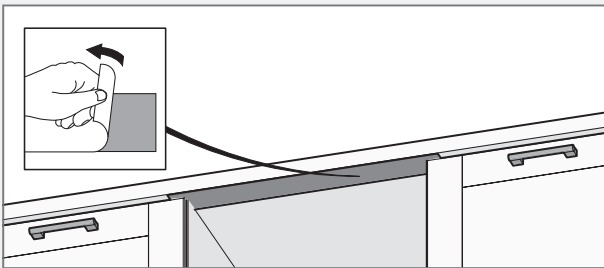

Drainage connection

The dishwasher can pump out up to 20 l waste water per minute, which the drain must be able to receive.

When the drainage hose is routed to a connection nipple on the sink unit's water trap (see illustration 1), please note that the hose must be attached at the same height as the underside of the sink unit, otherwise dishwasher water from the sink may flow back into the dishwasher. The drainage hose is threaded onto the cone-shaped connection pipe on the sink unit's water trap. The cone-shaped pipe must be cut to an internal diameter of at least 14 mm. For other connection alternatives, see illustrations 2 and 3.

The drainage hose may be extended by a maximum of 3 m (the total length of the drainage hose must not exceed 4.5 m). Any joints and connecting pipes must have an internal diameter of at least 14 mm. However, the drainage hose should ideally be replaced with a new hose without joints.

No part of the drainage hose may be more than 950 mm above the bottom of the dishwasher. The hose must not be routed directly to a floor drain or the like. In such cases, the hose can act as a siphon and empty the dishwasher.

The hose must always discharge at least 350 mm above the bottom of the machine.

Ensure that the drainage hose has no kinks.

NOTE!

The hose must be attached at the same height as the underside of the sink.

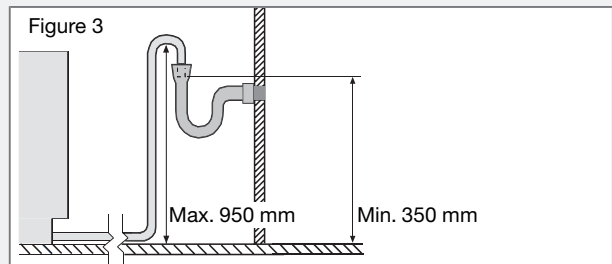
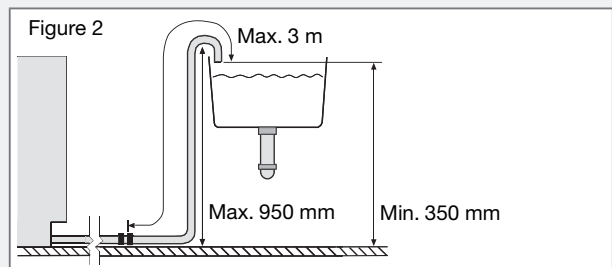
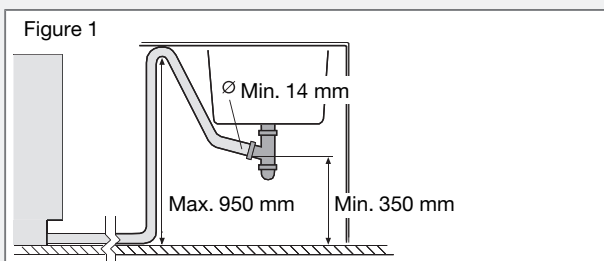

Connection to water supply

The dishwasher can be connected to hot (max. 70 °C) and/or cold water. The dishwasher adjusts automatically to the connected water in order to achieve the best dishwashing result. To achieve optimal short dishwashing time, the dishwasher should be connected to hot water.

The water pressure must be between 0,03–1,0 MPa. To achieve optimal short dishwashing time, the water pressure must be at least 0,3 MPa.

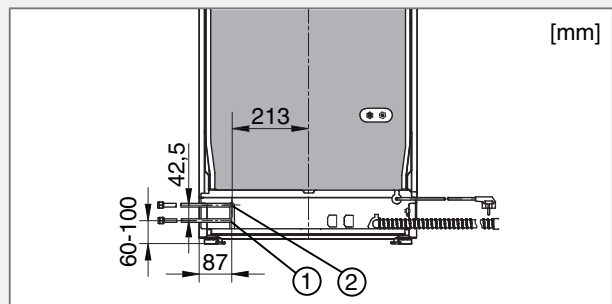

1. Connection for hot or cold water (Water connection: Single).
2. Connection for cold water when installing both hot and cold water (Water connection: Mix). The connection must be blocked with a plug when it is not being used.

Installation must be carried out by qualified professionals.

The supply pipe must be fitted with a stopcock. The stopcock must be easily accessible, so that the water can be shut off if the dishwasher has to be moved.

Use only the supply hoses supplied with the dishwasher. Do not re-use old hoses or other loose supply hoses.

Once the installation is complete, the stopcock should be opened to allow the pressure to settle for a while and to check that all connections are tight.

Electrical connection

Information about the electrical connection can be found on the serial number plate. This specification must match the electricity supply.

Electrical connection during installation must be carried out by the manufacturer's service agent or someone with similar professional qualifications.

The dishwasher must be connected to residual current devices as per the relevant safety regulations.

The property's main power switch must be multipole and placed outside of the installation area to be easily accessible after installing the dishwasher. Multiway sockets, extension leads or timers must not be used.

⚠ Potential equalisation must be carried out if required when the machine is installed. There is a potential equaliser on the back of the machine that must be connected using a lock washer or a ring terminal.

The manufacturer recommends that the dishwasher is connected as per the existing design upon delivery. In the event of any change of electrical cables, terminal sleeves corresponding to those supplied with the machine should be used. Refer to the wiring diagram supplied with the machine. In the event of any change of electrical cables to 1-phase, H05V5V2-F 3x1.0 mm² must be used.

Change of electrical cables as well as repairs and maintenance relating to safety or performance must be carried out by the manufacturer's service agent or someone with similar professional qualifications.

NOTE!

The manufacturer is not responsible for damages caused by shortcomings in or incorrect electrical installation.

Connection to automatic dosing system

The dishwasher can be connected to an automatic dosing system for commercial detergent and rinse aid which simplifies daily use and reduces the risk of overdosing.

Connection to an automatic dosing system must be carried out by the system supplier or someone with similar professional qualifications.

Connect the dosing system to the back of the dishwasher. Always reinstall protective caps and plugs if the dosing system is disconnected.

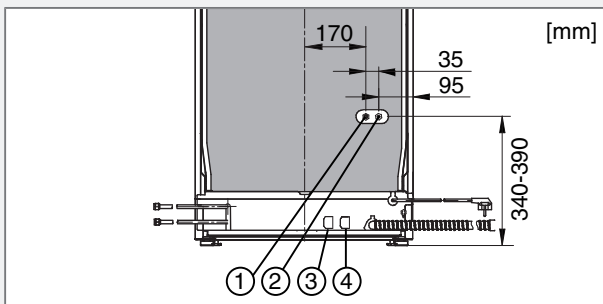

1. Connection for detergent (hose diameter 6 mm). Remove the plug and connect the hose.
2. Connection for rinse aid (hose diameter 4 mm). Remove the plug and connect the hose.
3. Connection to cable for detergent pulse (230 V).
4. Connection to cable for rinse aid pulse (230 V).

In section Settings on page 9 the process for activating an automatic dosing system and venting the system is described.

! WARNING!

Risk of contact with high voltage! The supplied protective caps must be fitted on the dishwasher's cables for the automatic dosing system during installation and is the dosing system is disconnected. The protective cap prevents contact with high voltage and stops water and dirt getting into the wiring.

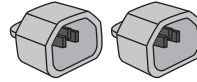

! WARNING!

Note that there are risks involved in handling commercial detergent and rinse aid. Protective gloves and goggles must be used when handling these products.

Follow the supplier's safety regulations concerning the handling and storage of detergent and rinse aid.

Diluting detergent and rinse aid

To correctly dilute detergent and rinse aid, calculate the dose based on the amount of water in the machine.

Amount of water in the machine:

- 3.5 liter for detergent dose
- 3.5 liter for rinse aid dose

Service

Read chapter Troubleshooting before contacting the service department. Note down the details on the serial number plate positioned on the right inside the dishwasher. Note down the item number (1) and serial number (2).



Program chart

Program	Prewash temperature ¹⁾	Main wash temperature	Rinse temperature	Final rinse temperature	Consumption values ²⁾						
					Cold water ³⁾			Hot water ⁴⁾			Water consumption (liter)
					Dishwashing time ⁵⁾ (approx. hrs:min)	Energy (approx. kWh)	Dishwashing time ⁵⁾ (approx. hrs:min)	Energy (approx. kWh)	Energy (approx. kWh)		
Quick Wash		60 °C		82 °C	0:10	1.2	0:05	0.8		8	
Quick Wash Universal		60 °C	70 °C	82 °C	0:20	1.3	0:15	0.8		12	
Universal		60 °C	70 °C	85 °C	0:20	1.4	0:15	0.9		12	
Universal Plus	60 °C	60 °C	70 °C	85 °C	0:25	1.5	0:20	0.9		15	
Intensive	40 °C	65 °C	65 °C / 70 °C	85 °C	1:00	2.0	1:00	1.2		18	
Wine Glasses		55 °C	50 °C	50 °C	0:15	0.8	0:15	0.3		12	
Beer Glasses		55 °C	--- °C	--- °C	0:15	0.5	0:10	0.3		12	
Rinse		--- °C			0:02	0.01	0:02	0.01		5	
Drain					0:02	0.01	0:02	0.01		0	

1) An automatic dosing system for detergent must be connected for the program to function optimally in both prewash and main wash (otherwise the program's prewash will be deactivated).

2) Consumption values vary depending on the temperature of the incoming water, room temperature, load size, selected additional functions and more.

3) Connection to cold water, approx. 15 °C.

4) Connection to hot water, approx. 65 °C.

5) The dishwashing time for short programs may be extended by up to 10 minutes when the dishwasher's water softener is regenerated.

Quick guide ASKO DWCFS5936

1.

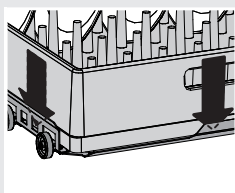

Place the dishwasher baskets on the basket carriers

Check that the plastic dishwasher baskets are placed within the edges of the basket carriers.

2.

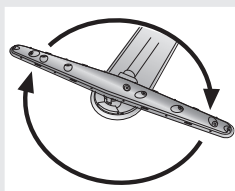

Check that the spray arms can rotate freely

3.



Check/add detergent and rinse aid

Check/add detergent and rinse aid to achieve good washing and drying results.

4.



Check/add salt

Top up salt to achieve good washing and drying results.

✱ Refill salt indicator.

5.

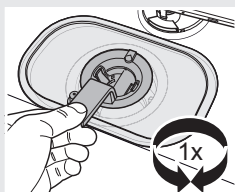

Check/clean the filter

Empty the coarse filter and clean the fine filter when necessary.

Lock the filter in place by turning the handle clockwise to the stop position. The handle should point straight out from the dishwasher.

6.

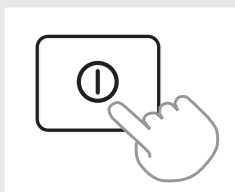

>

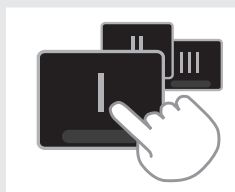

>



ASKO

