

ASKO



Instructions for use

Coffee machine

CM8457S
CM8457A

CONTENTS

<i>Introduction</i>		
	Pictograms used	4
<i>Description</i>		5
<i>Control panel</i>		6
<i>Safety instructions</i>		
	What you should pay attention to	7
<i>Use</i>		
	Preparation	10
	Operation	11
<i>Settings</i>		
	Using menu options	20
<i>Maintenance</i>		
	Cleaning	28
<i>Messages</i>		
	Faults table	33
<i>Troubleshooting</i>		35
<i>Installation instructions</i>		
	What you should pay attention to	38
	Building in	39
<i>Appendices</i>		
	Disposal of appliance and packaging	41
	Technical data	41

INTRODUCTION

This coffee machine will make delicious cups of coffee, espresso and cappuccino. You can customise the settings of the machine to suit your personal preferences and tastes.

Coffee has been used in the factory to test the appliance and it is therefore completely normal that there are traces of coffee in the mill. This appliance is however guaranteed to be new.



First read the user instructions carefully and completely before starting to use the appliance, and keep them carefully for future reference.

Pictograms used



Important information



Danger! Electrical appliance



Danger of burns



Tip

The parts which could come into contact with coffee or milk conform to the provisions of the EEC directive 1935/2004 relating to materials suitable for contact with foodstuffs.

This appliance is marked according to the European directive 2004/108/EC on Waste Electrical and Electronic Equipment (WEEE).

DESCRIPTION

- A. Main switch / Aa. On/Stand-by button
- B. Handles
- C. Nozzle
- D. Water tank (removable)
- E. Cup tray
- F. Drip tray grill (removable)
- G. Service door
- H. Height adjustable coffee dispenser
- I. Control panel
- J. Coffee bean holder cover
- K. Ground coffee chute cover
- L. Brewing unit
- M. Power cable
- N. Milk container:
 - N1. Cover (removable)
 - N2. Slider CAFFE LATTE/CAPPUCCINO (removable)
 - N3. CLEAN button
 - N4. Milk dispenser pipe (removable)
 - N5. Suction pipe (removable)
- O. Hot water spout (removable)
- P. Measuring spoon for preground coffee
- Q. Waste coffee container (can be taken out)
- R. Knob for setting the grind level
- S. Coffee bean container
- T. Place for the measuring spoon
- U. Filling chute for preground coffee
- V. Coffee guide
- W. Place for accessories (left and right)
- X. IEC Connector

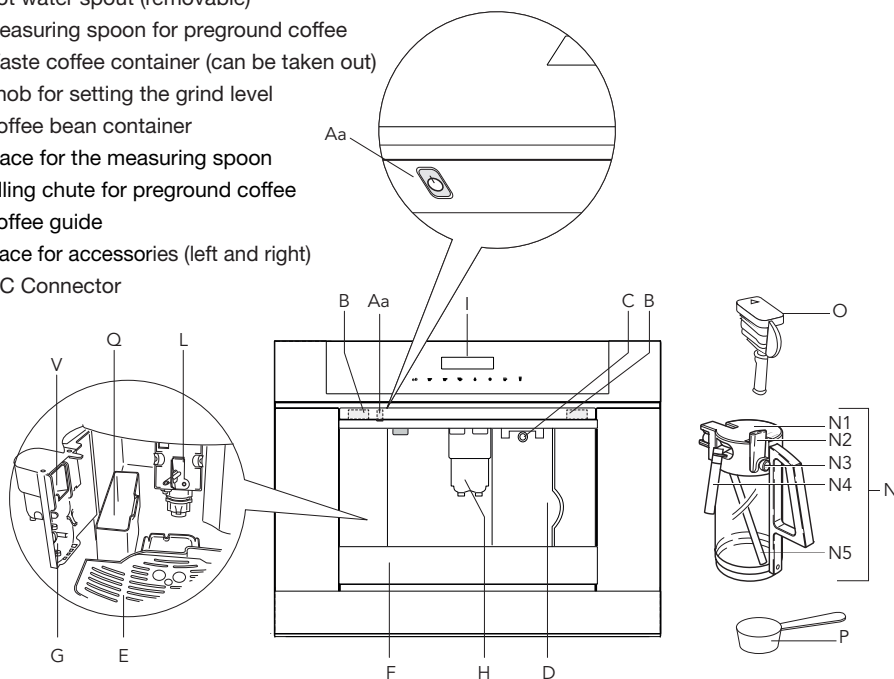
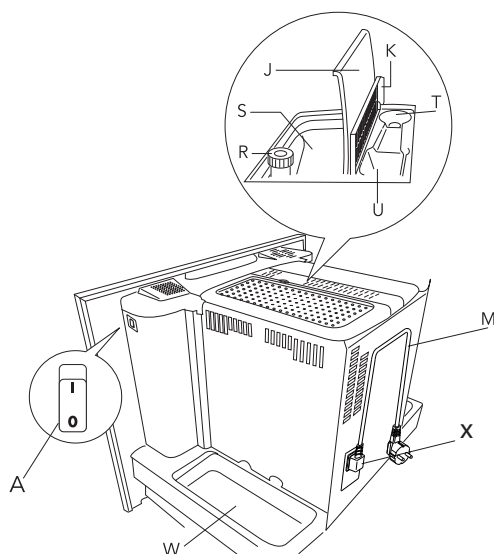

CONTROL PANEL

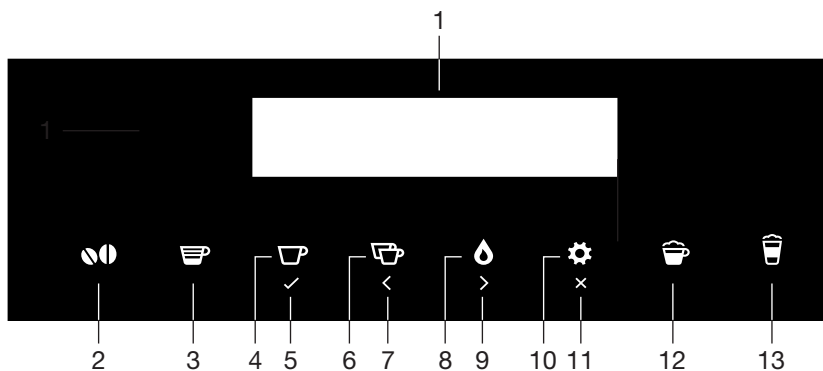

1. Display
2. Touch key 'Coffee strength' to select strength or preground
3. Touch key to select the type/quantity of coffee:
 - ESPRESSO
 - MEDIUM CUP
 - LARGE CUP
4. Touch key 'One cup of coffee'
5. Touch key 'OK' to confirm the selected function
6. Touch key 'Two cups of coffee'
7. Touch key 'SCROLL' to scroll backwards through the menu and display
8. Touch key 'Hot water'
9. Touch key 'SCROLL' to scroll forwards through the menu and display
10. Touch key 'MENU' to activate or deactivate menu
11. Touch key 'RETURN' to exit the selected mode
12. Touch key 'Cappuccino'
13. Touch key 'Latte Macchiato'

What you should pay attention to



- **WARNING:** The appliance and its accessible parts become hot during use. Care should be taken to avoid touching heating elements.



- The appliance is not intended for use by persons (including children) with reduced physical, sensory or mental capabilities, or lack of experience and knowledge, unless they have been given supervision or instruction concerning use of the appliance by a person responsible for their safety.

- Children should be supervised to ensure that they do not play with the appliance.

- Cleaning and user maintenance shall not be made by children without supervision.

- Never immerse the appliance in water.

- This is an household appliance only. It is not intended to be used in: staff kitchen areas in shops, offices and other working environments; farm houses; by clients in hotels, motels and other residential type environments; bed and breakfast type environments.



- If the plug or power cable is damaged, it must be replaced by customer services only to avoid all risk.



- This appliance is intended for domestic use only (around 3000 cups a year). Any other use is considered improper and in that case no guarantee will be given.

- This appliance is designed to “make espresso coffee” and “heat drinks”. Use it with care to avoid scalds from the water and steam jets or through incorrect use.

- Do not lean or hang on the machine when it has come out of the cabinet and do not place heavy or unstable objects on the machine.

SAFETY INSTRUCTIONS



- This appliance can be installed over a built-in oven if the latter is fitted with a cooling fan at the rear.



- The manufacturer is not liable for damage caused by improper, incorrect or unreasonable use of the appliance.
- When using the appliance, do not touch the hot surfaces. Use the knobs or handles.
- In case of failures, make sure the appliance is not connected to the mains power supply. Turn the main power switch on the right side (behind the front panel) to 0. Refer to our service department for repairs.
- Only ask for original spare parts to be used. Failure to respect the above could reduce the safety of the appliance.
- Do not put objects containing liquids, inflammable or corrosive materials on the machine.
- Use the accessories holder to contain coffee accessories (for example coffee beans).
- Never touch the appliance with damp hands.
- Unplug directly from the plug only.
- Never pull the power cable as you could damage it.
- To disconnect the appliance completely, place the main switch on the side of the appliance in the 0 (off) position.



For european markets only:



- This appliance can be used by children aged from 8 years and above if they have been given supervision or instruction concerning use of the appliance in a safe way and if they understand the hazard involved. Cleaning and user maintenance shall not be made by children unless they are older than 8 and supervised. Keep the appliance and its cord out of the reach of children aged less than 8 years.

SAFETY INSTRUCTIONS



- Appliances can be used by persons with reduced physical, sensory or mental capabilities or lack of experience and knowledge if they have been given supervision or instruction concerning use of the appliance in a safe way and understand the hazards involved.
- Children shall not play with the appliance.
- When not in use and before cleaning, always unplug the appliance.
- Surfaces marked with this symbol become hot during use (the symbol is present in certain models only).

Preparation

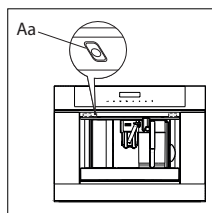

Connect the appliance to the mains supply (see chapter 'Installation') and switch on the appliance with the main switch (see 'A' page 5). The first time you switch on the appliance with the main switch and every time that it is plugged in, the appliance executes a "SELF-DIAGNOSIS" action. Then the appliance switches off.

To turn it on, press the On/stand by button (Aa) on the left side underneath the control panel.

- Coffee has been used to factory test the appliance and it is therefore completely normal for there to be traces of coffee in the mill.
- Customise water hardness as soon as possible following the instructions in the "Setting water hardness" section.

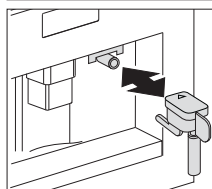
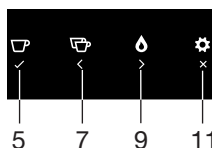

1. Start the appliance with the on/stand by button (see 'Aa'). The appliance displays 'FILL TANK' in different languages.
 - Extract the water tank, rinse and fill with fresh water without exceeding the MAX line.
 - Replace and push as far as it will go.
2. Set the required language.
 - When the message "PRESS OK TO SET TO ENGLISH" is displayed, press and hold the touch key 'Ok' (5) for about 5 sec. If you set the wrong language, follow the instructions in the "Setting the language" section. If your language is not available, select one from those displayed. The instructions refer to the English version. Then follow the instructions displayed.
3. Place a cup under the hot water spout. If the hot water spout is not inserted, the appliance displays "INSERT WATER SPOUT".
4. Place the hot water spout if it is not there.
The appliance displays: "HOT WATER PRESS OK".
5. Press the touch key 'OK' (5) and after a few seconds a little water comes out of the spout.
6. The machine now displays "TURNING OFF PLEASE WAIT" and goes off.
7. Extract the appliance by pulling it out using the handles.

USE

- Open the lid and fill the container with coffee beans, then close the lid and push the appliance in. The coffee maker is now ready for normal use.



Only fill the water tank with cold water. Never use other liquids such as mineral water or milk.
To prevent malfunctions, never fill with ground coffee, frozen or caramelised coffee beans or anything else that could damage the appliance.



- When using the appliance for the first time, you need to make 4-5 cups of coffee and 4-5 cappuccinos before the appliance gives satisfactory results.
- Each time you turn the coffee maker on by the main switch (A), it performs a “SELF-DIAGNOSIS” cycle and then goes off. To turn it on again, press the On/stand by button (Aa).

Operation



Preparing coffee (using coffeebeans)

- The appliance is preset to make coffee with a normal taste. You can also choose coffee with an extra mild, mild, normal, strong or extra-strong taste. There is also a pre-ground coffee option.
- To choose the required taste, press more times the touch key ‘Coffee strength’ (2). The required coffee taste is displayed.

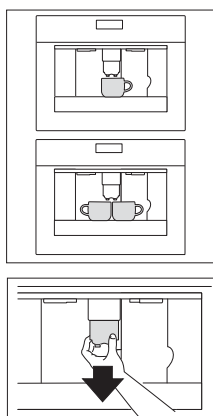

- Place 1 cup under the spouts to make 1 coffee or 2 cups for 2 coffees.
- Lower the spouts as near as possible to the cup for a creamier coffee.
- Press the ‘type of coffee’ touch key (3) to select the type of coffee:
 - ESPRESSO
 - MEDIUM CUP
 - LARGE CUP
- Press the ‘one cup of coffee deliver’ touch key (4) if you want to make one coffee and the ‘two cup of coffee deliver’ touch key (6) if you want to make two coffees.
 - The appliance now grinds the beans and starts delivering the coffee into the cup.

USE

- Once the set amount of coffee has been delivered, the machine stops delivery automatically and expels the exhausted waste coffee into the waste coffee container. After a few seconds, the appliance is ready for use again.

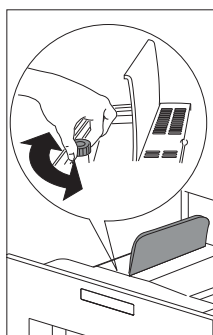

Tips

- To turn the appliance off, press the 'On-off' button (Aa / see page 5). Before going off, the appliance performs an automatic rinse cycle. Take care to avoid scalds.
- If the coffee only comes out in drips or not at all, the knob for setting the grind level must be turned by one position clockwise (see "Setting the grind level"). Turn one click at a time until the coffee is delivered satisfactorily.
- If the coffee comes out too fast and the cream does not meet your taste, turn the knob by one position anti-clockwise). Make sure that you do not turn the knob for setting the grind level too far, as coffee may come out in drips when dispensing 2 cups.
- You can stop the coffee from dispensing by pressing the 'One cup of coffee deliver' touch key (4) or 'Two cup of coffee deliver' touch key (6) again.
- After the coffee has finished dispensing (the progress bar reaches 100%), you can change the amount of coffee (see 'Changing the quantity of coffee').
- When the display shows the message "FILL TANK!", you must fill the tank, otherwise the appliance cannot make any coffee. It is normal that there is some water left in the water tank when the message is displayed.

Tips to make hotter coffee

- After 3 minutes since you last made coffee, you can preheat the brewing unit by using the menu setting "RINSING (see 'Rinsing')". Run off the water into the underlying drip tray or alternatively use this water to fill (and then empty) the cup to be used for the coffee.
- Do not use cups that are too thick, as they will absorb too much heat.

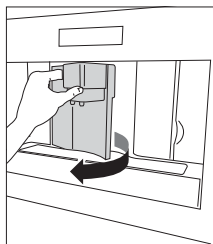

Empty the waste coffee container

- The appliance counts the number of coffees made. Every 14 single coffees (or 7 doubles) the appliance displays “EMPTY WASTE COFFEE CONTAINER”. This means that the waste coffee container is full and must be emptied and cleaned.
- As long as the waste coffee container is not cleaned, this message remains in place and the coffee machine cannot make any coffee.
- To clean, open the service door at the front by pulling the coffee spout, remove the drip tray, empty it and clean it.

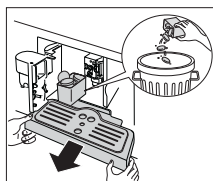

Important!

Always completely extract the drip tray, to avoid that it falls when removing the grounds container. Empty the grounds container and clean thoroughly, making sure all residues deposited on the bottom are removed.



Every time you pull the drip tray out, the waste coffee container must also be emptied, even if it is not completely full. If this process is not carried out, the waste coffee container may overflow when coffee is made and the machine may get blocked.

Never remove the water tank when the appliance is dispensing coffee. Otherwise, the appliance will not be able to make the coffee. If the appliance malfunctions, do not contact the service centre straight away, but first look at the troubleshooting guide. If this does not help, contact the customer service.

Changing the quantity of coffee

The appliance is factory preset to automatically deliver the following quantities of coffee:

- ESPRESSO
- MEDIUM CUP
- LARGE CUP

USE



To change these quantities, proceed as follows:

1. Place a cup under the spouts.
2. Press the 'type of coffee' touch key (3) to select the type of coffee.
3. Keep the 'one cup of coffee deliver' touch key (4) pressed until the message "PROGRAM QUANTITY" is displayed and coffee delivery begins.
4. As soon as the coffee in the cup reaches the required level, press the same icon again. The quantity set has now been programmed.

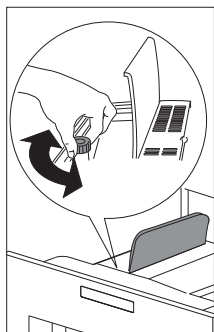

Setting the grind level

If coffee is dispensed too quickly or too slowly (in drips), you can change the grind level.

Only change the grind level during the milling process. Otherwise, the coffee machine may be damaged.

1. Extract the appliance by pulling it out using the handles.
2. Press the 'one cup of coffee deliver' touch key (4).
3. Open the coffee bean holder cover.
4. Turn the knob for setting the grind level anti-clockwise to obtain finer ground coffee, slower delivery and a creamier appearance. Turn the knob clockwise for coarser ground coffee and faster delivery (not a drop at a time).

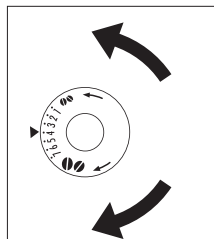

The adjustment will be evident after at least 2 cups of coffee are made.

USE

Preparing espresso coffee using ground coffee

1. Press the 'Coffee strength' touch key (2) several times to select "PRE-GROUND".
2. Extract the machine by pulling it outwards using the handles.
3. Lift the central lid, place one measure of preground coffee in the funnel, push the appliance back and proceed as described in the section "Making coffee using coffee beans". You can make just one coffee at a time by pressing the 'One cup deliver' touch key (4).
4. After using the machine with pre-ground coffee, to go back to making coffee using beans, deactivate the pre-ground coffee function by pressing the 'Coffee strength' touch key (2).

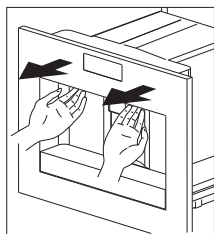

Notes

- Never introduce pre-ground coffee when the machine is off or it could spread through the inside of the appliance.
- Never add more than 1 measure, otherwise the appliance will not make the coffee.
- Use the measure provided only.
- Introduce only pre-ground coffee for espresso coffee machines into the funnel.
- If more than one measure of pre-ground coffee is used and the funnel clogs, push the coffee down with a knife. Then remove and clean the brewing unit and machine as described in the "Cleaning the brewing unit" section.

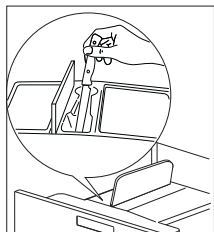
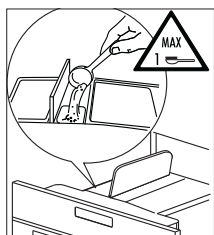

Preparing hot water

Hot water can be used to warm up cups and to make hot drinks, such as tea or packet soups.

Warning! Only activate the hot water spout when there is a receptacle underneath it. Escaping hot water can lead to scalds!

1. Put the hot water spout in place.
2. Place a container underneath the hot water spout.

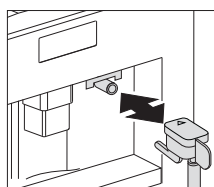

USE



3. Press the 'Hot water' touch key (8). Hot water is dispensed; the display shows "HOT WATER". Once the programmed amount of hot water is dispensed, dispensing stops automatically. For a few seconds the display shows "PREPARATION RUNNING PLEASE WAIT". After that the appliance is ready to make coffee again and the last selected coffee setting appears on the display.

Changing the quantity of hot water

The machine is set by default to automatically delivery 150 ml of hot water. To change these quantities, proceed as follows:

1. Place a container underneath the water spout.
2. Keep the 'Hot water' touch key (8) pressed until the message "PROGRAM QUANTITY" is displayed and hot water delivery begins.
3. As soon as the hot water in the cup reaches the required level, press the same icon again. The quantity set has now been programmed.

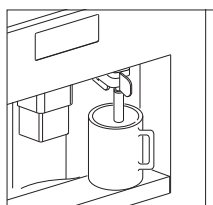

Making cappuccino

This feature allows you to make cappuccino. To do this, use the special milk container. Rinse the milk container under the tap when you use it for the first time.

1. Select the taste of the coffee you want to use to make the cappuccino by pressing the 'Coffee strength' touch key (2).
2. Remove the lid of the milk container.
3. Fill the container with about 100 grams of milk for each cappuccino to be prepared.
 - ▷ Never exceed the MAX level (corresponding to about 750 ml) marked on the container.
 - ▷ You should ideally use skimmed or semi skimmed milk at refrigerator temperature (about 5°C).
 - ▷ Make sure the intake tube is correctly inserted in the rubber washer.
4. Then replace the milk container lid.
 - ▷ The quantity of froth can be adjusted by moving the regulator to 'CAPPUCCINO' or 'CAFFE LATTE':
 - ▷ CAFFE LATTE for a denser froth.
 - ▷ CAPPUCCINO for a less dense froth.

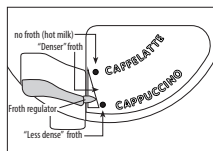
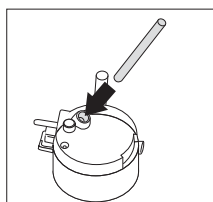
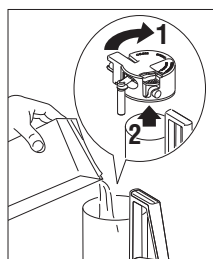

USE

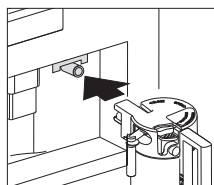
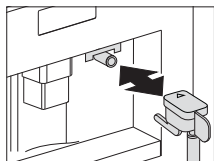

12 13

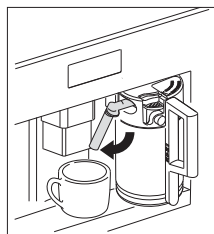

5. Remove the hot water spout and attach the milk container to the nozzle.
6. Position the milk spout (N4) and then place a sufficiently large cup under the coffee and milk spouts.
7. Press the 'Cappuccino deliver' touch key (12). "CAPPUCCINO" is displayed and after a few seconds, frothed milk flows out of the milk spout into the cup below (delivery stops automatically).
8. Next the appliance delivers coffee.
9. The cappuccino is now ready. Sweeten to taste and, if desired, sprinkle the froth with a little cocoa powder.

Making Latte Macchiato

Prepare the appliance as described in 'Making cappuccino'.

- At step 4: position the froth regulator (N2) between CAPPUCCINO and CAFFE LATTE printed on the milk container lid.
- At step 7: press the touch key 'Latte Macchiato' (13).

Frothing milk

1. First, prepare the appliance as described in 'Making cappuccino', step 2, 3, 4, 5 and 6.
2. Press the touch key 'Cappuccino' (12) or 'Latte Macchiato' (13) twice (within two seconds). The quality of frothed milk delivered is equal to that of the selected drink (cappuccino or latte macchiato).

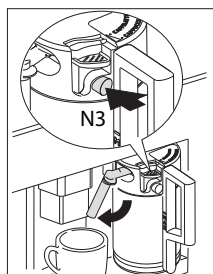
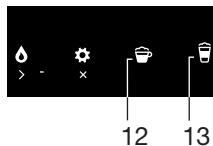

Notes

- While making cappuccino or latte macchiato, the flow of frothed milk or coffee can be interrupted by pressing the ‘Cappuccino deliver’ touch key (12) or the ‘Latte Macchiato’ touch key (13).
- If the milk in the container finishes while delivering frothed milk, remove the container and add milk. Then re-attach it and press the ‘Cappuccino deliver’ touch key (12) or the ‘Latte Macchiato’ touch key (13) to request cappuccino again.
- To ensure the complete cleanliness and hygiene of the milk frother, always clean the circuits in the milk container lid after making cappuccino. “PRESS CLEAN!” flashes on the display.
 - ▷ Place a recipient under the milk spout.
 - ▷ Press the CLEAN button on the lid (N3) and hold down for at least 5 seconds to start the cleaning function. The appliance displays the message “CLEANING” above a progressive bar. You should not release the CLEAN button until the bar is complete indicating that cleaning is concluded. When the CLEAN button is released, the function stops. After cleaning, remove the milk container and place in the refrigerator. The milk should not be left out of the refrigerator for more than 15 minutes.
- To change the quantity of coffee or frothed milk the appliance delivers automatically into the cup, proceed as described in the section “Changing the quantity of coffee and milk for cappuccino or latte macchiato”.

Changing the quantity of milk and coffee for Cappuccino or Latte Macchiato

The appliance is set by default to automatically deliver a standard cappuccino or latte macchiato. To change these quantities, proceed as follows:

1. Fill the container with milk up to the maximum level.
2. Hold the ‘Cappuccino deliver’ touch key (12) until the message “MILK FOR CAPPUCCINO PROGRAM QUANTITY” is displayed or hold the ‘Latte Macchiato’ (13) touch key until the message “MILK FOR MACCHIATO PROGRAM QUANTITY” is displayed.
3. Release the touch key. The appliance starts delivering milk.
4. Once the required quantity of milk has been delivered into the cup, press the ‘Cappuccino deliver’ touch key (12) or ‘Latte Macchiato’ (13) touch key again.

After a few seconds, the appliance starts delivering coffee into the cup and the message “COFFEE FOR CAPPUCC. PROGRAM QUANTITY” or “COFFEE FOR MACCHIATO PROGRAM QUANTITY” is displayed.

- Once the required quantity of coffee has been delivered into the cup, press the ‘Cappuccino deliver’ touch key (12) or ‘Latte Macchiato’ (13) touch key again. Coffee delivery stops.

The machine is now reprogrammed with the new milk and coffee quantities.

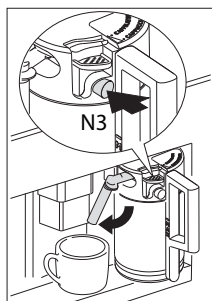

Cleaning the spouts

Clean the spouts on the milk container every time after heating milk or making cappuccino. Otherwise, remains of milk may set hard.

- Place a container under the milk dispenser pipe and press on the CLEAN button (N3) on the milk container for at least 5 seconds. The display shows “CLEANING”!



Warning! Risk of scalding from steam and hot water escaping from the milk dispenser pipe.

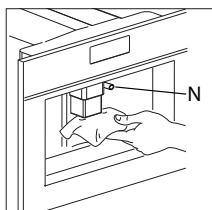

- Remove the milk container and clean the spouts on the appliance with a damp cloth.

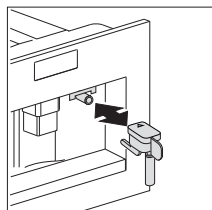

- Put the hot water spout back in.



After you finished cleaning, remove the milk container and place it in the fridge, as the milk should not stay out of the fridge for longer than 15 minutes. See “Cleaning the spouts and the milk container” for information on cleaning the milk container.

SETTINGS

Using menu options

You can change the following menu options and functions:

- Rinsing
- Set language
- Energy saving (enable or disable energy saving)
- Set time (daytime)
- Auto start (auto switch on)
- Auto off (auto turn off)
- Set temperature (of the water to make coffee)
- Water hardness
- Contrast (display)
- Buzzer
- Statistics (from the appliance)
- Default values (reset)
- Descaling



11

To go back to the coffee mode, press the 'Return' touch key (11).

Rinsing

If 2/3 minutes have passed, since you last made coffee, you should first rinse the system to preheat the brewing unit. Select the rinsing function from the appropriate menu. Let the water run into the drip tray underneath. You can also use this water to warm up the cup that you are using for the coffee. In this case simply let the hot water run into the cup (and then empty it).



5 7 9 10

1. Press the touch key 'MENU' (10) to enter the menu.
2. Press the 'Scroll' touch keys (7 and 9) until "RINSING" is displayed.
3. Press the touch key 'OK' (5) to confirm. 'RINSING PRESS OK' is displayed. Press the touch key 'OK' (5) again to confirm.
4. The appliance performs an automatic rinse cycle (a little hot water runs out of the spouts and is collected in the drip tray beneath).

SETTINGS



Setting the language

You can choose between several languages.

A different language can be selected as follows:

1. Press the touch key 'MENU' (10) and press the scroll touch keys (7 and 9) until the menu option "SET LANGUAGE" appears. Confirm the menu option with the touch key 'OK' (5).
2. The language set appears on the display. Press the scroll touch keys (7 and 9) until the desired language appears. When the desired language is displayed, confirm with the touch key 'OK' (5).

Energy saving

Use this function to enable or disable Energy saving. When enabled, the function reduces energy consumption in compliance with European regulations. To enable or disable the function, proceed as follows:

1. Press the touch key 'MENU' (10) and press the scroll touch keys (7 and 9) until the menu option "ENERGY SAVING" appears.
2. Confirm the menu option with the touch key 'OK' (5).
3. "DISABLE?" is displayed (or "ENABLE?" if the function has already been disabled). Confirm with the touch key 'OK' (5).

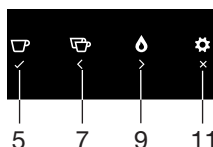

Set time

To adjust the time on the display, proceed as follows:

1. Press the touch key 'MENU' (10) and use the scroll touch keys (7 and 9) until "SET TIME" is displayed. Press the touch key 'OK' (5).
The hours flash on the display.
2. Use the scroll touch keys (7 and 9) to set the hour, then press the touch key 'OK' (5) to confirm.
The minutes flash on the display.
3. Use the scroll touch keys (7 and 9) to set the minutes. Then press the touch key 'OK' (5) to confirm.
4. Press the touch key 'RETURN' (11) to exit the menu.

Auto start

You can set the auto start time in order to have the appliance ready at a certain time (for example in the morning) so you can make coffee immediately. **Caution!** To enable this function, the time must be set correctly.

1. Press the touch key 'MENU' (10) to enter the menu and then the scroll touch keys (7 and 9) until "AUTO START" is displayed.

SETTINGS



2. Press the touch key 'OK' (5). "ENABLE?" is displayed.
3. Press the touch key 'OK' (5). The hours flash on the display.
4. Use the scroll touch keys (7 and 9) to set the hour.
5. Press the touch key 'OK' (5) to confirm. The minutes flash on the display.
6. Use the scroll touch keys (7 and 9) to set the minutes.
7. Press the touch key 'OK' (5) to confirm. "ENABLED" appears under "AUTO START".
8. Press the touch key 'RETURN' (11) to exit the menu.

Disable auto start

1. Press the touch key 'MENU' (10) to enter the menu and then the scroll touch keys (7 and 9) until "AUTO START" is displayed.
2. Press the touch key 'OK' (5). "DISABLE?" is displayed.
3. Press the touch key 'OK' (5). "DISABLED" is displayed.
4. Press the touch key 'RETURN' (11) to exit the menu.

Auto off (Standby)

The appliance is set by default to go off if not used for 30 minutes.

The time can be changed so that the appliance switches off after 15 or 30 minutes, or after 1, 2 or 3 hours.

To re-programme Auto off, proceed as follows:

1. Press the touch key 'MENU' (10) and press the scroll touch keys (7 and 9) until the menu option "AUTO OFF" appears. Confirm the menu option with the touch key 'OK' (5).
2. Select another auto off time with the scroll touch keys (7 and 9). When the desired auto off time is displayed, confirm it with the touch key 'OK' (5).
3. Press the touch key 'RETURN' (11) to exit the menu.



Setting the coffee temperature

There are four temperature levels.

The coffee temperature levels are defined as follows:

- ▷ ●○○○ = low
- ▷ ●●●● = high

SETTINGS

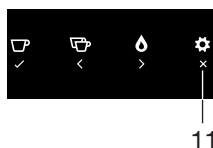
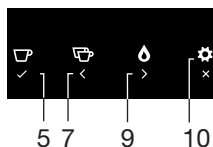

The factory setting can be changed as follows:

1. Press the touch key 'MENU' (10) and press the scroll touch keys (7 and 9) until the menu option "SET TEMPERATURE" appears.
2. Confirm the menu option with the touch key 'OK' (5).
The display shows the current setting.
3. Select another temperature with the scroll touch keys (7 and 9).
When the desired temperature is displayed, confirm it with the touch key 'OK' (5).
4. Press the touch key 'RETURN' (11) to exit the menu.

Water hardness

A "DESCALE!" message is displayed after the appliance has been operated for a factory set period of time, calculated on the basis of the maximum quantity of lime scale which may be contained in the water used. If necessary, this period of operation can be extended, making descaling less frequent, by programming the appliance based on the actual lime content in the water used. Proceed as follows:

1. Remove the "Total Hardness Test" strip (in front of your manual) and dip it fully in the water for a few seconds.
2. Remove it and wait 30 seconds until its colour changes and a number of red dots are formed. For example, if there are 3 red dots on the test strip, you must set the water hardness level to 3.
 - ▷ ●○○○ = water hardness 1
 - ▷ ●●○○ = water hardness 2
 - ▷ ●●●○ = water hardness 3
 - ▷ ●●●● = water hardness 4



If you no longer have a water hardness test, you can find the data in the table below.

3. Press the touch key 'MENU' (10) and press the scroll touch keys (7 and 9) until the menu option "WATER HARDNESS" appears.
Confirm the menu option with the touch key 'OK' (5).
4. The display shows the current setting.

SETTINGS

5. Press the scroll touch keys (7 and 9) until the established hardness level is displayed. Confirm the selection with the touch key 'OK' (5). The appliance is now programmed to provide the descaling warning when necessary, based on the actual hardness of the water.



Information on the hardness of the water in your area can be obtained from the local water board. The table below shows the water hardness setting your machine requires.

German hardness	French hardness	Water hardness machine
0 - 6 dH	0 - 11 fH	1
7 - 13 dH	12 - 17 fH	2
14 - 20 dH	18 - 36 fH	3
> 21 dH	> 37 fH	4

Adjusting contrast

To increase or reduce the contrast of the display, proceed as follows:

1. Press the touch key 'MENU' (10) to enter the menu and then the scroll touch keys (7 and 9) until "CONTRAST" is displayed.
2. Press the touch key 'OK' (5) to confirm.
3. Press the scroll touch keys (7 and 9) until the required display contrast is reached. The progressive bar indicates the level of contrast selected:
 - ▷ ●○○○○ = low
 - ▷ ●●●●● = high
4. Press the touch key 'OK' (5) to confirm.
5. Press the touch key 'RETURN' (3) once to exit the function or twice to exit the menu.

Buzzer

You can activate or deactivate the buzzer emitted by the machine each time an icon is pressed or an accessory is inserted/removed.

1. Press the touch key 'MENU' (10) to enter the menu and then the scroll touch keys (7 and 9) until "BUZZER" is displayed.
2. Press the touch key 'OK' (5) to confirm.
3. "Disable?" is displayed (or "enable?" if the function has already been disabled). Press the touch key 'OK' (5) to confirm.

SETTINGS

Statistics

You can look up the following information values:

- how many coffees have been made;
- how many milk drinks have been made (cappuccino's/latte macchiato/frothed milk);
- how many times the machine has been descaled;
- the total number of litres of water delivered.



Two cups of coffee dispensed at the same time are counted as two cups.



Proceed as follows to look up the values:

1. Press the touch key 'MENU' (10) and press the scroll touch keys (7 and 9) until the menu option "STATISTICS" appears. Confirm the menu option with the touch key 'OK' (5). By pressing the scroll touch keys (7 and 9) you can check:
 - ▷ how many coffees have been made;
 - ▷ how many milk drinks have been made;
 - ▷ how many times the machine has been descaled;
 - ▷ the total number of litres of water delivered.
2. Press the touch key 'RETURN' (11) to exit the menu.



Default values (reset)

This resets all menu settings and programmed quantities back to the default values (with the exception of the language which remains as set).

To reset the default values, proceed as follows:

1. Press the touch key 'MENU' (10) and press the scroll touch keys (7 and 9) until the menu option "DEFAULT VALUES" appears.
2. Confirm the menu option with the touch key 'OK' (5).
3. The display shows "CONFIRM?".
4. Confirm the menu option with the touch key 'OK' (5).

SETTINGS

Descaling

Over time, leads the continuous heating of the water that is used to make coffee to lime deposits in the inner circuits of the machine. Descale the machine when the message “DESCALE” flashes on the display.



Use the descaler recommended by the manufacturer only. Under no circumstances should you use sulphamic or acetic based descalers. Their use invalidates the guarantee. Descale the appliance as described.

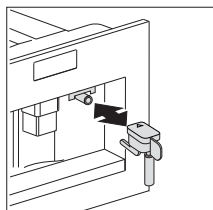

1. Insert the hot water spout.
2. Press the touch key ‘MENU’ (10) and press the scroll touch keys (7 and 9) until the menu option “DESCALE” appears. Confirm the menu option with the touch key ‘OK’ (5).
3. The display shows “CONFIRM?”. Confirm with the touch key ‘OK’ (5).

The message “ADD DESCALER PRESS OK” is displayed.

4. Empty the tank of water, pour the contents of the descaler bottle (125 ml) into the tank respecting the instructions given on the descaler pack, then add 1 liter water. For subsequent descaling operations, descaling solution can be purchased from authorised technical service centres.



Make sure that any splashes from the descaling product do not come into contact with surfaces that are sensitive to acids, such as marble, limestone and ceramic.

5. Put an empty container with a capacity of at least 1,5 litres underneath the coffee spouts and hot water spout.
6. Press the touch key ‘OK’ (5).
The display shows “DESCALING IN PROGRESS”. The descale program starts and the descaler liquid is delivered first from the coffee spouts and then from the hot water spout.
 - The descale programme automatically performs a series of rinses and pauses to remove limescale deposits from inside the machine.

SETTINGS

- After about 30 minutes, the message “RINSING FILL TANK” is displayed. The appliance is now ready for a rinsing process with clean water.
- 7. Empty the container used to collect the descaler solution.
- 8. Take out the water tank, empty the watertank and fill it with clean water.
- 9. Put the water tank back in place and put the container back under the coffe spouts and the hot water spout.
The display shows: “RINSING PRESS OK”.
- 10. Press the touch key ‘OK’ (5).
 - Hot water flows out of the coffee spouts and the message “RINSING PLEASE WAIT” is displayed.
 - Once the rinsing is finished, the message “RINSING FILL TANK” is displayed.
- 11. Empty the container used to collect the water used for rinsing.
- 12. Take out the water tank, empty the watertank and fill it with clean water.
- 13. Put the water tank back in place and put the container back under the coffe spouts and the hot water spout.
The display shows: “RINSING PRESS OK”.
- 14. Press the touch key ‘OK’ (5).
 - Hot water flows out of the hot water spout.
 - Once the rinsing is finished, the display shows “RINSING COMPLETE PRESS OK”.
- 15. Press the touch key ‘OK’ (5).
 - The appliance goes off automatically.



If the descaling cycle is interrupted before completion, the appliance continues to display the descale message and the program must be started again from the beginning.

Failure to descale the appliance invalidates the guarantee.

MAINTENANCE

Cleaning

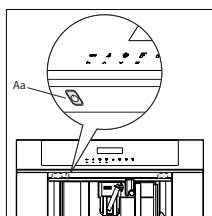

Before performing any cleaning operations, the machine must be turned off by pressing the main switch (A) and unplugged from the mains power supply. Never immerse the coffee maker in water.

Cleaning the coffee machine

Do not use solvents or abrasive detergents to clean the coffee maker. A soft damp cloth will suffice. Never wash any of the components of the coffee maker in the dishwasher.

The following parts of the machine must be cleaned regularly:

- Waste coffee container (Q).
- Drip tray (F).
- Water tank (D).
- Coffee spouts (H).
- Pre-ground coffee funnel (U).
- Inside of the machine, accessible after opening the service door (G).
- Brewing unit (L).

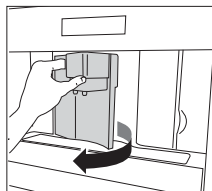

Cleaning the waste coffee container (Q)

When “EMPTY WASTE COFFEE CONTAINER” is displayed, the waste coffee container must be emptied and cleaned. To clean:

- Open the service door on the front of the appliance, extract the drip tray and clean.
- Clean the waste coffee container thoroughly.

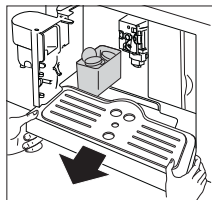

Important! When extracting the drip tray, the waste coffee container must always be emptied.

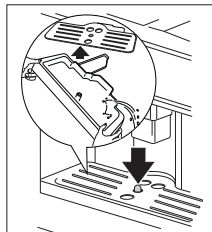

Cleaning the drip tray (F)

Important! If the drip tray is not emptied the water might overflow. This could damage the machine. The drip tray is fitted with a level indicator (red) showing the level of water it contains. Before the indicator protrudes from the cup tray, the drip tray must be emptied and cleaned.

MAINTENANCE

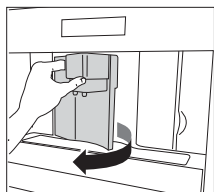

To remove the drip tray (F):

1. Open the service door.
2. Remove the drip tray and the waste coffee container.
3. Clean the drip tray and waste coffee container.
4. Replace the drip tray and waste coffee container.
5. Close the service door.

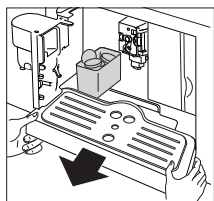

Cleaning the water tank (D)

1. Clean the water tank regularly (about once a month) with a damp cloth and a little mild washing up liquid.
2. Remove all traces of washing up liquid.

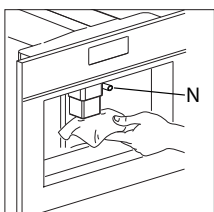

Cleaning the spouts

1. Clean the spouts periodically using a sponge.
2. Check regularly that the holes in the coffee spout are not blocked. If necessary, remove coffee deposits with a toothpick.

Milk residues left on the nozzle (N) and in the container may jeopardise correct operation of the appliance.

Each time you use the coffee maker, they must therefore be removed by cleaning the nozzle with a sponge.

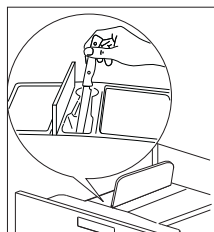
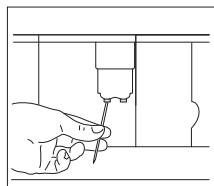

Cleaning the pre-ground coffee funnel

- Check regularly (about once a month) that the pre-ground coffee funnel is not blocked.

MAINTENANCE

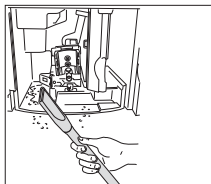

Cleaning the inside of the coffee maker

- Check regularly (about once a week) that the inside of the appliance is not dirty. If necessary, remove coffee deposits with a sponge.
- Remove the residues with a vacuum cleaner.

Cleaning the brewing unit

The brewing unit must be cleaned regularly to avoid the build-up of coffee encrustations which could cause malfunction.

The brewing unit can only be taken out when the appliance is switched off by pressing the on/stand by button (Aa). Otherwise, the coffee machine may be seriously damaged.

Proceed as follows:

1. Turn the appliance off by pressing the on/stand by button (Aa) (**do not switch off the main switch or unplug**) and wait for the display to go off.
2. Open the service door.
3. Remove the drip tray and the waste coffee container.
4. Press the two colored release buttons inwards and at the same time pull the brewing unit outwards

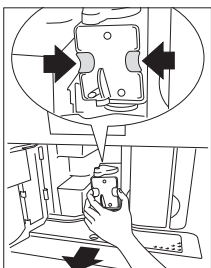

Clean the brewing unit under running tap water without using detergent. Never clean the brewing unit in the dishwasher.

Do not use washing up liquid to clean the brewing unit. It would remove the lubricant applied to the inside of the piston.

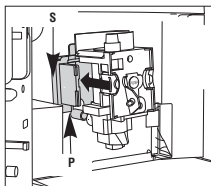

5. Soak the brewing unit in water for about 5 minutes, then rinse.
6. After cleaning, replace the brewing unit (L) by sliding it onto the internal support (S) and pin (P) at the bottom, then push the PUSH symbol fully in until it clicks into place.

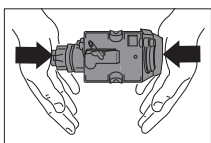

N.B.! If the brewing unit is difficult to insert, you must first adapt it to the right dimensions by pressing it forcefully from the bottom and top.

MAINTENANCE

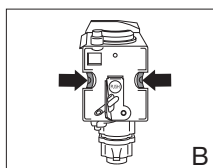
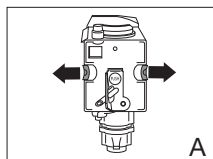

7. Once inserted, make sure the two colored buttons have snapped back out, otherwise the service door cannot be closed.
 - The two colored buttons are correctly snapped out (A).
 - The two colored buttons are not snapped out (B).
8. Replace the drip tray and waste coffee container.
9. Close the service door.

Notes

- If the brewing unit is not put in place correctly, the service door cannot be closed.
- If it is difficult to insert the brewing unit, it must be made into the right height (before inserting) by pressing the brewing unit firmly together from top and bottom.
- If it is still difficult to insert the brewing unit:
 - Leave it out of the appliance, place the drip tray, close the service door, switch the main switch on the back of the appliance to 'off' and then to 'on' again.
 - Wait for all the lights to go off, then open the door, remove the drip tray and replace the brewing unit.
 - Replace the drip tray, together with the grounds container.
 - Close the service door.

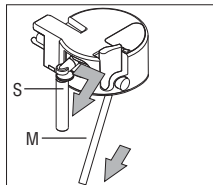
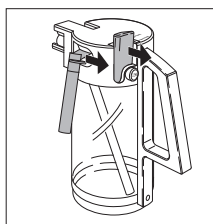

Cleaning the milk container (N)

Always clean the tubes inside the milk container when you prepare milk. If there is still milk in the container, do not leave it out of the refrigerator for longer than strictly necessary. Clean the container each time you prepare milk as described in the section "Making cappuccino".

All components can be washed in a dishwasher, placing them in the top basket of the dishwasher.

1. Turn the milk container lid clockwise then remove it.
2. Remove the milk spout (S) and intake tube (M).

MAINTENANCE

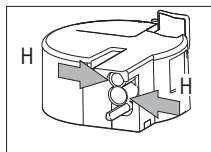
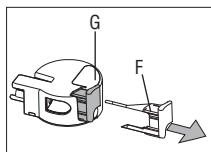

3. Remove the frothed milk regulator (F) by pulling it outwards.
4. Wash all the components thoroughly with hot water and mild washing-up liquid. Make sure there are no milk residues left inside the holes (H) and the groove (G) on the fine end of the frothed milk regulator (F).
5. Check that the intake tube and spout are not clogged with milk residues.
6. Replace the frothed milk regulator, milk spout and intake tube.
7. Replace the milk container lid.

Cleaning the spouts

Clean the spouts on the milk container every time after heating milk or making cappuccino. Otherwise, remains of milk may set hard.

- Place a container under the milk dispenser pipe and press on the CLEAN button (N3) on the milk container for at least 5 seconds. The display shows “CLEANING”!

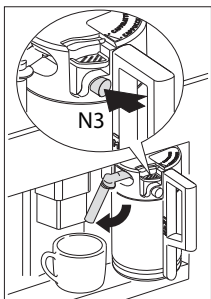

Warning! Risk of scalding from steam and hot water escaping from the milk dispenser pipe.

MESSAGES

MESSAGE	MEANING	WHAT TO DO
FILL TANK	<p>The water tank is empty or not properly in place.</p> <p>The water tank is dirty or limescale deposits have built up inside it.</p>	<p>Fill the water tank and insert it according to the instructions.</p> <p>Rinse out or descale the water tank.</p>
<p>GROUND TOO FINE ADJUST MILL + PRESS 'OK'</p> <p>or</p> <p>GROUND TOO FINE ADJUST MILL + PRESS 'OK' + FILL TANK</p>	<p>Coffee comes out too slowly.</p> <p>The coffee machine cannot make any coffee.</p>	<p>Turn the knob for the grind level setting clockwise by one position (see "Setting the grind level").</p> <p>Place a container underneath the hot water spout and press the 'hot water' touch key (13) .</p>
EMPTY WASTE COFFEE CONTAINER	The waste coffee container is full.	Empty, clean and replace the waste coffee container.
INSERT WASTE COFFEE CONTAINER	The waste coffee container was not replaced after cleaning.	Open the service door and insert the waste coffee container.
ADD PRE-GROUND COFFEE	No ground coffee was put into the filling chute after selecting the preground coffee function.	Add ground coffee as described in "Preparing espresso coffee using ground coffee".
FILL BEAN CONTAINER	<p>There are no more coffee beans in the coffee bean container.</p> <p>If the mill mechanism starts sounding very loud, this can mean that a small stone from the coffee beans has blocked the mill mechanism.</p>	<p>Fill the coffee bean container.</p> <p>Consult customer services.</p>

MESSAGES

MESSAGE	MEANING	WHAT TO DO
DESCALE	Shows that the coffee machine is encrusted with limescale.	The descaling program must be carried out as soon as possible (see “Carrying out the descaling program”).
CLOSE DOOR	The service door is open.	Close the service door. If the service door cannot be closed, make sure that the brewing unit is correctly inserted (see “Cleaning the brewing unit”).
INSERT BREWING UNIT	Someone probably forgot to put the brewing unit back in the coffee machine after cleaning it.	Insert the brewing unit, (see “Cleaning the brewing unit”).
GENERAL ALARM!	The inside of the machine is very dirty.	Carefully clean the inside of the machine (see “Cleaning the coffee machine”). If the coffee machine still shows this message once it has been cleaned, please consult customer services.

TROUBLESHOOTING

Faults table

If the appliance does not work properly, this does not always mean that it is defective. If the coffee machine does not work and a message is displayed, refer to the problem solving information (see chapter 'Messages'). If no message is displayed, try to find a solution first by checking the points mentioned in the table below, or contact the service department (see the guarantee certificate for details).

FAULT	CAUSE	SOLUTION
Coffee is not hot.	The cups were not preheated.	Preheat the cups by rinsing them out with warm water (see "Tips to make hotter coffee").
	The brewing unit is too cold.	Warm up the brewing unit with the rinsing program before making coffee (see "Rinsing").
The coffee does not have enough crema.	The coffee is too coarsely ground.	Turn the knob for the grind level setting one position anti-clockwise (see "Setting the grind level").
	The coffee blend is not suitable.	Use a coffee blend suited to fully automated coffee machines.
Coffee comes out too slowly.	The coffee is ground too fine.	Turn the knob for the grind level setting one position clockwise (see "Setting the grind level").
Coffee comes out too quickly.	The coffee is too coarsely ground.	Turn the knob for the grind level setting one position anti-clockwise (see "Setting the grind level").
Coffee only comes out of one of the spouts on the coffee dispenser.	The holes on the spouts are blocked.	Remove the dry coffee residues with a needle (see "Cleaning the coffee machine").

TROUBLESHOOTING

FAULT	CAUSE	SOLUTION
The machine does not switch on when the on/stand by button is pressed	The main switch on the right side of the appliance is not switched on or the mains plug is not plugged in.	Check that the main switch is in the 'ON' position and that the power lead is plugged in the socket properly.
The brewing unit cannot be taken out for cleaning.	The coffee machine is switched on. The brewing unit can only be removed when the machine is switched off.	Switch the appliance off and remove the brewing unit (see "Cleaning the brewing unit"). IMPORTANT: The brewing unit can only be taken out when the appliance is switched off. If you try to take out the brewing unit whilst the coffee machine is switched on, this could be seriously damaged.
Water comes out of the spouts instead of coffee.	Too much preground coffee was inserted.	Remove the brewing unit and carefully clean the insided of the machine (see "Cleaning the coffee machine" and "Cleaning the brewing unit"). Repeat the process using a maximum of 2 level measuring spoons of ground coffee.
Ground coffee was used (instead of coffee beans) and the machine will not dispense any coffee.	Preground coffee was inserted whilst the machine was switched off.	Remove the brewing unit and carefully clean the insided of the machine (see "Cleaning the coffee machine" and "Cleaning the brewing unit"). Repeat the process with the machine switched on.

TROUBLESHOOTING

FAULT	CAUSE	SOLUTION
<p>Coffee does not come out of the spouts on the coffee dispenser but out of the service door at the side.</p>	<p>The holes on the coffee dispenser are blocked with dried on coffee.</p> <p>The swing drawer on the inside of the service hatch is blocked and will not move.</p>	<p>Remove the dried on coffee with a needle (see “Cleaning the coffee machine”).</p> <p>Carefully clean the swing drawer, particularly in the area around the hinges so that these continue to move.</p>
<p>Milk is frothed up too much or too little.</p>	<p>Wrong setting of the slider on the lid of the milk container.</p> <p>If the milk is not frothy enough, the milk container may not be correctly in place.</p>	<p>You can set the amount of froth on the milk to any level using the slider on the lid: ‘CAPPUCCINO’ (very frothy milk) or ‘CAFFE LATTE’ (not so frothy milk).</p> <p>Put the milk container correctly in place.</p>

INSTALLATION INSTRUCTIONS

What you should pay attention to



- After removing the packaging, make sure the product is complete and undamaged. If in doubt, do not use the appliance and contact a qualified professional.
- Installation must be carried out by a qualified technician and in compliance with current regulations.
- Packing elements (plastic bags, polystyrene etc.) must not be left within reach of children as they may represent a hazard.
- Never install the appliance in environments where the temperature may reach 0 °C or lower (the appliance may be damaged if the water freezes).
- Make sure the mains voltage corresponds to the voltage indicated on the appliance rating plate. Connect the appliance to an efficiently earthed socket with a minimum current rating of 10A only. The manufacturer may not be considered liable for possible incidents caused by the failure to adequately earth the mains.
- Make sure the socket used is freely accessible at all times, enabling the appliance to be unplugged when necessary.
- Never touch the plug with damp hands.
- Never pull the power cable as you could damage it.
- This appliance can be installed over a built-in oven if the latter is fitted with a cooling fan at the rear (maximum power: 3KW).
- Do not use multiple plug adapters or extension leads.
- The power cable on this appliance must not be replaced by the user as this operation requires the use of special tools. If the cable is damaged or requires replacing, contact an authorised service centre only to avoid all risks.
- You should personalise water hardness as soon as possible following the instructions.

INSTALLATION INSTRUCTIONS

Building in

Please check the minimum measures necessary to the proper installation of the appliance. The coffee maker must be installed in a column unit, which must in turn be fixed to the wall.

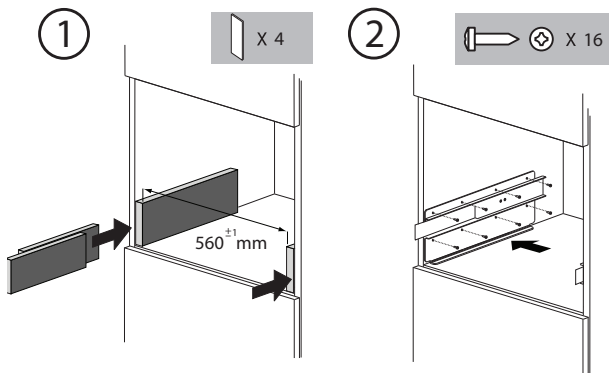
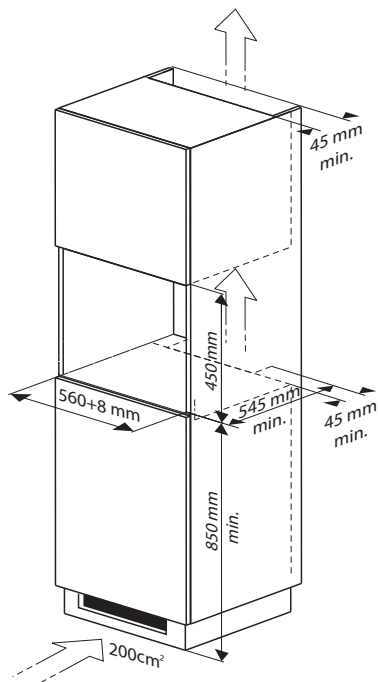

INSTALLATION INSTRUCTIONS

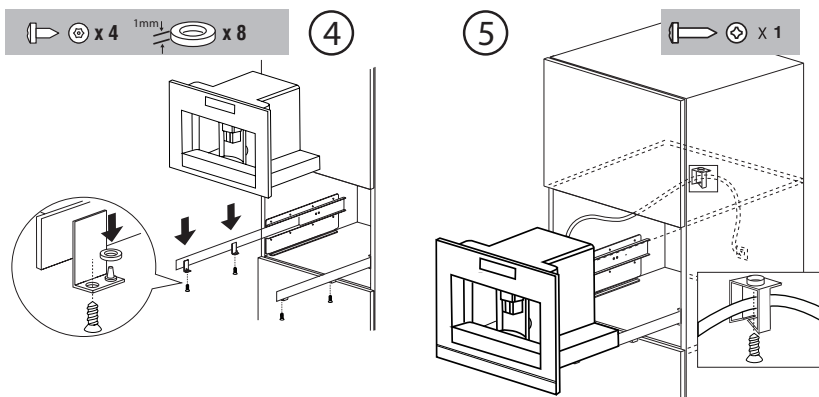

- Position the appliance on the rail, making sure the pins are correctly inserted in the housing, then fix it with the screws supplied.
- If the height of the appliance requires adjusting, use the spacer disks provided.

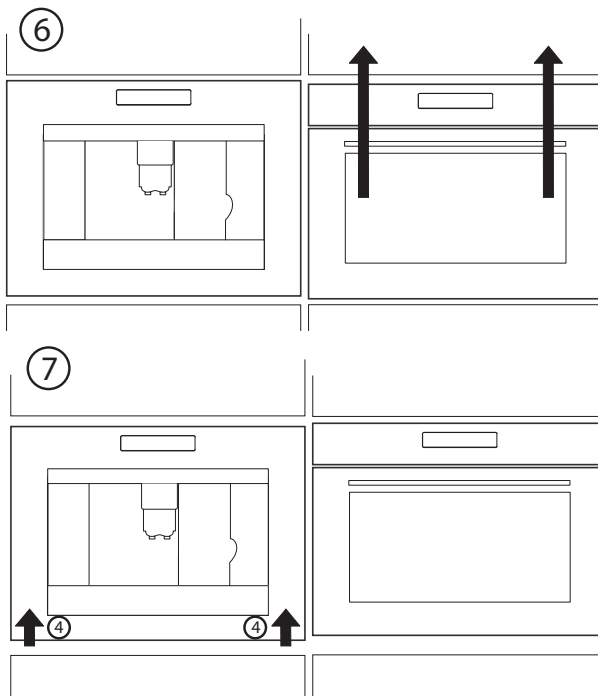

APPENDICES

Disposal of appliance and packaging

The packaging of this appliance is recyclable and may have been made of:

- cardboard
- paper
- polythene foil (PE)
- CFC-free polystyrene (PS hard foam)
- polypropylene tape (PP).

Dispose of these materials in a responsible manner and in accordance with government regulations.



The appliance carries the symbol of a crossed-out dustbin to state that segregated processing is compulsory to avoid any negative effects on the environment and public health. This means that at the end of its working life, you must hand it in at a special refuse collection centre run by your local authority or dealer.

Segregated processing enables the recovery of the materials used in the production of this appliance, thus saving considerably in terms of raw materials and energy.

Declaration of conformity

We declare that our products meet the applicable European Directives, Decisions and Regulations and the requirements listed in the standards referenced.

Technical data

The data plate on the side of the appliance states the total load when connected, the required voltage and frequency.



The appliance identification card is located on the side of the appliance.

When contacting the service department, have the complete type number to hand.

You will find the addresses and phone numbers of the service organisation on the guarantee card.

 **ASKO**



570078