



## Instructions for use

### Cooker hood

CW4930G / WS90CETHJ  
CW41230G / WS12CETHJ  
CI41230G / ES12CETIJ

---

---

EN

Instructions for use

EN 3 - EN 14



**Pictograms used**

Important information



Tipp

**ASKO**

---

## CONTENTS

---

### ***Your cooker hood***

|              |   |
|--------------|---|
| Introduction | 4 |
|--------------|---|

### ***Use***

|                  |   |
|------------------|---|
| Description      | 5 |
| Operation        | 6 |
| Cleaning filters | 8 |

### ***Maintenance***

|          |    |
|----------|----|
| Cleaning | 9  |
| Lighting | 11 |

### ***Technical specifications***

12

### ***Appendix***

|          |    |
|----------|----|
| Disposal | 14 |
|----------|----|

---

## YOUR COOKER HOOD

---

### *Introduction*

---

On reading these user manuals you will soon become familiar with the features of this appliance. Please read the appliance's safety and maintenance instructions.



*Please retain the operating and installation instructions as these may be useful for future reference.*



**Please read the separate safety instructions prior to use.**

## USE

### Description

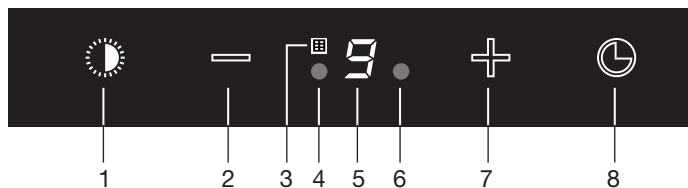

1. Switching on/off and dimming the lighting
2. Reducing air extraction capacity and switching off
3. Cleaning filter indicator
4. Proximity sensor
5. Display status
6. Proximity sensor
7. Switching on and increasing air extraction capacity
8. Timer function indicator

## Operation



### Switching extraction on and off

- Press the '+' key.  
*The cooker hood will switch on at the lowest setting.*
- Press the '+' key again to set a higher extraction setting. Press and hold the '+' key for 2 seconds to select the highest setting (boost) (see switching on boost setting).  
*The extraction setting can be set between speeds level 1 to 5 or 9.*
- Press the '-' key to select a lower setting.
- If the extraction setting is set at 1, you can switch off the cooker hood by quickly pressing and releasing the '-' key.
- To switch off the cooker hood from whatever setting press and hold the '-' key for at least 2 seconds.



### Alter the number of speed-settings

You can choose between 9 speed-settings (default) or 5 speed-settings.

- Press and hold the '-' key and '+' key for at least 5 seconds.  
*This selects the 5 speed-setting option. Press and hold the '-' key and '+' key again for at least 5 seconds to select the 9 speed-setting option.*



### Switching on recirculation

- Simultaneously press and hold the timer key and the lighting key until the filter indicator flashes 3 times.  
*The carbon filter indicator is activated.*

### Switching off recirculation

- Simultaneously press and hold the timer key and the lighting key until the filter indicator lights up.



### Switching the lighting on and off

- Quickly press and release the lighting key.  
*The light switches on at maximum strength.*
- Press and hold the lighting key to set the lighting strength.  
*The lighting changes from maximum to minimum strength and vice versa.*
- To turn off the light, quickly press and release the lighting key while the light is on.

## Changing the colour temperature

Choose the temperature colour of the light from warm to cold.

- Press and hold the lighting key. Press the '+' key to make the light 'colder' or press the '-' key to make the light 'warmer'.

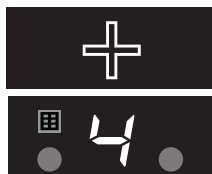

## Switch on boost setting:

- Press and hold the '+' key for approximately 2 seconds.  
*The boost setting (setting 'b' or 7,8,9) is switched on for 10 minutes. The display will flash during this period. The original extraction setting will be reactivated after this period.*
- Quickly press and release the '-' key to switch off the boost setting.



## Switching on the timer

- Press the timer key.  
*The timer indicator will start to blink. The cooker hood will switch off automatically after 10 minutes.*
- Switch off the timer function by pressing a random key (except the one for lighting).



## Note!

If the boost setting has been selected you cannot activate the timer function.



## Clean Air function

The Clean Air function allows you to freshen the air in your kitchen for a maximum of 24 hours at level 1.

- Switch off the cooker hood.
- Press and hold the timer key for approximately 3 seconds.  
*The cooker hood will switch on automatically for 10 minutes every hour at the lowest speed setting. During extraction the display will show a fast rotating 'snake'. When the hood switches off after 10 minutes, the display will show a slow rotating 'snake' until the hood switches on again after 50 minutes.*
- Switch off the Clean Air function in the meantime by pressing a random key (except the one for lighting).

### Active mode

- The proximity sensor detects a user standing in front of the hood and will illuminate the icons. After 3 seconds the lighting will automatically switch on.



### Disable the active mode

- Simultaneously press the '+' and 'timer' key for 3 seconds.  
*The active mode is disabled. The display show an static 'U'.*

### Enable the active

- Simultaneously press the '+' and timer key for 3 seconds.  
*The active mode is enabled. The display show 3 times a blinking 'U'.*

## Cleaning filters

### Saturation grease and carbon filters

The filters should be replaced or cleaned when the grease filter indicator or the carbon filter indicator are lit. See chapter 'Maintenance'.

### Grease filter

The filter indicator will light up after 30 operating hours.

- The grease filters should then be cleaned.
- Reset the memory by pressing and holding the '-' key until the filter indicator stops flashing.



### Carbon filter

The filter indicator will flash after 120 operating hours.

- The carbon filter should then be cleaned or replaced.
- Reset the memory by simultaneously pressing and holding the '-' and '+' keys until the filter indicator stops flashing.



### Cleaning



#### **Important!**

For all maintenance first switch off the mains power to the cooker hood by pulling the plug out of the socket or by turning off the home's master switch. The hood needs to be cleaned regularly, both inside as well as outside (at least in the same frequency as the grease filter cleaning). Do not use abrasive cleaning products. **Do not use alcohol!**

#### **Important!**

If the instructions regarding cleaning the appliance or replacing the filters are not followed, this can cause a fire. These instructions should be followed! The manufacturer is not liable for damage to the hood or fire damage resulting from incompetent maintenance or from non-adherence to the above safety instructions.

#### **Cooker hood**

Clean the cooker hood with soapy water and a soft cloth. Then wash off with clean water. Do not use aggressive cleaning agents such as caustic soda. The cooker hood finish stays in good condition if it is buffed periodically following the application of wax.

#### **Stainless steel cooker hoods**



Do not use scouring pads or other abrasive cleaners on stainless steel cooker hoods. Finish with a non-abrasive, non-polishing agent and buff the stainless steel in the direction of the grain.

#### **Metal grease filters**

Metal grease filters should be cleaned once a month (or when indicated by the filter cleaning indicator – if present on the model) using a neutral cleaning agent, either by hand or in the dishwasher on a short, low-temperature program. Place the grease filters with the openings facing downwards in the dishwasher so the water can drain out of the filter. Aluminium grease filters become dull as a result of dishwasher cleaning agents. This is normal and does not effect the working.

## MAINTENANCE

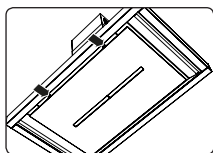

### Removing cassette filter

- 1 Switch off the motor and lighting.
- 2 Push in the locking lugs at the front behind the glass plate and pull the glass plate carefully out of the seal. Tilt the glass plate downwards.
- 3 Open the filter's access hatch.
- 4 Remove the filter from the hood.

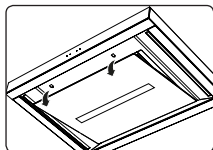

### Cleaning

The filters can be cleaned in the dishwasher. Allow the filters to drain well before replacing.

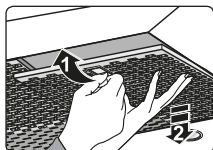

The filters can also be cleaned by hand.

Clean the filters in soapy water with washing up liquid and rinse. Allow the filters to drain well. Consult chapter 'Cleaning'. The underside of the cooker hood can be cleaned with a mild cleaning agent and a damp cloth. Dry off with a paper towel.

### Replacing cassette filter

The filter should be placed with the locking mechanism on the front. Open the filter access hatch. The notches at the front of the filter will then slot in. Hold the access hatch in this position when placing the filters.

- 1 Slot the notches at the back of the filter in the specially designed opening of the cooker hood.
- 2 Tilt the filter upwards.
- 3 Release the filter access hatch. The notches at the back of the filter will extend outwards and slot into the specially designed openings of the cooker hood.  
*The filter is now in position again.*
- 4 Press the glass plate firmly in the seal again (you will hear a click).



**The glass plate can be removed for cleaning. Always remove the glass plate with 2 persons (due to its weight)!**

## MAINTENANCE

### Active carbon filters:

The regenerable active carbon filter must be washed by hand with neutral cleaning products, or in the dishwasher at a maximum temperature of 65 °C (the washing should be done without any plates, dishes, cups, etc. in the machine).

Remove the excess water without damaging the filter, remove the holder and let the filter dry in the oven for at least 15 minutes at a maximum temperature of 100 °C.

To keep the regenerable carbon filter efficient, this action should be repeated every 2 months or when indicated by the filter indicator.

The filter must be replaced after no more than 3 years, or if it has been damaged.



**It is important that the grease filters and the regenerable active carbon filter are thoroughly dry before repositioning.**

### Replacing the carbon filter:

The grease filters should first be removed before replacing the carbon filter.

1. Open the filter access hatch.
2. Tilt the carbon filter downwards to remove it.
3. Repeat the steps above in reverse order, to replace the carbon filter.

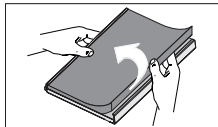
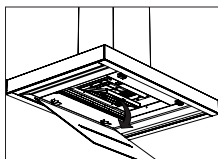

### Operation:

- Using a carbon filter creates more sound than when using the cooker hood with an outlet.
- The carbon filter's operation is optimal at a lower motor speed. You should, therefore, avoid using the boost function.

## Lighting



### Attention!

This hood is fitted with LED light! These have to be replaced by a authorized technician. Do not attempt to replace LED light by yourself.

## TECHNICAL SPECIFICATIONS

| Hood type                                   | <b>CW4930G</b>                          | <b>CW41230G</b>                         |
|---|---|---|
| Type / Approval                             | Wall / WS90CETHJ                        | Wall / WS12CETHJ                        |
| Control type                                | Touch control                           | Touch control                           |
| Width                                       | 90 cm                                   | 120 cm                                  |
| Supply<br>Voltage, Frequency                | 220-240 V, 50/60 Hz                     | 220-240 V, 50/60 Hz                     |
| Power                                       | 177,6 W                                 | 177,6 W                                 |
| Power motor                                 | 170 W                                   | 170 W                                   |
| Power lights                                | 2 x LED 3,8 W                           | 2 x LED 3,8 W                           |
| <b>Level 1</b><br>Air flow, Noise, Pressure | 240 m <sup>3</sup> /h, 44 dB(A), 69 Pa  | 246 m <sup>3</sup> /h, 44 dB(A), 67 Pa  |
| <b>Level 2</b><br>Air flow, Noise, Pressure | 315 m <sup>3</sup> /h, 50 dB(A), 124 Pa | 331 m <sup>3</sup> /h, 50 dB(A), 125 Pa |
| <b>Level 3</b><br>Air flow, Noise, Pressure | 347 m <sup>3</sup> /h, 51 dB(A), 155 Pa | 366 m <sup>3</sup> /h, 52 dB(A), 157 Pa |
| <b>Level 4</b><br>Air flow, Noise, Pressure | 375 m <sup>3</sup> /h, 52 dB(A), 180 Pa | 395 m <sup>3</sup> /h, 53 dB(A), 173 Pa |
| <b>Level 5</b><br>Air flow, Noise, Pressure | 398 m <sup>3</sup> /h, 54 dB(A), 206 Pa | 418 m <sup>3</sup> /h, 55 dB(A), 197 Pa |
| <b>Level 6</b><br>Air flow, Noise, Pressure | 457 m <sup>3</sup> /h, 57 dB(A), 272 Pa | 475 m <sup>3</sup> /h, 56 dB(A), 261 Pa |
| <b>Level 7</b><br>Air flow, Noise, Pressure | 617 m <sup>3</sup> /h, 63 dB(A), 390 Pa | 642 m <sup>3</sup> /h, 63 dB(A), 391 Pa |
| <b>Level 8</b><br>Air flow, Noise, Pressure | 713 m <sup>3</sup> /h, 66 dB(A), 389 Pa | 694 m <sup>3</sup> /h, 66 dB(A), 390 Pa |
| <b>Level 9</b><br>Air flow, Noise, Pressure | 786 m <sup>3</sup> /h, 69 dB(A), 391 Pa | 818 m <sup>3</sup> /h, 69 dB(A), 389 Pa |

## TECHNICAL SPECIFICATIONS

|   |   |
|---|---|
| <b>Hood type</b>                            | <b>CI41230G</b>                         |
| <b>Type / Approval</b>                      | Island / ES12CETIJ                      |
| <b>Control type</b>                         | Touch control                           |
| <b>Width</b>                                | 120 cm                                  |
| <b>Supply</b><br>Voltage, Frequency         | 220-240 V, 50/60 Hz                     |
| <b>Power</b>                                | 179 W                                   |
| <b>Power motor</b>                          | 170 W                                   |
| <b>Power lights</b>                         | 2 x LED 4,5 W                           |
| <b>Level 1</b><br>Air flow, Noise, Pressure | 272 m <sup>3</sup> /h, 45 dB(A), 70 Pa  |
| <b>Level 2</b><br>Air flow, Noise, Pressure | 355 m <sup>3</sup> /h, 49 dB(A), 127 Pa |
| <b>Level 3</b><br>Air flow, Noise, Pressure | 383 m <sup>3</sup> /h, 54 dB(A), 151 Pa |
| <b>Level 4</b><br>Air flow, Noise, Pressure | 419 m <sup>3</sup> /h, 52 dB(A), 184 Pa |
| <b>Level 5</b><br>Air flow, Noise, Pressure | 443 m <sup>3</sup> /h, 54 dB(A), 206 Pa |
| <b>Level 6</b><br>Air flow, Noise, Pressure | 496 m <sup>3</sup> /h, 57 dB(A), 266 Pa |
| <b>Level 7</b><br>Air flow, Noise, Pressure | 674 m <sup>3</sup> /h, 65 dB(A), 386 Pa |
| <b>Level 8</b><br>Air flow, Noise, Pressure | 728 m <sup>3</sup> /h, 66 dB(A), 388 Pa |
| <b>Level 9</b><br>Air flow, Noise, Pressure | 865 m <sup>3</sup> /h, 69 dB(A), 382 Pa |

## *Disposal*

### **Disposal of packaging and appliance**

Sustainable materials have been used during manufacture of this appliance. This appliance must be disposed of responsibly at the end of its life cycle. Ask your local authorities for more information about how to do this.

The appliance packaging is recyclable. The following materials may have been used:

- cardboard;
- polyethylene film (PE);
- CFC-free polystyrene (PS-rigid foam);

Dispose of these materials in a responsible manner and in accordance with government regulations.

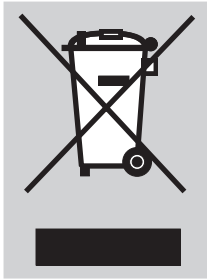

The product has been marked with a crossed-out dustbin symbol to remind you of the obligation to dispose of electrical household appliances separately. This means that the appliance may not be included with normal domestic refuse at the end of its service life. The appliance must be taken to a special municipal centre for separated waste collection or to a dealer providing this service.

Separate processing of household appliances prevents the potentially negative consequences for the environment and health that can arise as a result of inappropriate processing. It ensures that the materials of which the appliance is composed can be recovered to obtain significant savings in energy and raw materials.



 **ASKO**



708960