

ASKO



使用说明书
抽油烟机

Instructions for use
Cooker hood

CW4936S / WS90APTAE
CW41236S / WS12APTBE

ZHS 手册

ZHS 3 - ZHS 23

EN Manual

EN 3 - EN 23

使用的图示 - Pictograms used



重要信息 - Important information



提示 - Tip

目录

抽油烟机		
	介绍	4
使用		
	描述	5
	操作	6
	清洁过滤网	8
保养		
	清洁	9
安装		
	概述	12
	连接	13
	内置尺寸	14
	组件	15
技术规格		
		22
附录		
	处置	23

抽油烟机

介绍

阅读这些用户指南，您会很快熟悉本设备的功能。请阅读本设备的安全和保养说明。



请保留操作和安装说明书，这些资料可备后用。



请在使用本设备前阅读单独的安全说明。

说明

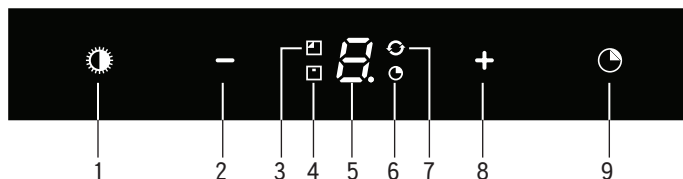

1. 开启/关闭和调节照明
2. 降低风力设置并关闭
3. 清洁活性炭过滤网指示器
4. 清洁油脂过滤网指示器
5. 显示状态
6. 计时器功能指示器
7. 清洁空气功能指示器
8. 开启并提高风力设置
9. 开启计时器功能



注意事项！

- 启用或停用功能之前，必须关闭电机和照明器具。
- 如果抽油烟机配有活性炭过滤网，应当按照“清洁过滤网”一节的说明，启用活性炭过滤网指示器。

操作



开启和关闭

- 按下“+”键（8）。
抽油烟机以最低设置开启。
- 按下“+”键（8），设定更高风力设置。按住“+”键（8）2 秒钟，选择最高设置（快速）（请参阅“开启强效设置”）。
抽气风力设置范围为 1 至 5 或 9（视乎型号而定）。
- 按下“-”键（2），选择更低设置。
风力设置显示在显示器（5）中。
- 如果风力设置为 1，快速按住并松开“-”键（2）即可关闭抽油烟机。
- 要从任意设置中关闭抽油烟机，按住“-”键（2）至少 2 秒钟。



更改风力设置值（某些型号为 9 种风力设置）

可以选择 9 种风力设置（标准）或 5 种风力设置。

- 按住“-”键（2）和“+”键（8）至少 5 秒钟。
此操作将选择 5 种风力设置选项。按住“-”键（2）和“+”键（8）至少 5 秒钟，选择 9 种风力设置选项。



开启和关闭照明器具

- 快速按住并松开照明键（1）。
灯具以最大强度开启。
- 按住照明键（1），设置照明强度。
- 要关灯，在灯打开时，快速按住并松开照明键（1）。
照明强度从最大变为最小，反之亦然。

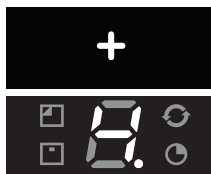

开启强效设置：

- 按住“+”键（8）约 2 秒钟。
强效设置（设置“P”）开启十分钟（视乎型号而定）。在此期间，显示器将闪烁（5）。此期间后，原风力设置将停用。
- 快速按住并松开“+”（8）键，关闭强效设置。



启动计时器

- 按下计时器键（9）。
计时器指示器（6）将亮起。
抽油烟机在 10 分钟后自动关闭。
- 按住“-”键（2）关闭计时器功能。

如果灯亮起，计时器关闭后，其亮度将降低 30-40%。



注意事项！

如果选择强效设置，则无法启用计时器功能。



清洁空气功能

清洁空气功能可以使厨房在最多 12 小时内保持空气清新。

- 关闭抽油烟机。
- 按下计时器键（9）约 4 秒钟。
抽油烟机每小时以最低设置自动开启 10 分钟。抽气期间，清洁空气指示器将闪烁（7）。
10 分钟后，抽油烟机关闭，清洁空气指示器（7）将持续亮起，直至抽油烟机在 50 分钟后再次开启。
- 按下任意键（照明键除外）的同时将关闭清洁空气功能。

清洁过滤网

饱和脂和活性炭过滤网

当油脂过滤网指示器 (4) 或活性炭过滤网指示器 (3) 亮起时, 应当更换或清洁过滤网。

油脂过滤网



油脂过滤网指示器 (4) 将在工作 30 小时后闪烁。

- 然后应清洁油脂过滤网。
- 按住“-”键 (2) 直至油脂过滤网指示器 (4) 停止闪烁, 即可重置存储器。

活性炭过滤网



活性炭过滤网指示器 (3) 将在工作 120 小时后闪烁。

- 然后应清洁活性炭过滤网。
- 同时按住“-”键 (2) 和“+”键 (8) 直至活性炭过滤网指示器 (3) 停止闪烁, 即可重置存储器。

开启活性炭过滤网指示器



- 同时按住“+” (8) 键和照明键 (1), 直至活性炭过滤网指示器 (3) 闪烁两次。

活性炭过滤网指示器将启用。



关闭活性炭过滤网指示器

- 同时按住“+” (8) 键和照明键 (1), 直至活性炭过滤网指示器 (3) 闪烁一次。

活性炭过滤网指示器开启:

- 活性炭过滤网指示器 (3) 亮起 3 秒钟。

活性炭过滤网指示器关闭:

- 活性炭过滤网指示器 (3) 闪烁 3 秒钟。

清洁



重要！

在进行任何保养时，首先从插座拔出插头或者关闭屋内总开关，关闭抽油烟机主电源。抽油烟机的内外表面需要定期清洁（清洁频率至少与油脂过滤网的清洁频率相同）。请勿使用砂纸清洁本产品。**请勿使用酒精！**

重要！

如果未遵循清洁设备或更换过滤网的相关说明，可能会导致火灾。应遵循这些说明！因保养不当或未遵循上述安全说明导致抽油烟机损坏或火灾损害，制造商概不负责。

抽油烟机

请使用肥皂水和软布清洁抽油烟机。

然后用清水冲洗。请勿使用侵蚀性清洁剂（例如氢氧化钠）。如果用蜡定期对抽油烟机进行表面抛光，可使其保持良好状态。



不锈钢抽油烟机

请勿使用钢丝球或其他磨蚀性清洁剂来清洁不锈钢抽油烟机。使用非磨蚀性、非磨光剂进行表面抛光，以及按照纹理方向磨亮不锈钢。

金属油脂过滤网

金属油脂过滤网应当用中性清洁剂每月（或者过滤网清洁指示器发出指示时）清洁一次，采用手洗或者在洗碗机的短暂、低温程序下清洗。在洗碗机内放置油脂过滤网时，开口向下，便于水从过滤网排出。铝质油脂过滤网在洗碗机清洁剂的作用下会变暗。这是正常现象，不会影响工作。

保养

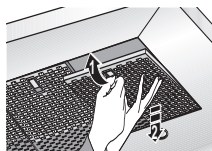

移除盒式过滤网

- 1 关闭电机和照明器具。
- 2 打开检查盖。
- 3 从抽油烟机移除过滤网。

清洁

过滤网可使用洗碗机清洁。更换前将过滤网滤干。

过滤网也可用手清洁。

在肥皂水中用洗涤剂清洁，再冲洗干净。将过滤网滤干。请参阅第 9 页了解说明。抽油烟机的下面可用温和的清洁剂和湿布清洁。用纸巾擦干。

更换盒式过滤网

须使用过渡网旁边的闭锁机构将其固定。打开检查盖。过滤网旁边的槽口随后卡入。固定过滤网后，将检查盖固定在此位置。

- 1 将过滤网背面的槽口卡入抽油烟机旁边特别设计的开口中。
- 2 向上倾斜过滤网。
- 3 松开过滤网检查盖。过滤网背面的槽口伸出并卡入抽油烟机特别设计的开口中。
过滤网现在再次就位。

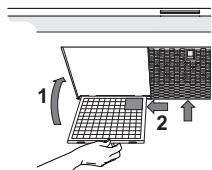

注意事项！

将油脂过滤网装回其原始装配位置（见图）。
正确固定油脂过滤网到位，确保最有效地抽吸。

保养

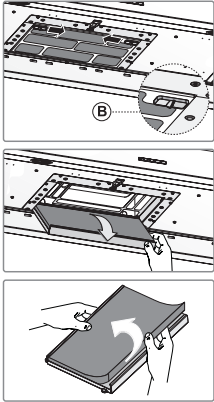

活性炭过滤网：

可再生活性碳过滤网必须使用中性清洁产品用手清洗，或者使用洗碗机在最大温度为 65 ° C 条件下清洗（在洗碗机中清洗时不得放置任何盘、碟、杯等餐具）。

在不损坏过滤网的情况下，清除多余的水，移除支架，让过滤网在烤炉中以最大温度为 100 ° C 的条件下干燥 15 分钟。

为确保可再生活性碳持续有效，应当每 2 个月或者当过滤网指示器发出指示时，重复执行此操作。

必须在 3 年内或者在过滤网受损时予以更换。



务必注意，在油脂过滤网和可再生活性碳过滤网完全干燥后再装回。

更换活性炭过滤网：

应当先移除油脂过滤网再更换活性炭过滤网。

- 向里按两下活性炭过滤网上的“B”键。
- 向下倾斜活性炭过滤网将其移除。
- 以相反顺序重复上述操作，装回活性炭过滤网。

操作：

- 相比配备排出口的抽油烟机，使用活性炭过滤网会产生更大噪音。
- 最好以较低电机速度运行活性炭过滤网。
因此，应当避免使用快速功能。



注意！

本抽油烟机配备 LED 灯！必须由授权技术人员进行更换。
请勿尝试自行更改 LED 灯。



概述

须由其了解并遵循适用安全规范的注册安装人员将本设备连接至主电源。我们在此声明，我们的产品安全性符合欧洲指令、命令及法规，以及您所在国家/地区的相关要求。

重要信息：

- 抽油烟机的最低点与燃气炉之间的距离应至少为 65 厘米。如果使用电炉、陶瓷炉或电磁炉，则此距离应当至少为 55 厘米。
- 关于燃气设备的通风，请遵循适用法规。
- 使用短排气管及尽可能减少弯头，抽油烟机工作会更高效。
- 钻孔之前，请检查是否存在管路或电缆。
- 抽油烟机连接管直径为 120 毫米、125 毫米或 150 毫米。尽可能使用相同直径且最大尺寸的连接管（150 毫米）。
- 本抽油烟机随附安装材料适用于钢筋混凝土和砖墙。某些墙壁需要使用特殊的插栓和螺丝。

安装

接线

电气接线

本电器为 I 类设备，因此必须装接地系统。

请确保电源电压值与设备铭牌上的电压相符。

电源接线如下：

棕色 = 火线

蓝色 = 零线

黄/绿色 = 地线

导电连接时须确保电源插座有接地线。

本电器带有电源插头。安装罩子时，请确保此插头仍然可用。



注意事项！

如果您想进行固定连接，则应确定电源线中安装了全极开关，并且应保持 3 毫米以上的接触间隔。

安装

内置规格

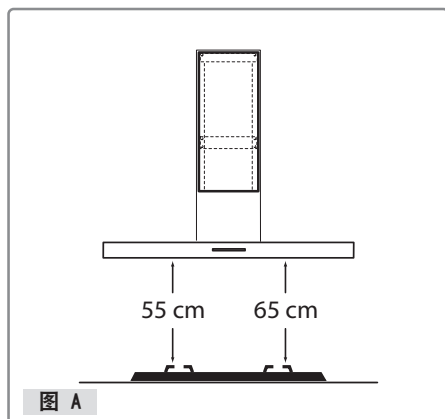

安装高度：

燃气炉上的平底锅支撑架与抽油烟机的下边缘之间的最小距离应当为 65 厘米。如果使用电炉、陶瓷炉或电磁炉，则此距离应当至少为 55 厘米。

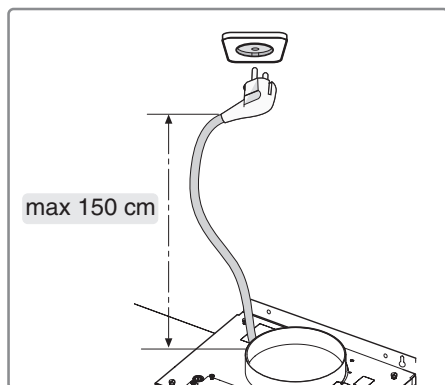

安装

组件



本抽油烟机可能较重，因此，建议至少安排两人安装本抽油烟机。



图 1

- 在墙壁上画出抽油烟机的下方轮廓，考虑抽油烟机与炉具之间的最小距离。

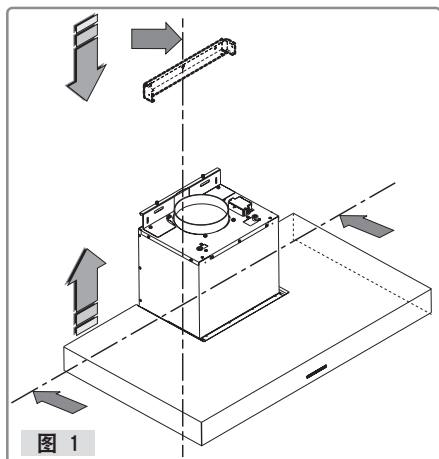

图 1a

- 将模具置于墙壁上，确保线条与墙壁上之前画出的线条保持一致。标出孔的位置并钻孔（如 1a）。

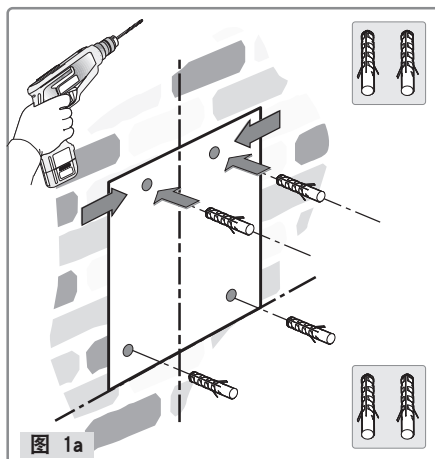

图 2

- 参照图 A 中的规格放置支架，用随附螺丝和插栓（图 2）固定支架。

安装

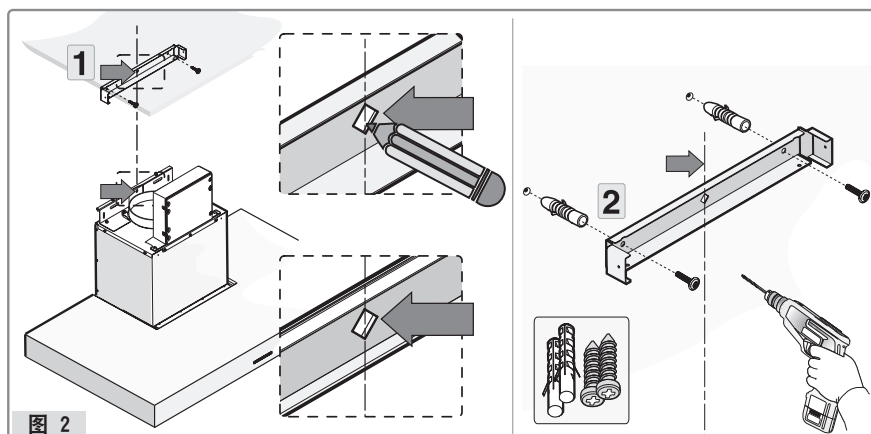

图 3

- 靠墙固定支架，与两个最高的孔对齐。使用随附螺丝将其固定。应当使用适用于墙壁类型（例如钢筋混凝土、石膏板等）的组件、螺丝和延伸插栓。如果抽油烟机随附螺丝和插栓，请事先确定这些零部件适用于要安装抽油烟机的墙壁。

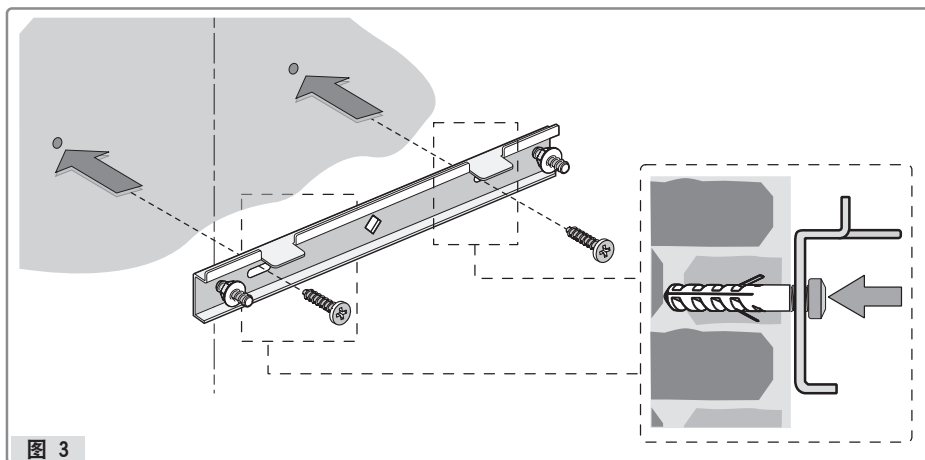

图 4

- 安装抽油烟机之前，垂直固定电气装置（图 4）。

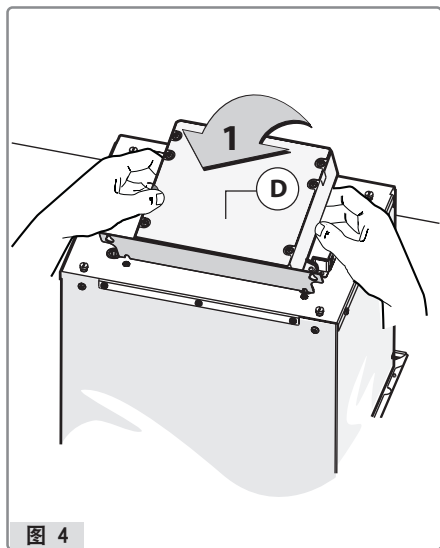

图 5

- 用 4 颗螺丝 G 固定支架，如图 5 所示。

安装

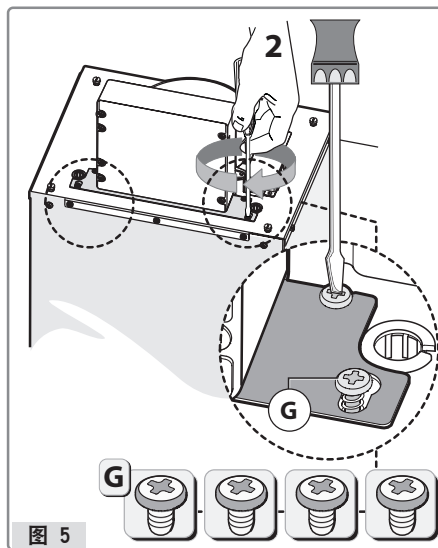
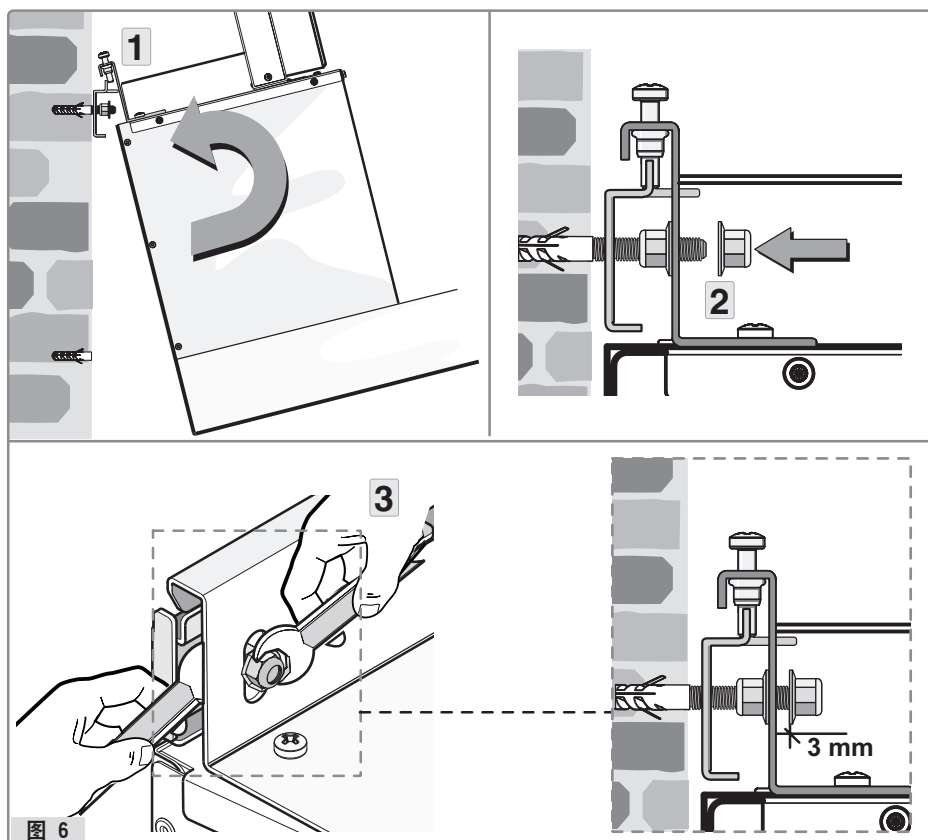

- 图 6
- 略微倾斜抽油烟机，牢固钩住支架，如图所示（图 6 步骤 1）。
 - 放置抽油烟机并用螺母拧紧至螺丝，将其固定至支架（图 6 步骤 2）。
 - 一只用手合适的扳手固定，然后另一只手用另一个扳手反方向拧紧螺母（图 6 步骤 3）。螺母与支架之间的距离应当至少为 3 毫米。

安装

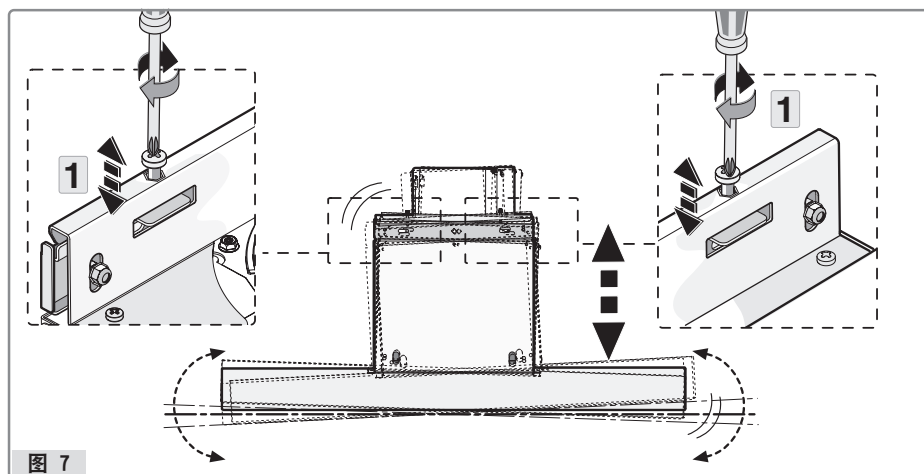

- 用两颗校平螺丝水平对齐抽油烟机（图 7 步骤 1）。

安装

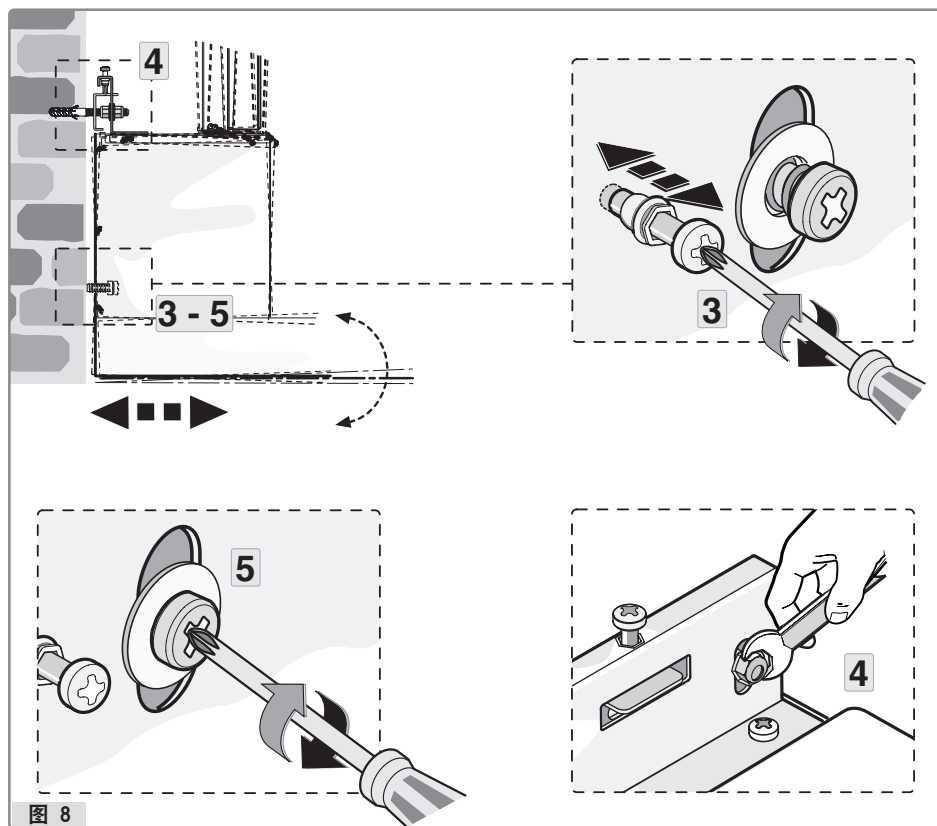

- 图 8
- 用两颗固定螺丝在电机外壳中垂直对齐抽油烟机（图 8 步骤 3）。
 - 校平抽油烟机后，应当如图 8 步骤 4 所示完全紧固螺丝，以同样的方式紧固安全螺丝（图 8 步骤 5）。

安装

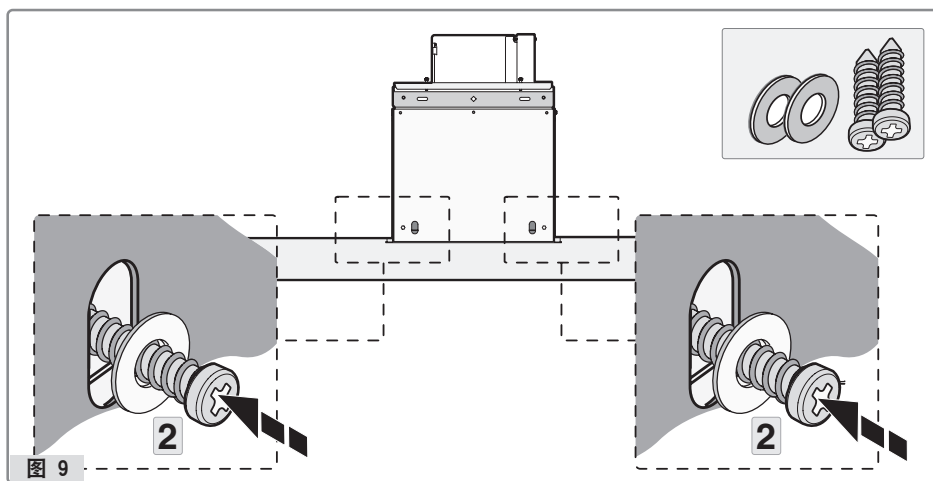

- 用两颗随附的螺丝和密封圈对抽油烟机进行最后加固（图 9 步骤 2）。

安装

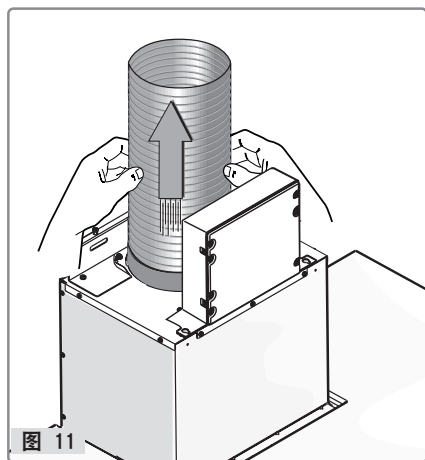

- 使用连接管将法兰连接至排气管（图 11）。

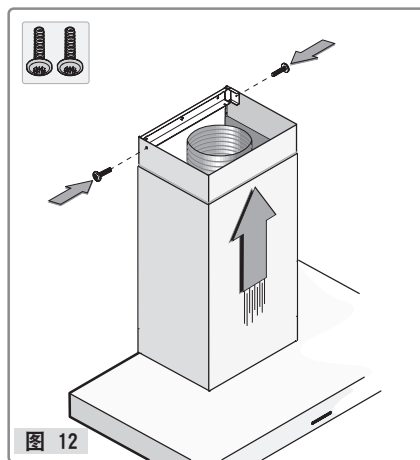

- 连接上机罩与下机罩，并置于抽油烟机外壳上。靠着支架滑动上机罩，用两颗螺丝固定（图 12）。
-
- 将电源插头插入插座并测试设备是否运作正常。

技术规格

抽油烟机型号	CW4936S	CW41236S
型号/批准	Wall / WS90APTAE	Wall / WS12APTBE
控制器类型	触摸式控制器	触摸式控制器
宽度	90 cm	120 cm
电源 电源、频率	220-240 V, 50/60 Hz	220-240 V, 50/60 Hz
功率	237 W	240.5 W
电机功率	230 W	230 W
灯功率	2 x LED 3.5 W	3 x LED 3.5 W
全压效率 (≥ 23)	38 %	38 %
待机功率	-	-
关机功率 (≤ 1)	0.50 W	0.50 W
常态气味降低度 (≥ 95)	95 %	95 %
风量 (≥ 10) (= 600 m³/h)	660 m³/h	654 m³/h
风压 (≥ 100)	380 Pa	390 Pa
油脂分离度 (≥ 80)	88 %	89 %
噪声 (≤ 72)	70 dB	63 dB
1级 气流、噪音、压强	266 m³/h, 39 dB(A), 169 Pa	266 m³/h, 39 dB(A), 169 Pa
2级 气流、噪音、压强	358 m³/h, 47 dB(A), 315 Pa	358 m³/h, 47 dB(A), 315 Pa
3级 气流、噪音、压强	438 m³/h, 47 dB(A), 315 Pa	438 m³/h, 47 dB(A), 315 Pa
4级 气流、噪音、压强	491 m³/h, 55 dB(A), 420 Pa	491 m³/h, 55 dB(A), 420 Pa
5级 气流、噪音、压强	610 m³/h, 55 dB(A), 421 Pa	610 m³/h, 55 dB(A), 421 Pa
6级 气流、噪音、压强	660 m³/h, 70 dB(A), 380 Pa	654 m³/h, 63 dB(A), 390 Pa
7级 气流、噪音、压强	790 m³/h, 67 dB(A), 424 Pa	790 m³/h, 67 dB(A), 424 Pa
8级 气流、噪音、压强	836 m³/h, 69 dB(A), 425 Pa	836 m³/h, 69 dB(A), 425 Pa
9级 气流、噪音、压强	930 m³/h, 71 dB(A), 425 Pa	930 m³/h, 71 dB(A), 425 Pa

处置

包装与设备的处置

制造本设备时采用了可持续材料。本设备使用寿命结束后，必须采用负责的方式处置。咨询当地主管部门，了解关于如何处置的更多信息。

本设备的包装可以回收利用。可能使用了以下包装材料：

- 纸板；
- 聚乙烯薄膜（PE）；
- 不含 CFC 的聚苯乙烯（PS 硬质泡沫）；

这些材料均应采用负责任的方式，按照政府规定处置。



本产品标有画叉图案的垃圾箱标识符，提醒您有义务单独处置家用电器。这表示设备使用寿命结束时，不得作为普通生活垃圾处置。设备必须交由市政中心运营的专门的垃圾收集处，或者交由提供该项服务的商家。

单独处置家用电器可防止因处理不当而对环境和人类健康造成负面影响。它可以确保设备的组成材料得到回收利用，大大节省能源和原材料。

CONTENTS

Your cooker hood

Introduction	4
--------------	---

Use

Description	5
Operation	6
Cleaning filters	8

Maintenance

Cleaning	9
----------	---

Installation

General	12
Connection	13
Build-in dimensions	14
Assembly	15

Technical specifications

22

Appendix

Disposal	23
----------	----

YOUR COOKER HOOD

Introduction

On reading these user manuals you will soon become familiar with the features of this appliance. Please read the appliance's safety and maintenance instructions.



Please retain the operating and installation instructions as these may be useful for future reference.



Please read the separate safety instructions prior to use.

USE

Description

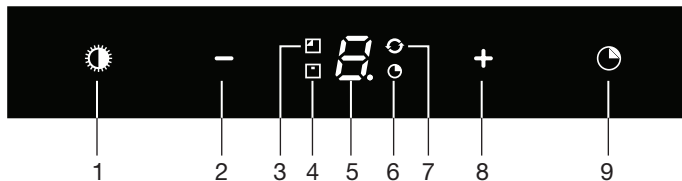

1. Switching on/off and dimming the lighting
2. Reducing air extraction capacity and switching off
3. Cleaning carbon filter indicator
4. Cleaning grease filter indicator
5. Display status
6. Timer function indicator
7. Clean Air function indicator
8. Switching on and increasing air extraction capacity
9. Switching on timer function



Note!

- Prior to activating or deactivating a function, the motor and lighting should be switched off.
- If you have a cooker hood with a carbon filter, you should activate the carbon filter indicator as described in the 'Cleaning filters' paragraph.

Operation



Switching extraction on and off

- Press the '+' button (8).
The cooker hood will switch on at the lowest setting.
- Press the '+' button (8) again to set a higher extraction setting. Press and hold the '+' button (8) for 2 seconds to select the highest setting (boost) (see switching on intensive setting).
The extraction setting can be set between speeds 1 to 5 or 9 (depending on the model).
- Press the '-' button (2) to select a lower setting.
The extraction setting is indicated in the display (5).
- If the extraction setting is set at 1, you can switch off the cooker hood by quickly pressing and releasing the '-' button (2).
- To switch off the cooker hood from whatever setting press and hold the '-' button (2) for at least 2 seconds.

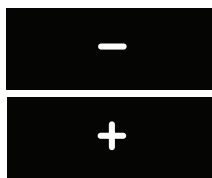

Alter the number of speed-settings (models with 9 speed-settings)

You can choose between 9 speed-settings (standard) or 5 speed-settings.

- Press and hold the '-' button (2) and '+' button (8) for at least 5 seconds.
This selects the 5 speed-setting option. Press and hold the '-' button (2) and '+' button (8) again for at least 5 seconds to select the 9 speed-setting option.



Switching the lighting on and off

- Quickly press and release the lighting button (1).
The light switches on at maximum strength.
- Press and hold the lighting button (1) to set the lighting strength.
- To turn off the light, quickly press and release the lighting button (1) while the light is on.
The lighting changes from maximum to minimum strength and vice versa.



Switch on intensive setting:

- Press and hold the '+' button (8) for approximately 2 seconds.
The intensive setting (setting 'P') is switched on for ten minutes (depending on the model). The display will flash (5) during this period. The original extraction setting will be reactivated after this period.
- Quickly press and release the '+' (8) button to switch off the intensive setting.



Switching on the timer

- Press the timer button (9).
The timer indicator (6) will light up. The cooker hood will switch off automatically after 10 minutes.
- Switch off the timer function by pressing the '-' button '2'.

If the lighting is lit its strength will be reduced automatically by 30-40% once the timer has finished.



Note!

If the intensive setting has been selected you cannot activate the timer function.



Clean Air function

The Clean Air function allows you to freshen the air in your kitchen for a maximum of 12 hours.

- Switch off the cooker hood.
- Press and hold the timer button (9) for approximately 4 seconds.
The cooker hood will switch on automatically for 10 minutes every hour at the lowest speed setting. During extraction the Clean Air indicator will flash (7). When the hood switches off after 10 minutes, the Clean Air indicator (7) will be lit continuously until the hood switches on again after 50 minutes.
- Switch off the Clean Air function in the meantime by pressing a random button (except the one for the lighting).

Cleaning filters

Saturation grease and carbon filters

The filters should be replaced or cleaned when the grease filter indicator (4) or the carbon filter indicator (3) are lit.

Grease filter



The grease filter indicator (4) will flash after 30 operating hours.

- The grease filters should then be cleaned.
- Reset the memory by pressing and holding the '-' button (2) until the grease filter indicator (4) stops flashing.

Carbon filter



The carbon filter indicator (3) will flash after 120 operating hours.

- The carbon filter should then be cleaned or replaced.
- Reset the memory by simultaneously pressing and holding the '-' (2) and '+' (8) buttons until the carbon filter indicator (3) stops flashing.



Switching on carbon filter indicator

- Simultaneously press and hold the '+' (8) button and the lighting button (1) until the carbon filter indicator (3) flashes twice.

The carbon filter indicator is activated.



Switching off carbon filter indicator

- Simultaneously press and hold the '+' (8) button and the lighting button (1) until the carbon filter indicator (3) flashes once.

The carbon filter indicator is switched on:

- The carbon filter indicator (3) lights up for 3 seconds.

The carbon filter indicator is switched off:

- The carbon filter indicator (3) flashes for 3 seconds.

Cleaning



Important!

For all maintenance first switch off the mains power to the cooker hood by pulling the plug out of the socket or by turning off the home's master switch. The hood needs to be cleaned regularly, both inside as well as outside (at least in the same frequency as the grease filter cleaning).

Do not use abrasive cleaning products. **Do not use alcohol!**

Important!

If the instructions regarding cleaning the appliance or replacing the filters are not followed, this can cause a fire. These instructions should be followed! The manufacturer is not liable for damage to the hood or fire damage resulting from incompetent maintenance or from non-adherence to the above safety instructions.

Cooker hood

Clean the cooker hood with soapy water and a soft cloth.

Then wash off with clean water. Do not use aggressive cleaning agents such as caustic soda. The cooker hood finish stays in good condition if it is buffed periodically following the application of wax.

Stainless steel cooker hoods



Do not use scouring pads or other abrasive cleaners on stainless steel cooker hoods. Finish with a non-abrasive, non-polishing agent and buff the stainless steel in the direction of the grain.

Metal grease filters

Metal grease filters should be cleaned once a month (or when indicated by the filter cleaning indicator – if present on the model) using a neutral cleaning agent, either by hand or in the dishwasher on a short, low-temperature program. Place the grease filters with the openings facing downwards in the dishwasher so the water can drain out of the filter.

Aluminium grease filters become dull as a result of dishwasher cleaning agents. This is normal and does not effect the working.

MAINTENANCE

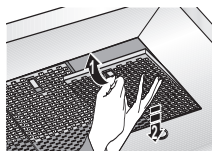

Removing cassette filter

- 1 Switch off the motor and lighting.
- 2 Open the access hatch.
- 3 Remove the filter from the hood.

Cleaning

The filters can be cleaned in the dishwasher. Allow the filters to drain well before replacing.

The filters can also be cleaned by hand.

Clean the filters in soapy water with washing up liquid and rinse. Allow the filters to drain well. See page 9 for instructions. The underside of the cooker hood can be cleaned with a mild cleaning agent and a damp cloth. Dry off with a paper towel.

Replacing cassette filter

The filter should be placed with the locking mechanism on the side. Open the filter access hatch. The notches at the side of the filter will then slot in. Hold the access hatch in this position when placing the filters.

- 1 Slot the notches at the back of the filter in the specially designed opening to the side of the cooker hood.
- 2 Tilt the filter upwards.
- 3 Release the filter access hatch. The notches at the back of the filter will extend outwards and slot into the specially designed openings of the cooker hood.

The filter is now in position again.

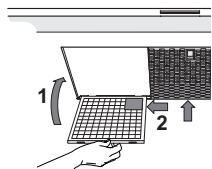

Please note!

Replace the grease filters in their original assembled position (see figure).

Positioning the grease filters correctly ensures the most efficient extraction.

MAINTENANCE

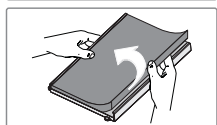
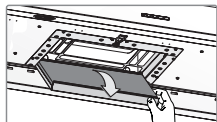
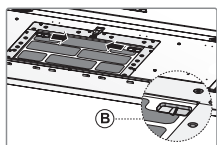

Active carbon filters:

The regenerable active carbon filter must be washed by hand with neutral cleaning products, or in the dishwasher at a maximum temperature of 65 °C (the washing should be done without any plates, dishes, cups, etc. in the machine).

Remove the excess water without damaging the filter, remove the holder and let the filter dry in the oven for at least 15 minutes at a maximum temperature of 100 °C.

To keep the regenerable carbon filter efficient, this action should be repeated every 2 months or when indicated by the filter indicator.

The filter must be replaced after no more than 3 years, or if it has been damaged.



It is important that the grease filters and the regenerable active carbon filter are thoroughly dry before repositioning.

Replacing the carbon filter:

The grease filters should first be removed before replacing the carbon filter.

- Press the two 'B' buttons on the carbon filter inwards.
- Tilt the carbon filter downwards to remove it.
- Repeat the steps above in reverse order, to replace the carbon filter.

Operation:

- Using a carbon filter creates more sound than when using the cooker hood with an outlet.
- The carbon filter's operation is optimal at a lower motor speed. You should, therefore, avoid using the boost function.



Attention!

This hood is fitted with LED light! These have to be replaced by a authorized technician. Do not attempt to replace LED light by yourself.

INSTALLATION

General

This appliance should be connected to the mains power by a registered installer, who knows and applies the correct safety specifications.

We hereby declare that our products satisfy the applicable European directives, orders and regulations, as well as the requirements stated in your country.

Important information:

- The distance between the lowest point of the cooker hood and a gas hob should be at least 65 cm. With an electric, ceramic or induction hob this distance should be at least 55 cm.
- Follow the applicable local regulations regarding the ventilation of gas appliances.
- The cooker hood will work better with a short outlet pipe and the fewest bends possible.
- Prior to drilling check that there are no pipes or cables present.
- The cooker hood connection pipe is 120 mm, 125 mm or 150 mm in diameter. Use the largest possible (150 mm) flue of the same diameter.
- The installation material provided with this cooker hood is suitable for reinforced concrete and brick walls. You will need special plugs and screws for certain walls.

INSTALLATION

Connection

Electrical connection

This appliance is manufactured in class I, it must therefore be connected to the earth system.

Make sure the supply voltage ratings correspond with those stated on the appliance data plate. The connection to the mains is carried out as follows:

BROWN = phase L

BLUE = phase N

YELLOW/GREEN = Earth

During the electrical connection make sure that the electrical socket is equipped with earth connection.

This appliance has been provided with a power plug. When installing the hood, make sure that this plug remains accessible.



Please note!

If you want to make a fixed connection, make sure that an omnipolar switch with a contact separation of at least 3 mm is fitted in the supply line.

INSTALLATION

Build-in dimensions

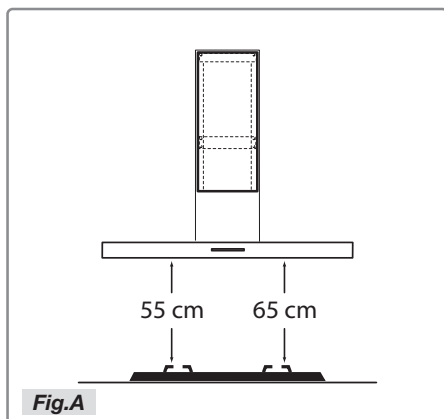

Installation height:

The minimum distance between a gas hob's pan supports and the lower edge of the hood should be 65 cm. For use with an electric, ceramic or induction hob this distance should be at least 55 cm.

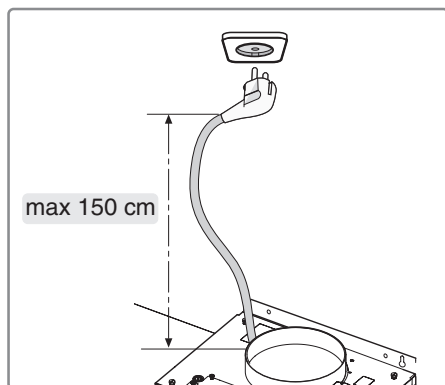

INSTALLATION

Assembly



This hood could be heavy, therefore we advise to install this hood with at least two people.

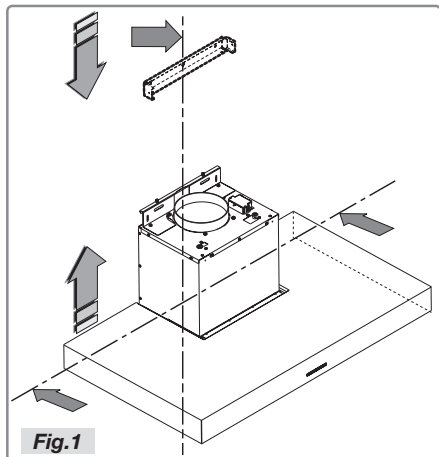

Fig.1

- Outline the underside of the hood on the wall, taking into account the minimum distance between the hood and the hob.

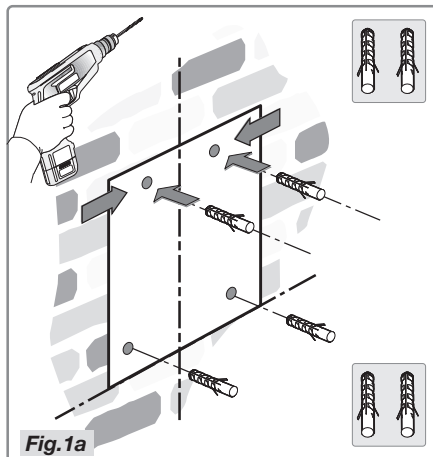

Fig.1a

- Place the template on the wall and ensure that the line corresponds to the line previously drawn on the wall. Mark the position of the holes and drill these (Fig.1a).

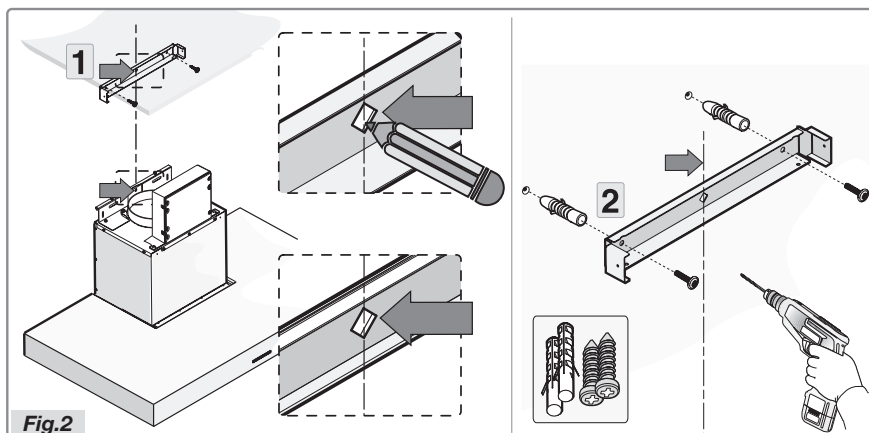

Fig.2

- Position the bracket referring to the dimensions in Figure A and secure this with the supplied screws and plugs (Fig. 2).

INSTALLATION

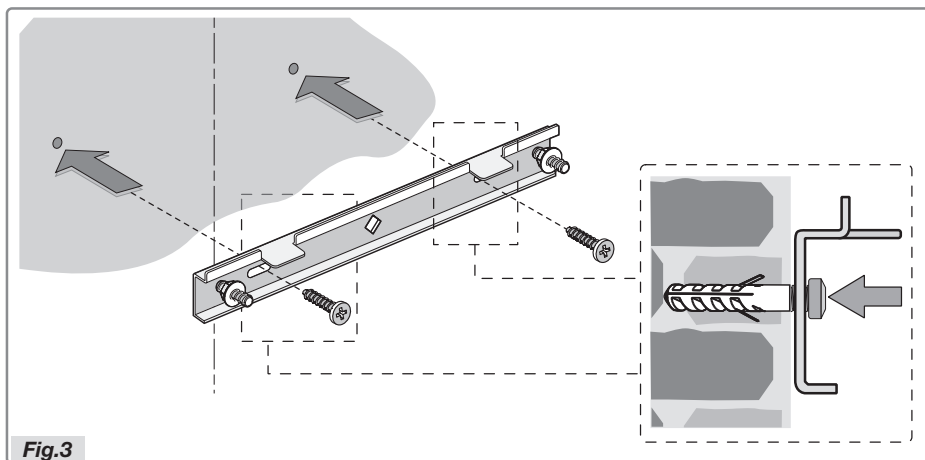

Fig.3

- Place the bracket against the wall, align it with the two highest holes. Secure it with two supplied screws. For assembly, screws and expansion plugs should be used that are suitable for the wall type (for example reinforced concrete, plasterboard, etc.). If screws and plugs are supplied with the hood, make sure in advance that these are suitable for the wall on which the hood is to be installed.

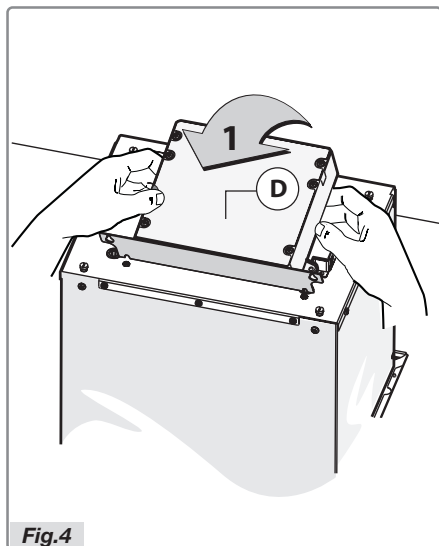

Fig.4

- Before installing the cooker hood fit the electric unit upright (Fig.4).

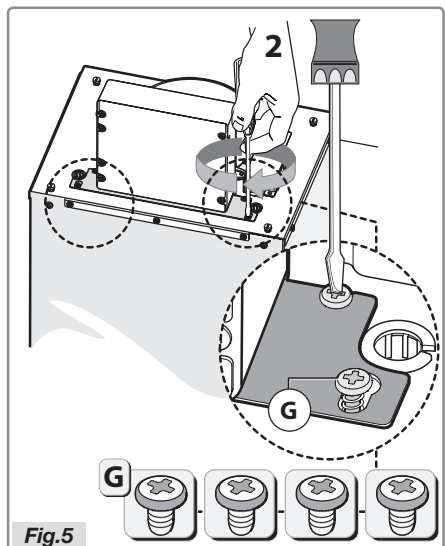

Fig.5

- Secure the bracket with the four screws **G**, as indicated in Figure 5.

INSTALLATION

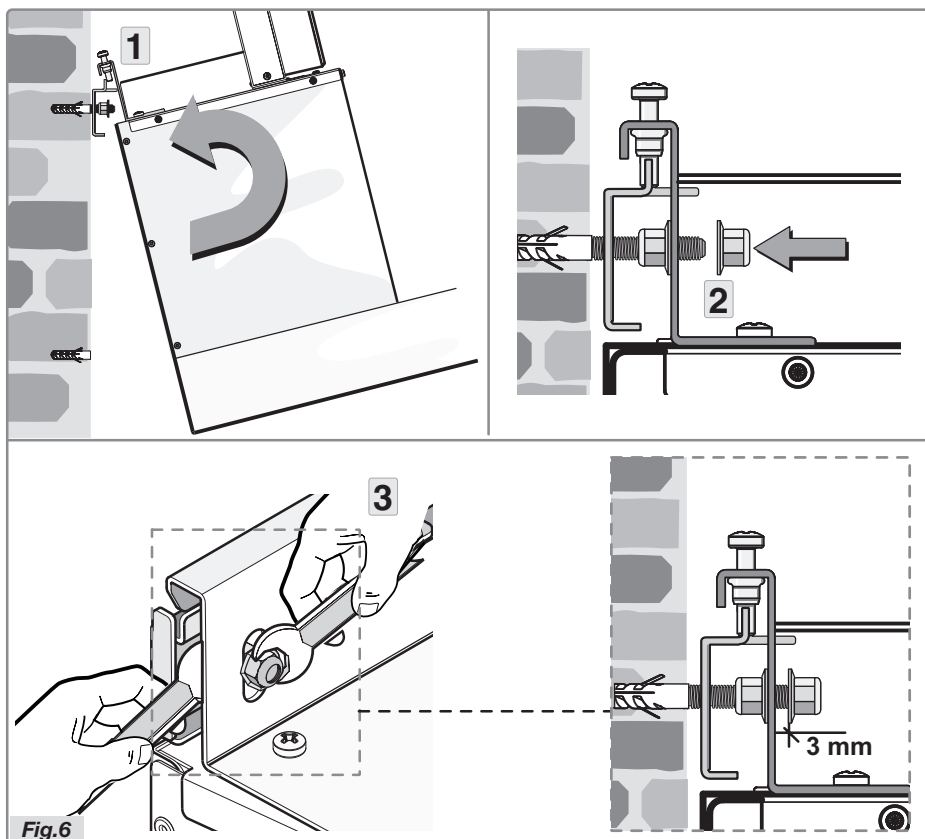
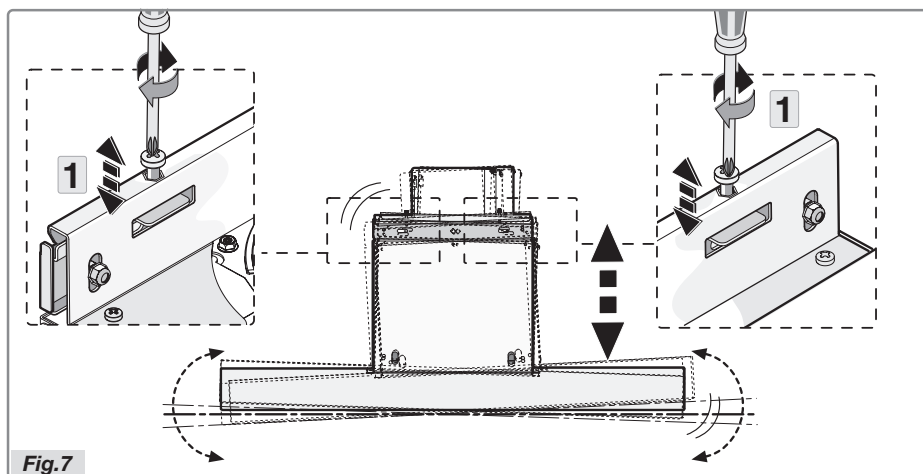

Fig.6

- Tilt the hood slightly and hook it securely to the bracket, as illustrated (Fig.6 step 1).
- Position the cooker hood and secure it to the bracket by applying the nut to the screw (Fig.6 step 2).
- Hold an appropriate spanner in one hand and use a second spanner in the other hand to counter the nut (Fig.6 step 3). The distance between the nut and the bracket should be at least 3 mm.

INSTALLATION



- Align the cooker hood horizontally using the two levelling screws (Figure 7 step 1).

INSTALLATION

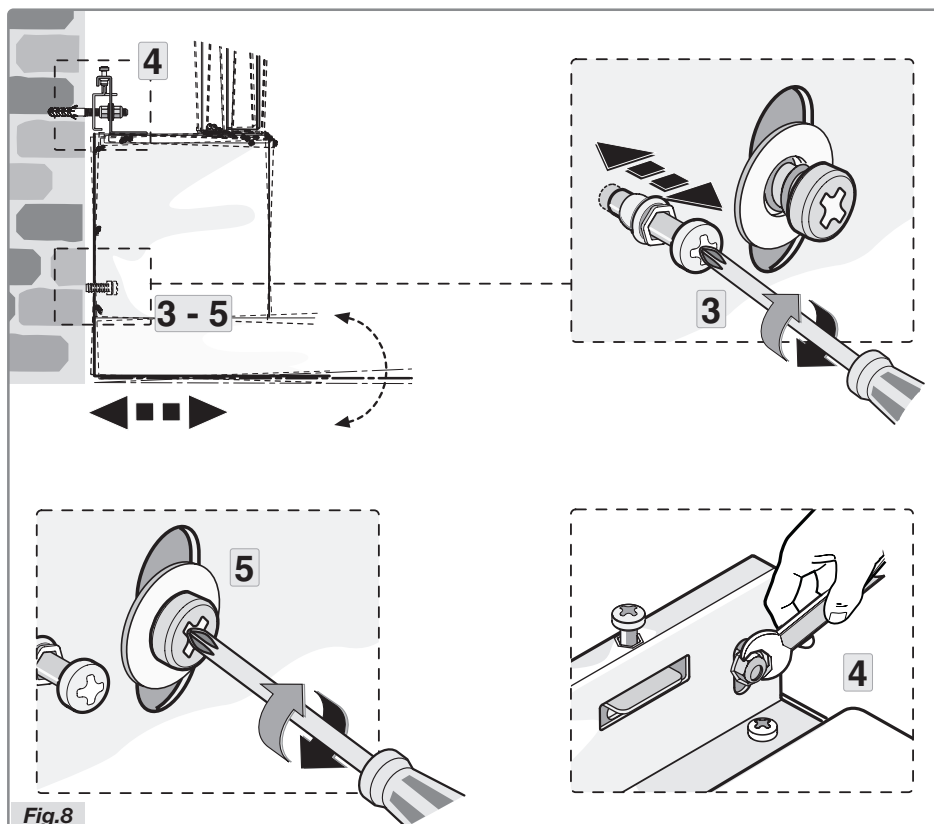

- Align the cooker hood vertically using the two set screws in the motor housing (Fig. 8 step 3).
- After levelling the hood, you should secure the screws completely as indicated in Figure 8 step 4, and do the same with the safety screws (Fig. 8 step 5).

INSTALLATION

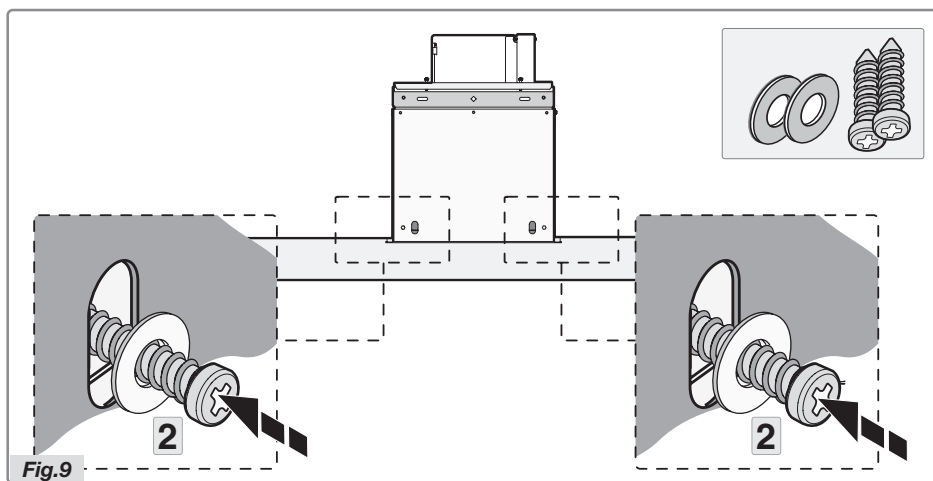

- Secure the cooker hood definitively with the two supplied screws and rings (Figure 9 step 2).

INSTALLATION

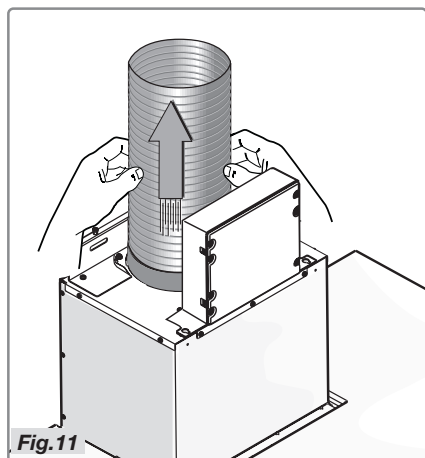

- Connect the flange to the air outlet using a tube (Fig.11).

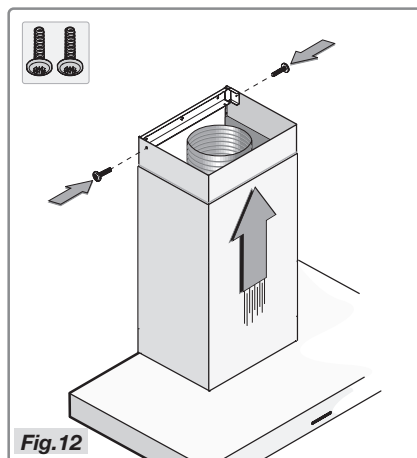

- Place the top shaft in the bottom shaft and put this on the hood's casing. Slide the top shaft against the bracket and secure this with the two screws (Fig.12).
- Put the power plug into the socket and test if the appliance operates correctly.

TECHNICAL SPECIFICATIONS

Hood type	CW4936S	CW41236S
Type / Approval	Wall / WS90APTAE	Wall / WS12APTBE
Control type	Touch control	Touch control
Width	90 cm	120 cm
Supply Voltage, Frequency	220-240 V, 50/60 Hz	220-240 V, 50/60 Hz
Power	237 W	240.5 W
Power motor	230 W	230 W
Power lights	2 x LED 3.5 W	3 x LED 3.5 W
Fan Total Efficiency (≥ 23)	38 %	38 %
Standby Mode Power	-	-
Off Mode Power (≤ 1)	0.50 W	0.50 W
Normal Odour Reduction Factor (≥ 95)	95 %	95 %
Airflow (≥ 10) (= 600 m³/h)	660 m³/h	654 m³/h
Air Pressure (≥ 100)	380 Pa	390 Pa
Grease absorption factor (≥ 80)	88 %	89 %
Sound power level (≤ 72)	70 dB	63 dB
Level 1 Air flow, Noise, Pressure	266 m³/h, 39 dB(A), 169 Pa	266 m³/h, 39 dB(A), 169 Pa
Level 2 Air flow, Noise, Pressure	358 m³/h, 47 dB(A), 315 Pa	358 m³/h, 47 dB(A), 315 Pa
Level 3 Air flow, Noise, Pressure	438 m³/h, 47 dB(A), 315 Pa	438 m³/h, 47 dB(A), 315 Pa
Level 4 Air flow, Noise, Pressure	491 m³/h, 55 dB(A), 420 Pa	491 m³/h, 55 dB(A), 420 Pa
Level 5 Air flow, Noise, Pressure	610 m³/h, 55 dB(A), 421 Pa	610 m³/h, 55 dB(A), 421 Pa
Level 6 Air flow, Noise, Pressure	660 m³/h, 70 dB(A), 380 Pa	654 m³/h, 63 dB(A), 390 Pa
Level 7 Air flow, Noise, Pressure	790 m³/h, 67 dB(A), 424 Pa	790 m³/h, 67 dB(A), 424 Pa
Level 8 Air flow, Noise, Pressure	836 m³/h, 69 dB(A), 425 Pa	836 m³/h, 69 dB(A), 425 Pa
Level 9 Air flow, Noise, Pressure	930 m³/h, 71 dB(A), 425 Pa	930 m³/h, 71 dB(A), 425 Pa

Disposal

Disposal of packaging and appliance

Sustainable materials have been used during manufacture of this appliance. This appliance must be disposed of responsibly at the end of its life cycle. Ask your local authorities for more information about how to do this.

The appliance packaging is recyclable. The following materials may have been used:

- cardboard;
- polyethylene film (PE);
- CFC-free polystyrene (PS-rigid foam);

Dispose of these materials in a responsible manner and in accordance with government regulations.

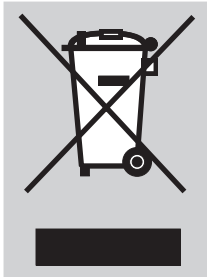

The product has been marked with a crossed-out dustbin symbol to remind you of the obligation to dispose of electrical household appliances separately. This means that the appliance may not be included with normal domestic refuse at the end of its service life. The appliance must be taken to a special municipal centre for separated waste collection or to a dealer providing this service.

Separate processing of household appliances prevents the potentially negative consequences for the environment and health that can arise as a result of inappropriate processing. It ensures that the materials of which the appliance is composed can be recovered to obtain significant savings in energy and raw materials.

 **ASKO**



528616