

Hisense

life reimagined

USER'S OPERATION MANUAL

Before operating this unit, please read this manual thoroughly, and retain for future reference.

WF7S1247BW

WF7S1247B*

EN

English

This washing machine is intended solely for household use.
Please do not use it for any laundry labelled as not suitable for machine washing.

The following symbols used in the manual have the following meanings:

 Information, advice, tip, or recommendation

 Warning - general danger

 Warning - danger of electric shock

 Warning - danger of hot surface

 Warning - danger of fire



It is important to read the instructions carefully.

CONTENTS

4	SAFETY PRECAUTIONS	INTRODUCTION
12	WASHING MACHINE DESCRIPTION	
13	Specifications	
14	INSTALLATION AND CONNECTION	PREPARING BEFORE FIRST USE
15	Removing the transport screws/rods	
16	Moving and transport after installation	
17	Location	
17	Adjusting feet	
18	Installation clearances	
19	Connecting to water supply	
19	Aquastop	
20	Connecting and securing drain hose	
22	Connecting power supply	
23	BEFORE THE FIRST USE	
24	WASHING PROCESS, STEP BY STEP (1-6)	STEPS OF THE WASHING PROCESS
24	Step 1: Heed the labels on the laundry	
25	Step 2: Preparing the washing process	
32	Step 3: Choosing washing programme	
34	Step 4: Selecting additional settings and functions	
41	Step 5: Starting a washing program	
42	Step 6: End of washing program	
43	INTERRUPTIONS AND CHANGING PROGRAM	
44	EMERGENCY DOOR OPENING	CLEANING AND MAINTENANCE
45	MAINTENANCE & CLEANING	
45	Cleaning detergent compartment	
46	Cleaning water hose, detergent dispenser housing, and rubber door gasket	
47	Cleaning pump filter	
48	Cleaning exterior	
49	TROUBLESHOOTING	TROUBLESHOOTING
49	What to do...?	
50	Error codes and troubleshooting	
51	RECOMMENDATIONS AND ECONOMIC USE	MISCELLANEOUS
52	Stain removal tips	
54	DISPOSAL	
55	TYPICAL CONSUMPTION TABLE	
56	Connecting your appliance to the application ConnectLife	

SAFETY PRECAUTIONS



Carefully read the instructions for use before using the washing machine.

Please, do not use the washing machine without reading and understanding these instructions or use first.

These instructions for use of a washing machine are supplied with different types or models of washing machine. Therefore, they may include descriptions of settings or equipment that are not available in your washing machine.

Failure to observe the instructions for use or inappropriate use of the washing machine may result in damage to the laundry or the appliance, or injury to the user. Keep the instruction manual handy, near the washing machine.

This appliance is intended to be used in household. If the washing machine is used for professional, for-profit purpose or purpose exceeding normal use in a household, or if the washing machine is used by a person who is not a consumer, the warranty period shall be equal to the shortest warranty period required by relevant legislation.

Follow the instructions for correct installation of the washing machine and connection to the water and power mains (see chapter »INSTALLATION AND CONNECTION«).

Connection to water and power supply has to be executed by an adequately trained technician or expert.

Any repair and maintenance pertaining to safety or performance should be done by trained experts.

To avoid danger, **a damaged power** cord may only be replaced by the manufacturer, a service technician, or an authorized person.

Before connecting the washing machine to the power mains, wait for at least 2 hours until it reaches room temperature.

This product must be serviced by an authorized Service Center, only use approved spare parts by authorized manufacturers.

Under no circumstances should you attempt to repair the appliance yourself. Repairs carried out by inexperienced persons may cause injury or more serious malfunctioning. Refer to your local Service Center, and always insist on genuine spare parts.

In case of incorrect washing machine connection, incorrect use, or servicing by an unauthorized person, the user shall bear the cost of any damage as such damage shall not be covered by warranty.

The washing machine may not be connected to the power mains using an extension cord.

Do not connect the washing machine to power mains using an external switching device such as a programme timer, or connect it to power mains that is regularly switched on and off by the power supply provider.

Do not connect the washing machine to an electrical outlet intended for an electric shaver or hair dryer.

The power socket has to be safely earthed, and the water supply should be unimpeded.

Do not install the washing machine in a room where the temperature can drop to below 5°C, as washing machine parts may be damaged in case of water freezing.

Place the washing machine on a level and stable solid (concrete) base.

If the washing machine is placed on an elevated stable base, the washing machine has to be additionally secured against tipping.

Before the first use of the washing machine, remove the transport screws, as switching on a blocked washing machine can result in serious damage (see chapter »INSTALLATION AND CONNECTION/Removing the transport screws/rods«). Warranty shall be void in cases of such damage.

To connect the washing machine to water supply, make sure to use the supplied water supply hose and gaskets. Water pressure has to be between 0.1-1 MPa (1-10 bar; 1-10 kp/cm²; 10-100 N/cm²).

Always use a new water supply hose to connect the washing machine to water supply; do not reuse an old water supply hose.

The end of the water discharge hose should reach into a water drain line.

Before the start of the washing cycle, press the door on the indicated spot until it locks into place. The door cannot be opened during washing machine operation.

After the washing cycle, close the water tap and pull out the washing machine plug from the power socket.

Only use agents for washing machine and care of laundry. We shall not be responsible for any damages or discolouration of gaskets and plastic parts resulting from incorrect use of bleaching or colouring agents.

When descaling, only use descaling agents with added anti-corrosion protection. (Only use non-corrosive descaling agents.) Follow the manufacturer's instructions. Finish the descaling process with several rinse cycles or by running the **Drum clean** (Self cleaning programme) in order to remove any residual acid (e.g. vinegar etc.).

 Do not use detergents that contain solvents as this could lead to release of poisonous gases, damage to the washing machine, and risk of fire and explosion.

The washing machine is not intended for use by persons (including children) with physical or mental impairments, or persons with lacking experience and knowledge. These persons should be instructed about the use of the washing machine by a person responsible for their safety.

The warranty does not cover consumables, minor deviations in colour, increased noise that results from appliance age and which does not affect the functionality of the appliance, and aesthetic defects on components, which do not affect the functionality and safety of the appliance.

CHILD SAFETY

Before closing the washing machine door and running the programme, make sure there is nothing except laundry in the drum (e.g. if a child climbed into the washing machine drum and closed the door from the inside).

Keep the detergent and conditioner out of reach of children.

Activate the child lock. See chapter »SELECTING ADDITIONAL SETTINGS AND FUNCTIONS/Child lock«.

Do not let children younger than three years come near the appliance, unless they are under constant supervision.

The washing machine is made in compliance with all relevant safety standards.

This washing machine may be used by children aged 8 years and above and by persons with reduced physical, sensory or mental capabilities or lack of experience and knowledge, but only if they are supervised during the use of the washing machine,

if they have been provided relevant instructions regarding safe use of the washing machine, and if they understand the hazards of inappropriate use. Make sure children do not play with the appliance.

Children may not clean the washing machine or perform any maintenance tasks without supervision.

DANGER OF HOT SURFACE

At higher washing temperatures, the door glass will heat up. Be careful to avoid burns. Make sure children do not play near the door glass.

WATER OVERFLOW PROTECTION (WITH WASHING MACHINE SWITCHED ON)

If the water level in the appliance rises above normal level, then the excess water level protection will be activated. It will shut off the water supply and start pumping out the water. The program is interrupted and an error is reported.

TRANSPORT/TRANSPORT AFTER INSTALLATION

If you intend to move the washing machine after it has been installed, then it should be blocked by inserting the transport screws (see chapter »INSTALLATION AND CONNECTION/ Moving and transport after installation«). Before inserting the transport screws, disconnect the washing machine from the power mains!

If the supply cord is damaged, it must be replaced by the manufacturer, its service agent or similarly qualified persons in order to avoid a hazard.

Water drained during a high-temperature wash or drying cycle is hot. Do not touch the water.

Do not open the washing machine door by force while it is operating (high-temperature washing/drying/spinning).

That the washing machine is not to be used if industrial chemicals have been used for cleaning;

That lint must not to be allowed to accumulate around the tumble dryer;

That adequate ventilation has to be provided to avoid the back flow of gases into the room from appliances burning other fuels, including open fires.

Items that have been soiled with substances such as cooking oil, acetone, alcohol, petrol, kerosene, spot removers, turpentine waxes and wax removers should be washed in hot water with an extra amount of detergent before being washed in the machine.

Items such as foam rubber (latex foam), shower caps, waterproof textiles, rubber backed articles and clothes or pillows fitted with foam rubber pads should not be washed in the machine.

Fabric softeners, or similar products, should be used as specified by the fabric softener instructions.

Remove all objects from pockets such as lighters and matches.

WARNING: The appliance must not be supplied through an external switching device, such as a timer, or connected to a circuit that is regularly switched on and off by a utility.

For appliances with ventilation openings in the base, a carpet must not obstruct the openings.

The appliance must not be installed behind a lockable door, a sliding door or a door with a hinge on the opposite side to that of the tumble dryer, in such a way that a full opening of the tumble dryer door is restricted.

Exhaust air must not be discharged into a flue that is used for exhausting fumes from appliances burning gas or other fuels.

WASHING MACHINE DESCRIPTION

FRONT

- 1 Control unit
- 2 Programme selector knob
- 3 Detergent compartment
- 4 Door
- 5 Rating plate
- 6 Pump filter cover

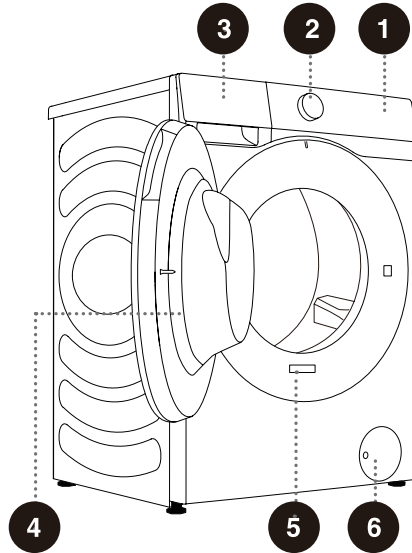

BACK

- 1 Water hose
- 2 Power cord
- 3 Drain hose
- 4 Adjustable feet
- 5 Transport screws/rods

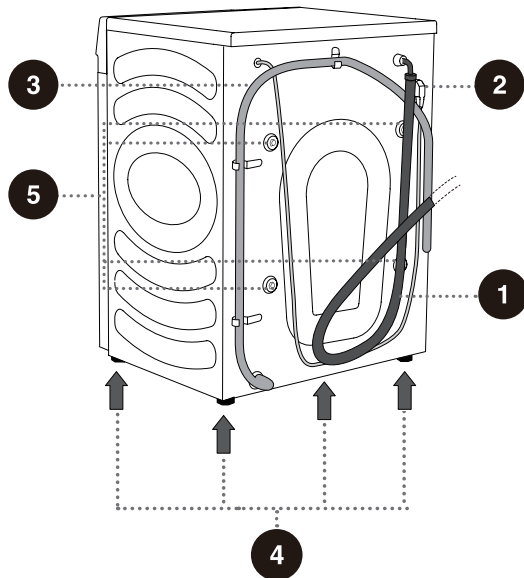

⚠ The illustrations in this manual are for reference purpose only. As our products are subject to continual improvement, the appearance, color and functional parts of your actual product may vary from the illustrations.

SPECIFICATIONS

(DEPENDING ON MODEL)

The rating plate is fitted on the front wall of the appliance door (see chapter "WASHING MACHINE DESCRIPTION").

Maximum load	12 kg
Weight	73 kg
Rated Voltage	220-240 V~
Rated power	1750 W
Frequency	50 Hz

Dimensions (mm)

Index	Dimension(mm)
A	595
B	845
C	610
D	640
E	670
F	1150

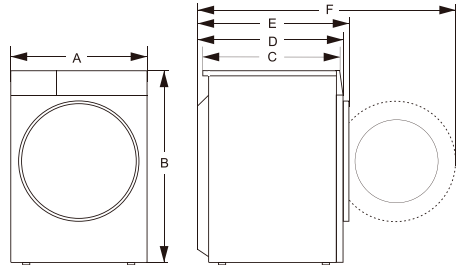

Rating plate

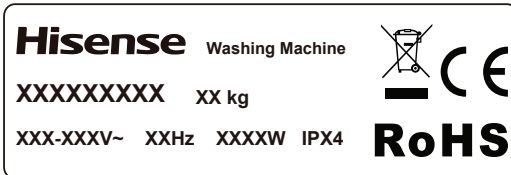

⚠ Before connecting the washing machine to the power mains, wait for at least 2 hours until it reaches room temperature.

INSTALLATION AND CONNECTION

⚠ Remove all packaging (see chapter »DISPOSAL«). When removing the packaging, make sure not to damage the appliance with a sharp object. Keep the packaging material (plastic bags, other plastic parts etc.) out of reach of children.

Check for any damage on the appliance. If you suspect the appliance is damaged, do not use it and immediately contact the After-sale Service.

The appliance is supplied with a support set that includes:

- Instructions for use;
- 4 plastic plugs;
- Supply hose;
- Drain hose holder;
- Wrench;
- Noise reduction board.

Make sure all parts listed above are supplied.

HOW TO INSTALL THE NOISE REDUCTION BOARD

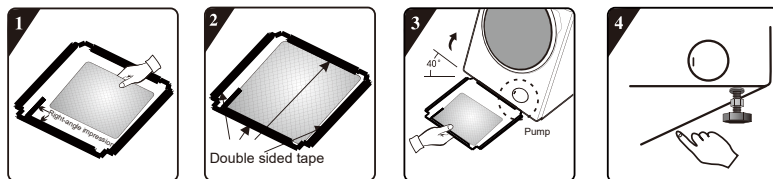

1. Before installing the noise reduction board, align and paste the acoustic absorption wool with and along the right-angle impression on noise reduction board (this procedure is unnecessary for some of the models without acoustic absorption wool).
2. Remove surface paper on double sided tape at four sides of the noise reduction board.
3. Incline the machine to an angle of 40° and let the side with right-angle notch face towards front of the washing machine, as shown in the figure. Insert the side with oblique-angle notch between two foot screws at back of the washing machine completely in place. Then, install the noise reduction board and ensure that it contacts with bottom of the washing machine closely.
4. Press the double sided tape on four sides manually to secure the noise reduction board to the machine body firmly.

REMOVING THE TRANSPORT SCREWS/RODS

⚠ Before the first use of the appliance, transport screws/rods must be removed. A blocked appliance may be damaged when it is switched on for the first time. Warranty shall be void in cases of such damage.

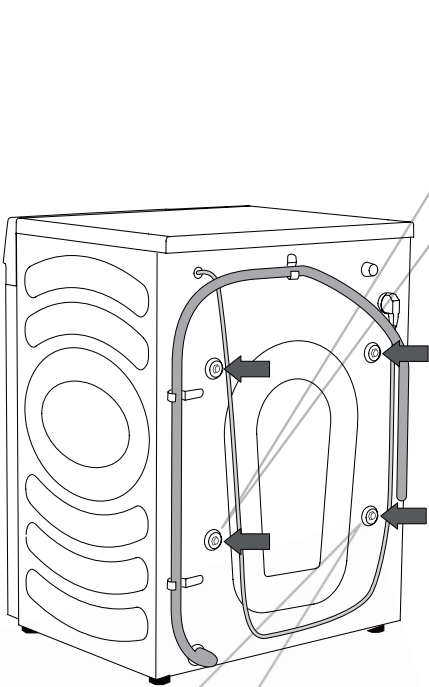

A power cord clip is provided here, which should also be removed.

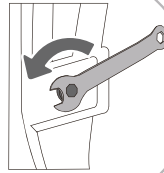

1 Move aside the hoses and use a fitting spanner to loosen the 4 screws on the back of the appliance by turning them counter clockwise, as indicated by the arrow. Loosen them by approximately 30 mm (not completely).

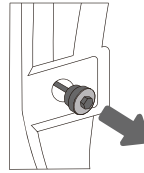

2 Pull all 4 shipping bolts/screws horizontally.

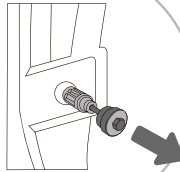

3 Pull out the shipping bolts/screws together with the rubber and the plastic part.

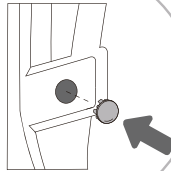
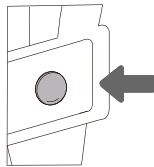

4 Cover the screw holes with the plastic caps. The plastic caps are supplied in the accessory bag (the support set) together with the instruction manual.

💡 Save the transport screws/rods in case you have to transport the appliance again later (to reinstall the blocking screws/rods, follow the above procedure in reverse order).

MOVING AND TRANSPORT AFTER INSTALLATION

⚠ If you wish to move the washing machine after it has been installed, the blocking screws/rods have to be re-installed to prevent vibration damage to the washing machine during transport (see chapter »INSTALLATION AND CONNECTION/Removing the transport screws/rods«). If you lost the blocking screws/rods, they can be ordered from the manufacturer.

⚠ After transport, the washing machine should be left to stand still for at least two hours before it is connected to the power mains, so that it can reach room temperature. The appliance should be installed and connected by a trained technician.

⚠ Carefully read the instructions for use before connecting the washing machine. Repair or any warranty claim resulting from incorrect connection or use of the washing machine shall not be covered by the warranty.

LOCATION

⚠ Floor on which the washing machine is placed must have a concrete base. It should be clean and dry; otherwise, the washing machine may slide. Also, clean the bottom surface of adjustable feet.

⚠ The washing machine must stand level and stable on a solid base.

ADJUSTING FEET

Use a spirit level and the supplied spanner.

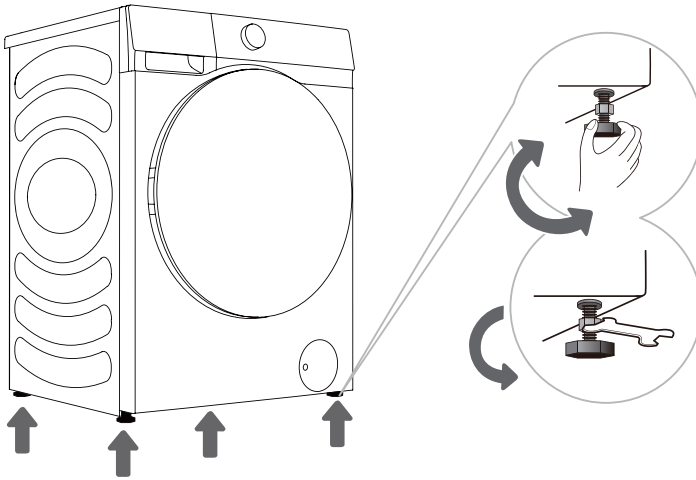

.....
1 Rotate the adjustable feet to level the washing machine. The feet allow levelling by +/- 2 cm.
.....

2 After adjusting the height of the feet, firmly tighten the jam nuts (counter nuts) by turning them towards the bottom of the washing machine using the supplied spanner ↑ (see figure).

⚠ Incorrect levelling of the washing machine with the adjustable legs may cause vibration, appliance sliding across the room, and loud operation. Incorrect levelling of the washing machine is not subject to warranty.

⚠ Sometimes, unusual or louder noise may appear during appliance operation; these are mostly the result of improper installation.

INSTALLATION CLEARANCES

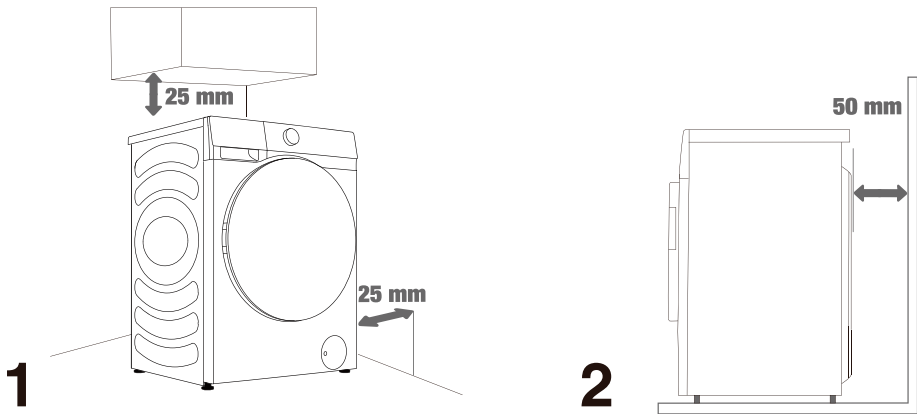

⚠ The washing machine may not be in contact with a wall or adjacent furniture. For optimum washing machine operation, we recommend observing the clearances from the walls as indicated in the figure.

In case of failure to observe the minimum required clearances, safe and correct washing machine operation cannot be ensured. Moreover, overheating can also occur (figures 1 and 2).

⚠ Installing the washing machine under a countertop is not recommended.

CONNECTING TO WATER SUPPLY

Attach the water inlet hose onto the water tap properly.

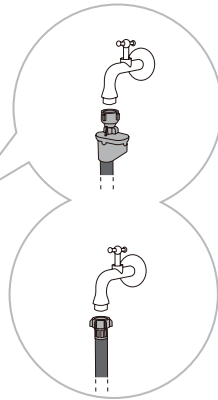
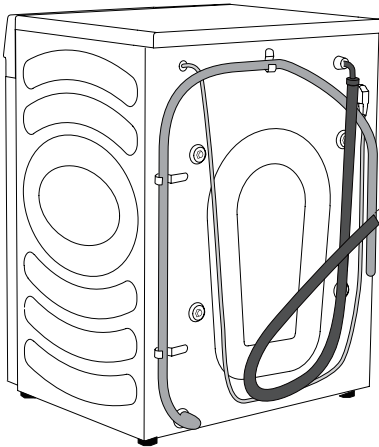

A AquaStop

B Regular Connection

💡 For normal washing machine operation, the pressure in the water mains should be between 0.1-1 MPa (1-10 bar; 1-10 kp/cm²; 10-100 N/cm²). Minimum dynamic water pressure can be determined by measuring the water flow. In 15 seconds, 3 litres of water should flow from a fully open tap.

💡 Tighten the water supply hose by hand, firmly enough for the hose to have a good seal (max. 2 Nm). After connecting the hose, the seal must be checked for any leaks. Do not use pliers or similar tools when connecting the hose as this could damage the nut thread.

💡 Only use the water supply hose supplied with the appliance. Do not use any used or other hoses.

💡 Make sure the hose is not damaged. If the hose is degraded, brittle, or cracked, it has to be replaced.

AquaStop (ONLY WITH SOME MODELS)

If an internal tube or hose is damaged, a shut-off system is activated that cuts the water supply to the washing machine. In such case, the control glass (a) will turn red. Replace the water supply hose.

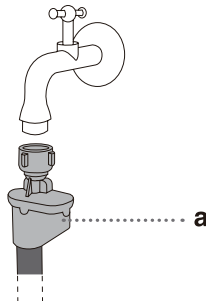

⚠ Do not dip the water supply hose with the Aqua stop system in water as it contains an electric valve.

⚠ The water supply hose can be connected without a non-return valve.

⚠ When connecting the water supply hose, make sure to connect it in a way that allows adequate and unobstructed water supply.

CONNECTING AND SECURING DRAIN HOSE

Feed the drain hose into a washbasin or a bathtub, or connect it directly to a drain (minimum drain hose diameter 4 cm). The vertical distance from the floor to the end of the drain hose should be 60-100 cm. It can be attached in three ways (A, B, C).

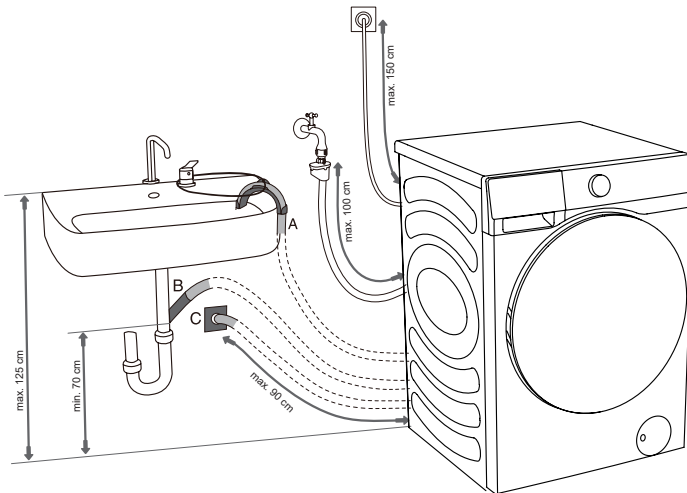

A The drain hose end may be placed over a sink or a bathtub. Use a tie strap to secure the hose through the elbow support to prevent it from slipping.

B The drain hose may also be attached directly to the sink drain. Do not use a small sink. Pay attention that the drained water may be hot.

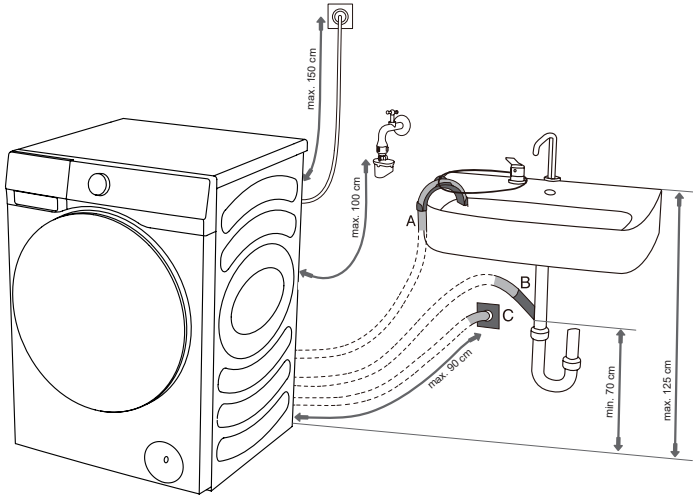

C Drain hose can also be attached to a wall drain with a water trap, which should be properly installed to allow cleaning.

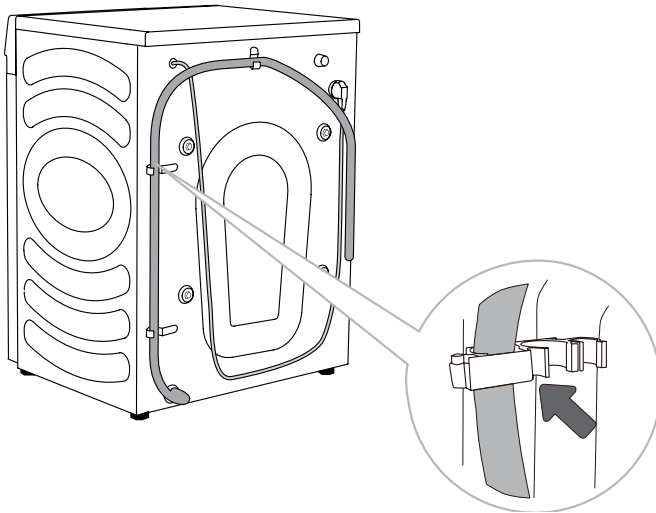

D The drain hose must be attached to the hooks on the back of the washing machine, as shown in the figure.

⚠ Make sure the drain hose is not damaged.

⚠ If the discharge hose is not correctly attached, safe and correct washing machine operation cannot be ensured.

CONNECTING POWER SUPPLY

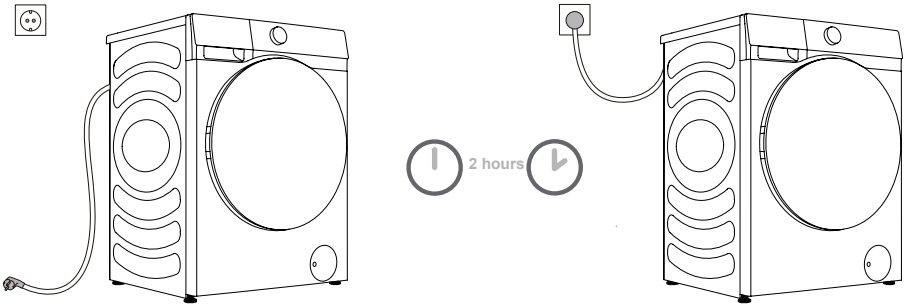

⚠ Before connecting the washing machine to the power mains, wait for at least 2 hours until it reaches room temperature.

Connect the washing machine to a grounded power outlet which should be freely accessible after installation. The outlet should be fitted with an earth contact (in compliance with the relevant regulations). Refer to the rating plate for basic information of your washing machine.

⚠ We recommend using over-voltage protection to protect the appliance in case of a lightning strike.

⚠ The washing machine may not be connected to the power mains using an extension cord.

⚡ Do not connect the washing machine to an electrical outlet intended for an electric shaver or hair dryer.

⚡ Do not plug or unplug the appliance when your hands are wet.

⚡ Any repair and maintenance pertaining to safety or performance should be done by trained experts.

⚡ A damaged power cord may only be replaced by a person authorized by the manufacturer.

BEFORE THE FIRST USE

Make sure the washing machine is disconnected from the power supply and then open the door towards you (figures 1 and 2).

Clean the drum using a soft and moist cloth. You can also use the "Drum Clean" program. In such case, connect the appliance to the power supply and open the water tap. The drum should be empty (Figures 3 and 4).

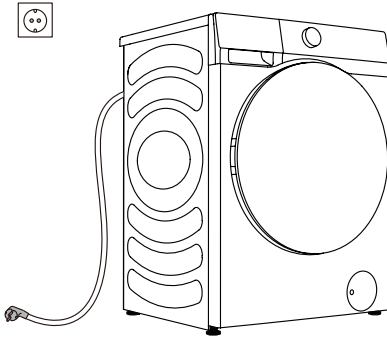

1

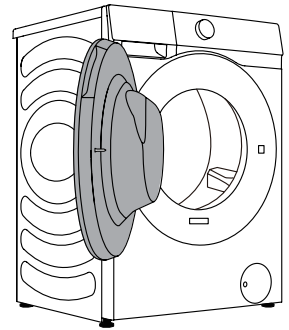

2

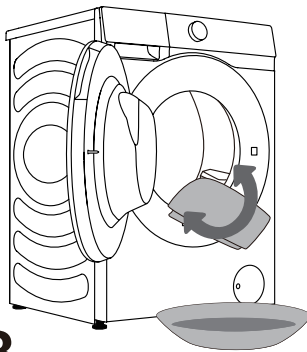

3

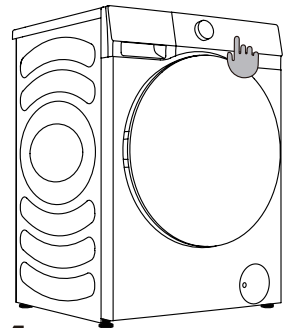

























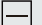

4

⚠ Do not use any solvents or cleaning agents that could damage the washing machine (please observe the recommendations and warnings provided by the cleaning agent manufacturers).

WASHING PROCESS, STEP BY STEP (1-6)

STEP 1: HEED THE LABELS ON THE LAUNDRY

Normal wash; Sensitive laundry	Max. washing temp. 95°C  	Max. washing temp. 60°C  	Max. washing temp. 40°C  	Max. washing temp. 30°C  	Hand wash only 	Do not wash 
Bleaching	Bleaching in cool water 			Bleaching not allowed 		
Dry cleaning	Dry cleaning with all agents 	Petroleum solvent R11, R113 	Dry cleaning in kerosene, pure alcohol, and R113 	Dry cleaning not allowed 		
Ironing	Hot ironing, max. 200°C 	Hot ironing, max. 150°C 	Hot ironing, max. 110°C 	Ironing not allowed 		
Drying	Dry flat (place on a flat surface) 	Drip dry  Line dry 	High temperature  Low temperature 	Do not tumble dry 		

STEP 2: PREPARING THE WASHING PROCESS

1. Sort the laundry by type of fabric, colour, soiling, allowed washing temperature, etc. (see PROGRAMME TABLE).
2. Close the buttons and zippers, tie any ribbons, and turn the pockets inside out; remove any metal clips that could damage the laundry and appliance interior, or clog the drain.
3. Place sensitive laundry and small items in a mesh laundry bag.

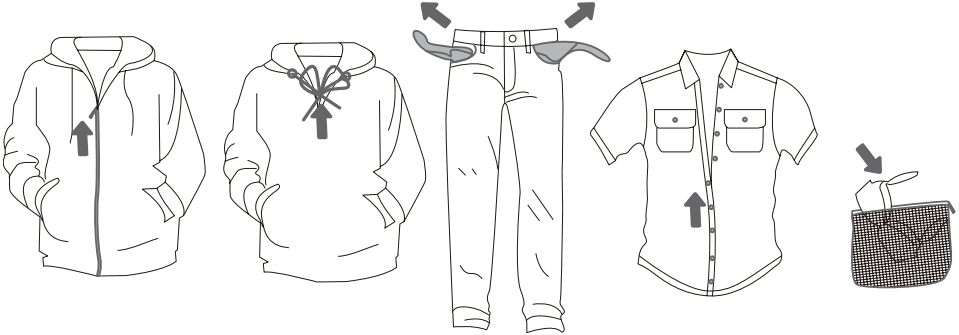

INSTRUCTIONS FOR AUTO DOSING FUNCTION

This product has an auto dosing feature to automatically add the right amount of detergent/softener to a wash. You can adjust the amount automatically dispensed by selecting little medium or large depending upon the strength of the washing needed. When the "Auto" option is selected, the washing machine will intelligently judge the amount of detergent and softener according to the weight of the laundry. You can cancel the auto dosing function in the Settings menu and add detergent and softener manually during washing.

► ADDING DETERGENT/SOFTENER

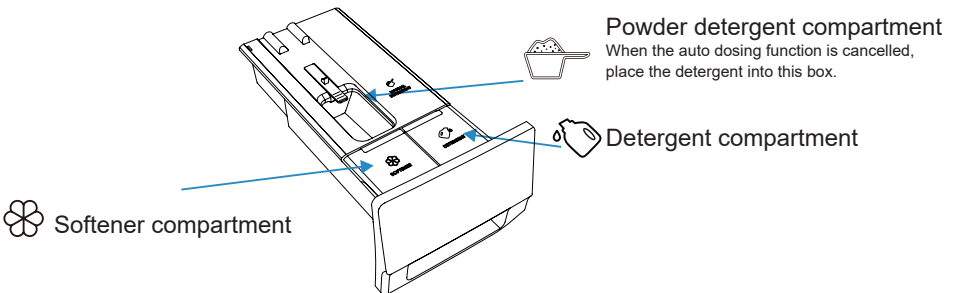

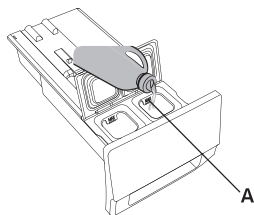

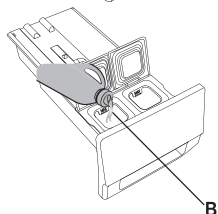

1. Open the detergent drawer.
2. Add detergent to the auto-dosing detergent dispenser (A).



3. If necessary, add softener to the auto-dosing softener dispenser (B).
4. Close the auto dosing drawer.

► AUTO DOSING STEPS

- When the washing machine is used for the first time, the auto dosing function of both the detergent and softener is switched on by default. The washing machine will remember the last option before shut-down.
- To disable this function, click in the Settings interface to deselect Detergent and Softener.
- If the detergent/softener dispenser is insufficient, the icon  /  will be shown in red, and the screen will display a reminder asking user to add detergent/softener in time. The maximum storage volume of detergent is 1 L, and that of softener is 0.5 L. Do not add detergent/softener above the maximum scale mark.

► PRECAUTIONS

1. Please always use high-efficiency and low-foam detergent suitable for drum washing machines. Do not use caked detergent powder.
2. When using the Auto Dosing function, do not further manually add any detergent.
3. Please do not overfill the detergent/softener reservoirs as they may overflow.
After filling, please ensure that the detergent drawer is fully closed before starting the washing program.
4. Please remove or secure the detergent drawer before installing, moving, handling, and adjusting the washing machine. This is to avoid the inconvenience caused by an overflow of the detergent and softener.
5. Disincrustants could damage the machine. Do not use solvents. Do not wash clothes having been cleaned with solvents or flammable substances.
6. If Manual Dosing is needed, you can disable the Auto Dosing function, and add detergent manually;
 - 6.1 The detergent dosage depends on the type of clothes, degree of fouling, color of clothes and washing temperature. Please add detergent appropriately.
 - 6.2 Excessive detergent could result in foaming, further affecting the washing effect. If the machine detects excessive foam, it may pause to defoam.
 - 6.3 If insufficient detergent is used, it is possible that the washed clothes are not clean.
 - 6.4 When manually adding detergent powder, you are suggested to add it just the moment before the start of the washing program. If you add detergent powder in advance, please ensure that the detergent box in the detergent doser tray is dry; otherwise, the detergent powder could become hardened before the start of the washing program.
7. Please keep the detergent and softener out of reach of children.
8. For more information about dosing, please see "Recommendations and economic use".

POWER ON THE WASHING MACHINE

Use the power cord to connect the washing machine to power supply, and connect the washing machine to water supply. Turn the appliance on by press the button "POWER" (figures 1 and 2).

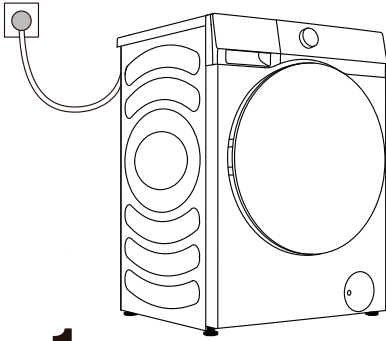

1

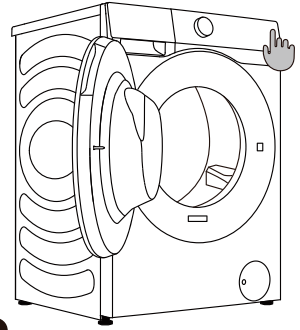

2

CONFIGURATION BEFORE FIRST USE:

Before first use, configure the preferences of Language, Time Zone, User License and Network according to the boot navigation and user's actual needs. (The energy efficiency requirement varies with the country and region. If the country/region selected is inconsistent with reality, the energy efficiency grade and data will be different.)

1. Configure the language

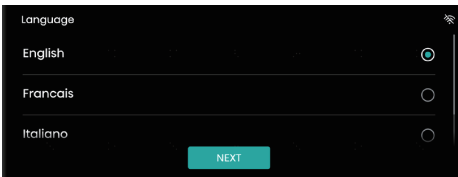

2. Select the time zone

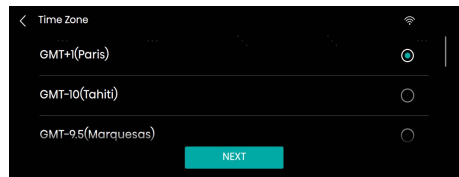
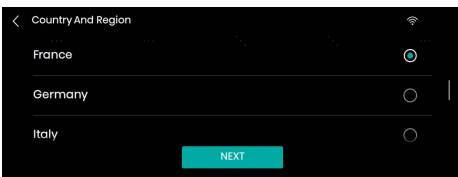

3. User Licence

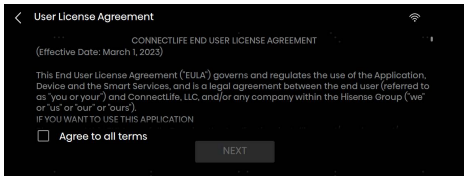

4. WLAN

If the network is connected, it moves to step 5 and 6;
If network setting is skipped, it moves to step 7.

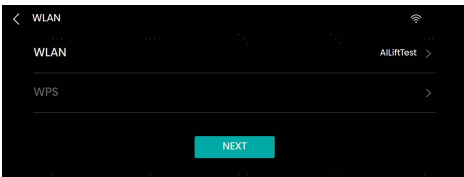

5. App and Pairing

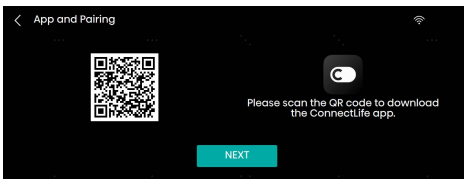

6. Remote Control

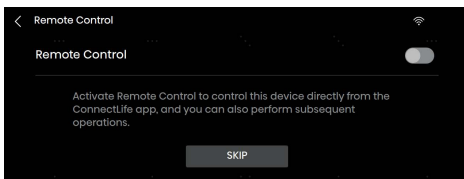

7. Set system date and time

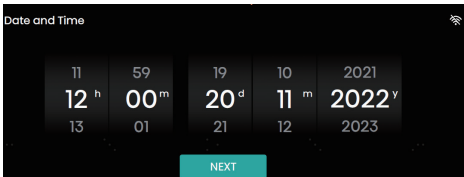

CONTROL PANEL

This machine is controlled by touch + knob. Programs can be selected by touching the screen or turning the knob. The Power and Start/Pause buttons can be operated by touch. Touch the highlighted area to enter the program parameter setting.

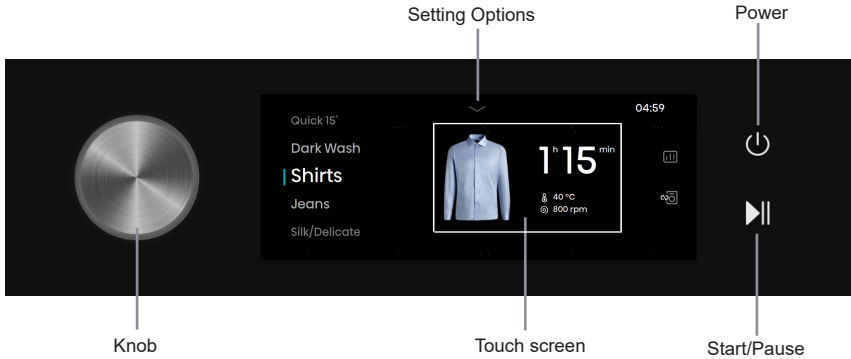

Icon	Name	Description
	Power button	For powering on/off the washing machine.
	Start/Pause button	For starting/suspending a program.
	Back	Go back to the previous interface.
	Settings	Enter Setting Options to set WLAN, Drum Light, Mute, Settings, etc.
	WLAN	WLAN icon of the washing machine.
	Child Lock icon	After a program is started, all operations except the Power button will be locked if the child lock is turned on.
	Wash & Dry icon	For combined control of the washing machine and the dryer in the same home network.
	Intelligent Report	Touch this icon to show the local weather, total power consumption and other data.
	Favorites icon	Touch this icon to add the current program to your favorites.
	Delay end icon	Touch this icon to activate Delay end function and enter Delay end setting screen.

POWER

For powering on/off the washing machine.

When the washing machine is in standby, or after the screen displays the program end interface, press and hold the Power key for 3s to enter the power-off state.

In standby mode, or in the program end interface or Wash & Dry retry reminder interface, if no operation is performed within 10min, the washing machine will shut down automatically.

In power-off state, all displays and outputs will be off, and remote startup is not supported.

START/PAUSE

For starting a program, or suspending a running program.

After a program is started, or when the pause state is selected, the set functions and parameters cannot be changed. To change a setting, press the Back button to go back and end the current program; or press and hold the Power button for 3s to turn off the machine, and then restart it to reset the parameter.

When the program is suspended in spin state and then restarted, it will run again from the initial state of spin.

LOADING THE WASHING PROCESS

Open the drum door by pulling the handle towards you (figure 1).

Place the laundry into the drum (after making sure the drum is empty) (figure 2).

Close the door (figure 3). The door is locked when you here a click.

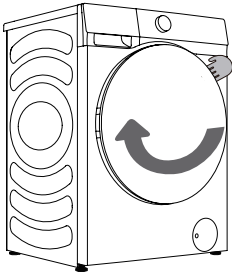

1

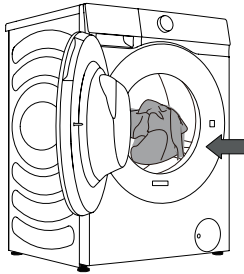

2

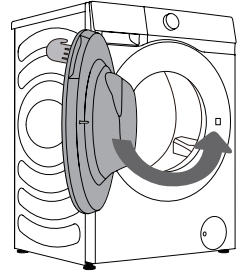

3

⚠ Never try to forcefully open the door. Moreover, do not open the door during washing machine operation.

Do not overload the drum! See PROGRAMME TABLE and observe your nominal load as indicated on the rating plate.

If the washing machine drum is too full, the laundry will not be washed as thoroughly.

STEP 3: CHOOSING WASHING PROGRAMME

After turning on the machine by touching the Power button, turn the knob or touch the program zone on the screen to select a proper program according to the type and degree of fouling of clothes. See PROGRAMME TABLE.

Programme	Max. load (kg)	Maximum Speed (rpm)	Description of Program
Eco40-60	12	1400	Normally soiled cotton laundry.
Cotton (Cold, 20°C, 30°C, 40°C, 60°C, 90°C)	12	1400	Suitable for cotton or linen fabrics with moderate/severe degree of fouling. For clothes with a severe degree of fouling, please select the "Prewash" function.
Synthetics (Cold, 20°C, 30°C, 40°C, 60°C)	6	1400	Suitable for synthetic fabrics and cotton fabrics with a moderate degree of fouling.
Mix (Cold, 20°C, 30°C, 40°C)	6	1400	Suitable for mixed cotton fabrics and chemical fiber fabrics with a mild degree of fouling.
Daily wash (Cold, 20°C, 30°C, 40°C)	6	1400	Suitable for wash-fast and unfadable clothes.
Baby Care (40°C, 60°C, 90°C)	2	1400	Suitable for baby clothes and underwear which will be disinfected and sterilized under high-temperature steam.
Allergy Care (40°C, 60°C)	2	1400	For continuous and effective sterilization.
Drum Clean (90°C)	/	800	Suitable for cleaning the drum, and removing residual detergent and bacteria accumulating and breeding during low-temperature washing.
Spin	12	1400	For separate spinning of clothes.
Rinse+Spin	12	1400	For separate rinsing and spinning of clothes.
Power Speed 39' (Cold, 20°C, 30°C, 40°C)	4	1200	Suitable for washing a few clothes with heavy dirt; intensive washing will be performed within a short period of time.
Quick 15' (Cold, 20°C, 30°C, 40°C)	1	800	For washing clothes with a little or mild dirt.
Dark wash (Cold, 20°C, 30°C, 40°C, 60°C)	4	1000	Suitable for machine washable clothes of dark colors.

Programme	Max. load (kg)	Maximum Speed (rpm)	Description of Program
Shirts (Cold, 20°C, 30°C, 40°C, 60°C)	2	800	Suitable for washing shirts.
Jeans (Cold, 20°C, 30°C, 40°C, 60°C)	6	1400	Suitable for washing jeans.
Silk/Delicate (Cold, 20°C, 30°C, 40°C)	2	600	Suitable for washing soft and delicate fabrics and machine-washable silk. (See the care label on the clothes).
Wool (Cold, 20°C, 30°C, 40°C)	2	600	Machine-washable wool products can be washed according to the care instructions on the care label.
Sportswear (Cold, 20°C, 30°C, 40°C)	4	1000	Suitable for washing sportswear.
Bedding (Cold, 20°C, 30°C, 40°C, 60°C)	3	1400	Suitable for washing large items such as bed sheets and quilt covers.
AI Super Wash	8	/	Smartly identifying the weight and degree of fouling of clothes, suitable for washing cotton and linen, and chemical fiber clothes.

NOTE:

- 1) Water Temperature: Select the appropriate water temperature for chosen wash programme. Always follow garment manufacturer's care label or instructions when washing to avoid damage to clothes.
- 2) Actual water temperature may differ from the declared cycle temperature.
- 3) The washing effect depend on water pressure, water hardness, water inlet temperature, room temperature, type and amount of load, degree of soiling utilized detergent, fluctuations in the main electricity supply and chosen additional options.
- 4) Neutral (non sudsing) detergent is recommended.
- 5) Dry powder detergent should be mixed with warm water before use.
- 6) Drum Clean: Before using the Drum Clean program, the drum must be emptied. You can add some white vinegar (about 2 dL) or baking soda (1 tbsp. or 15 g). Run this program at least once a month.
- 7) AI Super Wash: When identifying the weight and degree of fouling of clothes, the screen displays AUTO; after identification, the screen displays the washing time.

STEP 4: SELECTING ADDITIONAL SETTINGS AND FUNCTIONS

User may set the laundry parameters and add additional functions as per need (before pressing the **Start/Pause** button).

⚙️ Before starting a program, touch the parameters or functions to be set, and turn ON/OFF the corresponding settings. A parameter/function is ON if the corresponding icon lights up.

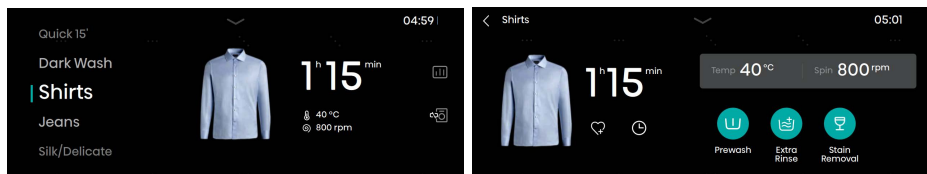

Touch the selected program time to change the Temp and Spin settings, and to set additional functions such as Prewash, Extra Rinse, Steam, Quicker, UV, Anti Crease, Intensive, Quiet Mode and Stain Removal. More additional functions can be displayed by sliding left and right. Additional functions that can be selected vary with the program.

Temp.

For adjusting the heating temperature during washing.

1. Tap the Temp option to enter the Temp selection interface.
2. Swipe on the screen to select the desired washing temperature among Cold-20°C-30°C-40°C-60°C-90°C.

Each program has a maximum set temperature, which should not be exceeded when selecting the temperature.

3. After selection, tap the "OK" button for confirmation, or tap the "CANCEL" button to abandon the selection.

Spin

For adjusting the maximum spin speed.

1. Tap the Spin option to enter the Spin selection interface.
2. Swipe on the screen to select the desired spin speed among: No Spin-400-600-800-1000-1200-1400. When "No Spin" is selected, the washing machine will only drain the water without spinning.
3. After selection, tap the "OK" button for confirmation, or tap the "CANCEL" button to abandon the selection.

Prewash

Add a prewash process which will last for a while before the Main Wash phase. Generally, it is used for dirty clothes.

When Auto Dosing is turned on and Prewash is selected, the detergent dosage in the Prewash phase is half of that in the Main Wash phase. The detergent dosage in the Prewash phase will not affect that in the Main Wash phase.

Extra Rinse

It is used to add the rinse times.

This function can be selected when the machine is in standby and cannot be changed after start.

Steam

Add the steam wash function during washing.

Quicker

1. This function is used to reduce the washing time of the program, and quicken the washing process. After pressing this button, the program time will be reduced. After pressing this button again, the program time will be increased to the initial state;
2. This function can be set only before the start of the appropriate program, and cannot be selected after the program runs;
3. For programs with the auto weighing function, auto weighing will be canceled after selecting this function and restored after deselecting this function.

UV

The UV function can be selected when the machine is in standby. The UV lamp stays on throughout the running process except in Reserve, Anti crease, Pause and Alarm states when the UV lamp is off.

Anti crease

1. When this function is selected, the machine will enter Anti crease mode upon completion of the spin program to prevent crease of clothes caused by a long-time stay in the drum;
2. Anti crease cannot be set when Spin is set to "No Spin" or when Drum Clean is selected;
3. User can turn the knob, tap the Start/Pause button, or short press the Power button to end the Anti crease mode and enter the End interface. If no operation is performed, the program will end automatically after the default maximum duration of 12 h.

Intensive

This function can be used to increase the intensive wash time and enhance the wash intensity.

Quiet Mode

This function can be used to lower the spin speed, wash the clothes gently, and reduce the noise.

Stain Removal

1. This function is for washing clothes with special stains. Different stain types can be selected after entering this interface. After selecting a stain type, tap the "OK" button for confirmation, or tap the "CANCEL" button to abandon the selection.
2. If the program is changed, the previously selected stain type will be canceled automatically.

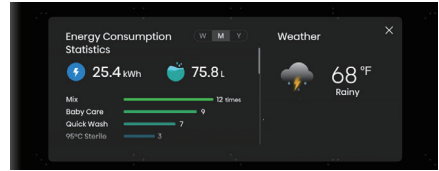

Intelligent Laundry Report

When network is connected, touch this icon to enter the Intelligent Laundry Report interface, where information such as energy consumption and weather is displayed.

Favorites

Touch this icon to add the current program to your favorites. The added program will appear at the top of the program list so that it can be selected with priority during next use.

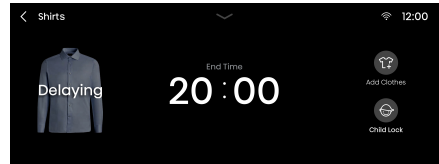
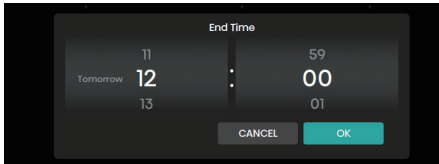

Delay end

1. The reserved time is the end time, which can be set when the machine is in standby;
2. After reservation, if user switches the program or sets parameters or functions, the reservation will be canceled automatically;
3. When the reservation is in progress, the screen will display "Delaying" and the End Time; after the washing program starts, the remaining time will be displayed;
4. The reserved time must be longer than the program running time, and the maximum time should not exceed 24h.

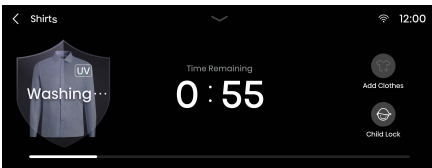

Add Clothes

For adding clothes during washing.

If the condition for opening the door during washing is satisfied, touch Add Clothes, and open the door to add clothes. After adding clothes, close the door, and touch "Start/Pause" to continue running.

Child Lock

This machine is designed with the Child Lock function in order to prevent misoperation and keep children safe. Touch the Child Lock icon to enable the Child Lock function; all buttons except the Power button will be locked. Touch the Child Lock for 3s to unlock.

When the program is completed, the Child Lock function will be disabled automatically.

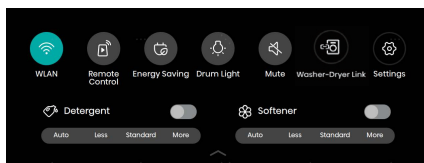
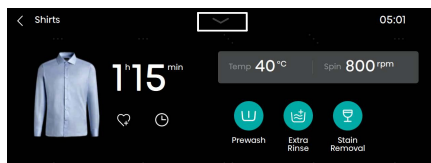

Setting Options:

After touching the Settings icon, a drop-down list of setting options will appear, for setting WLAN, Remote Control, Energy Saving, Drum Light, Mute, Washer-Dryer Link, Settings, Detergent and Softener.

Detergent/Softener

If Detergent/Softener is selected, it indicates the Auto Dosing function is enabled.

For the amount of detergent or softener to be dispensed, there are four levels for selection: Auto, Less, Standard, and More.

If neither Detergent nor Softener is selected, it indicates the Auto Dosing function is disabled. During use, user needs to dispense detergent or softener manually.

When detergent or softener is insufficient, the screen will display a prompt indicating a lack of detergent or softener to remind user of adding it in time.

WLAN

This function can be used to turn on/off WLAN. After the washing machine is successfully connected to WLAN, it can be controlled via the app on your mobile phone.

Remote Control

This function can be used to remotely control the machine via the app.

Energy Saving

This function can be used to set the time for the screen to enter the Energy Saving mode, and the duration during which the drum light stays on.

Drum Light

This function can be used to manually turn on/off the Drum Light.

When the machine is in standby, when a program is suspended, or when laundry is ended, the drum light will turn on automatically.

Mute

This option can be used to turn on/off the prompt tone of the machine. When it is turned off, all sounds of the machine except the alarm tone will be disabled.

Washer-Dryer Link

This function can realize intelligent interconnection between the washing machine and the dryer. Prior to use, both the washing machine and the dryer should be connected to the same WLAN as the app.

1. In the Program Select main interface, Settings interface, or System Settings interface, you can touch the Washer-Dryer Link icon to enter the Wash & Dry setting interface;
2. If the dryer has not been paired, touch this icon to enter device scanning, and select "Automatically scan the dryer" as prompted on the screen;
3. If the dryer has been paired with, touch this icon to enter the Machine List, and select the dryer to be paired with;
4. After successful pairing, the Wash & Dry function will be enabled; the dryer will automatically match the corresponding program and starts preheating to raise the temperature in the drum 15min before the end of laundry in the washing machine. When spinning is finished in the washing machine, directly transfer the spun clothes to the dryer drum. Touch the Start/Pause button to start drying in the dryer, which is time-saving and efficient.
5. Within 20min before the end of the program on the washing machine, please keep the dryer in power-on, network-connected and door-closed state to ensure normal linkage;
6. Preheating will be canceled if you open the door, short press the Power button, press the Start/Pause button or turn the knob when the dryer is preheating.
7. After the Wash & Dry Link function is enabled, the dryer can also change the drying program and function as per need.
8. The Wash & Dry Link function applies to partial programs.

Settings

This function allows you to enter the System Settings interface, where you can set General, System Volume, Screen Brightness, WLAN, Water Hardness, Standard Dosage Amount, Drum Clean Reminder, Energy Saving, User Program, APP and Pairing, Washer-Dryer Link, and System.

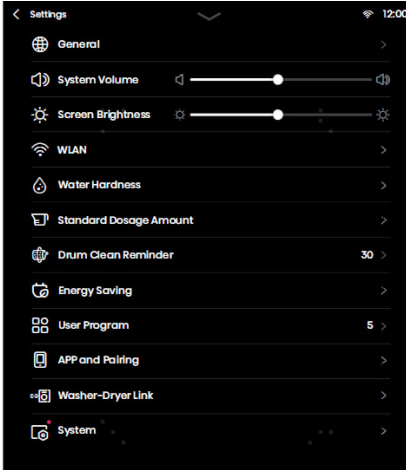

Name	Function Description
General	Set the language, date and temperature unit.
System Volume	Set the system volume.
Screen Brightness	Set the screen brightness.
WLAN	Configure network connection.
Water Hardness	Test the water hardness.
Standard Dosage Amount	The standard detergent/softener dosage amount.
Drum Clean Reminder	Set the drum clean reminder cycle.
Energy Saving	Turn on Energy Saving.
User Program	Users can set the number of programs shown on the home page.
APP and Pairing	View the QR code for App downloading and binding.
Washer-Dryer Link	Set Washer-Dryer Link, corresponding to Washer-Dryer Link under the drop-down settings.
System	Turn on system upgrade and restore factory settings.

FUNCTION TABLE

Programs	Steam	Prewash	UV Sterilization	Quiet Mode	Stain Removed	Intensive	Anti Crease	Quicker	Extra Rinse
Eco40-60	-	-	●	-	-	-	●	-	-
Cotton	●	●	●	●	●	●	●	●	●
Synthetics	●	●	●	●	●	●	●	●	●
Mix	-	●	●	-	●	●	●	●	●
Daily wash	-	●	●	-	-	-	●	-	●
Baby Care	●	●	●	-	-	●	●	●	●
Allergy Care	●	●	●	-	-	●	●	-	●
Drum Clean	-	-	-	-	-	-	-	-	-
Spin	-	-	-	-	-	-	●	-	-
Rinse+Spin	-	-	-	-	-	-	●	-	●
Power Speed 39'	-	●	●	-	-	-	●	●	●
Quick 15'	-	-	●	-	-	-	●	-	●
Dark wash	-	●	●	●	-	●	●	-	●
Shirts	●	●	●	-	-	-	●	-	●
Jeans	-	●	●	-	-	●	●	-	●
Silk/ Delicate	-	-	●	-	-	-	●	-	●
Wool	-	-	●	-	-	-	●	-	●
Sportswear	-	●	●	-	-	●	●	-	●
Bedding	-	●	●	-	-	●	●	-	●
AI Super Wash	-	-	-	-	-	-	-	-	-

Note: "-" indicates this function is not optional; "●" indicates this function is optional or available.

STEP 5: STARTING A WASHING PROGRAM

After selecting a program and its function parameters, touch the **Start/Pause** button to start washing.

1. Washing Process

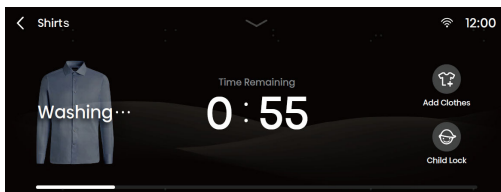

2. Rinsing process

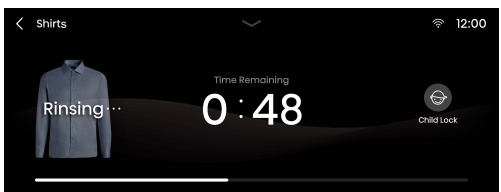

3. Spinning Process

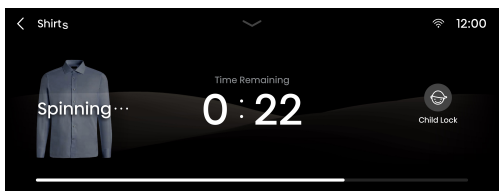

STEP 6: END OF WASHING PROGRAM

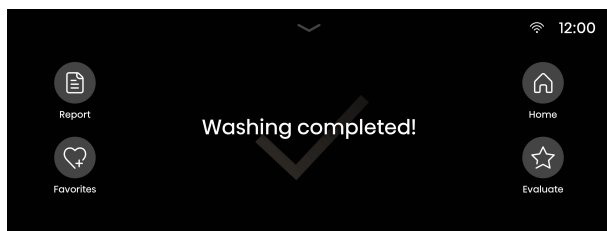

At the end of the program, the washing machine produces a prompt tone; the screen displays the end interface, and you can press the Power button to turn off the machine. If no operation is performed within 10min, the washing machine will shut down automatically.

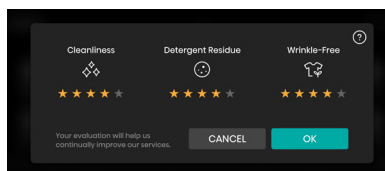
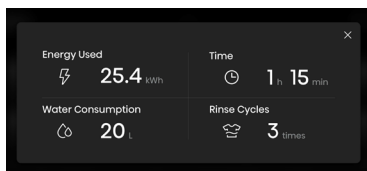

Report

Click it to view the Energy Used, Water Consumption, Time and Rinse Cycles of this laundry.

Favorites

Click it to add the program and settings of function parameters of this laundry to your favorites. The added program will appear at the top of the program list so that it can be selected with priority during next use.

Home

Go back to the home page of the program.

Evaluate

User can evaluate the star level of this laundry to help us in continuous improvement.

INTERRUPTIONS AND CHANGING PROGRAM

ADDING/REMOVING LAUNDRY DURING OPERATION

The appliance door can be opened if the water level and water temperature are below a predefined threshold.

The door will be unlocked automatically if all the following conditions are met:

- Water temperature in the drum must be suitable.
- Water level in the drum must be below a certain value.

In order to add or remove laundry from the appliance during a washing program, proceed as follows:

1. Press the Add Clothes button to suspend the laundry program.
2. If all conditions for unlocking the machine door are satisfied, the door will be unlocked. Open the machine door to add or reduce clothes in the drum.
3. Close the appliance door!
4. Press the **START/PAUSE** button.

⚠ If you add a considerable amount of laundry during the wash, the laundry could be washed less effectively, since the washing machine initially sensed a lower weight of the load of laundry and added a smaller amount of water. Insufficient amount of water relative to the amount of laundry could also cause damage to the laundry (rubbing of dry laundry), and washing time can be longer.

⚠ Washing time will resume from the point at which the washing programme was interrupted.

Manual Interruption of Program

To stop and cancel the washing program,

- Touch the Back button (<) at the upper left corner of the screen;
- Long press the "Power" button for 3s to power off the machine;

Change of Program

To change the program during the laundry, first manually interrupt the current program by the above method, and reselect a program.

ERRORS

If the machine malfunctions, the program will be interrupted.

In such case, the machine will produce a prompt tone to alert you, and the screen will display a fault message.

In the case of partial abnormality alarms, click the Start/Pause button to cancel the alarms and return to the running state. It cannot be switched to the running state in the case of partial abnormality alarms.

POWER FAILURE

In case of a power failure (power outage), the washing program is interrupted. When the power supply is restored, the program is resumed from the point where it was interrupted.

⚠ If there is still water in the washing machine after a power outage, make sure not to open the door before you manually drain the water from the washing machine via the pump filter.

EMERGENCY DOOR OPENING

If the machine door cannot be opened for special reasons such as power failure, please use the lock rod at the drain pump door for emergency opening.

Note:

1. Do not use it when the appliance is working normally.
2. Before operation, make sure that the inner barrel has stopped turning, and that the water is not hot and the water level is lower than the clothing inlet. If the water level is high, drain the water through the drain-away pipe (if available) or by slowly unscrewing the pump filter.
3. Operation method: Open the cover of drainage pump door, pull down the lock lever with the help of a tool, and then the door can be opened (indicated in the figure).

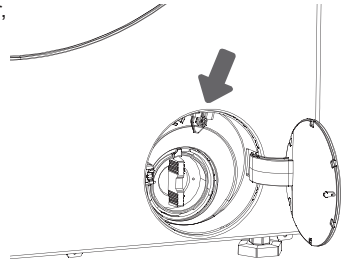

MAINTENANCE & CLEANING

 **Before cleaning, unplug the washing machine from the power mains.**

 Children should not clean the washing machine or perform maintenance tasks without proper supervision!

CLEANING DETERGENT COMPARTMENT

 Clean the detergent compartment regularly.

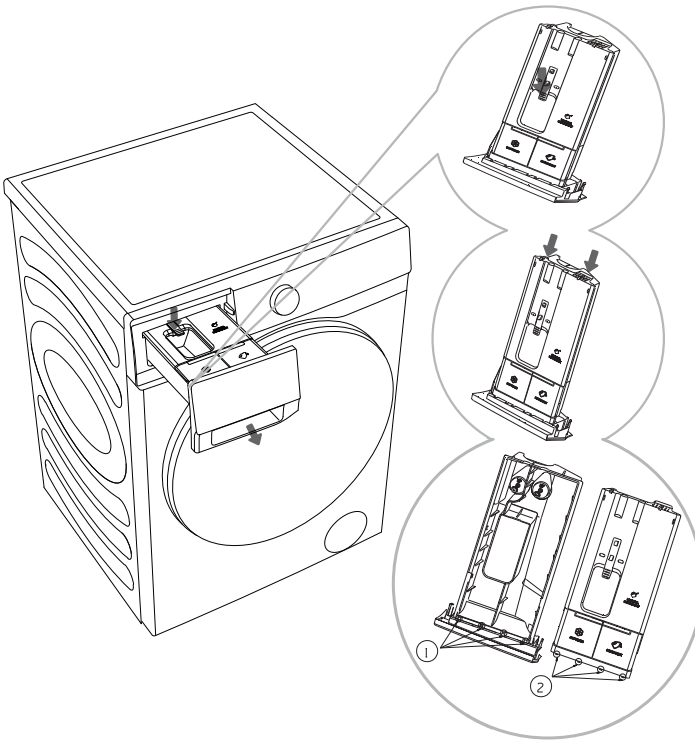

.....
1. Open the detergent compartment, press the limit lever as shown in the figure, and pull out the detergent compartment;

.....
2. Open the two limit ribs in the position shown in the figure, pull up and remove the lid;

.....
3. Empty the remaining detergent and softener in the dispenser box, clean the dispenser and lid with running water, and wipe dry with a cloth;

.....
4. Insert the limit ribs ② of the lid into the corresponding slots ① as shown, and press down the lid until you hear a "click" sound, indicating the flange ribs at the end of the lid snaps into place. Put the detergent compartment back in place.

 Do not wash the detergent compartment in a dishwasher.

CLEANING WATER HOSE, DETERGENT DISPENSER HOUSING, AND RUBBER DOOR GASKET

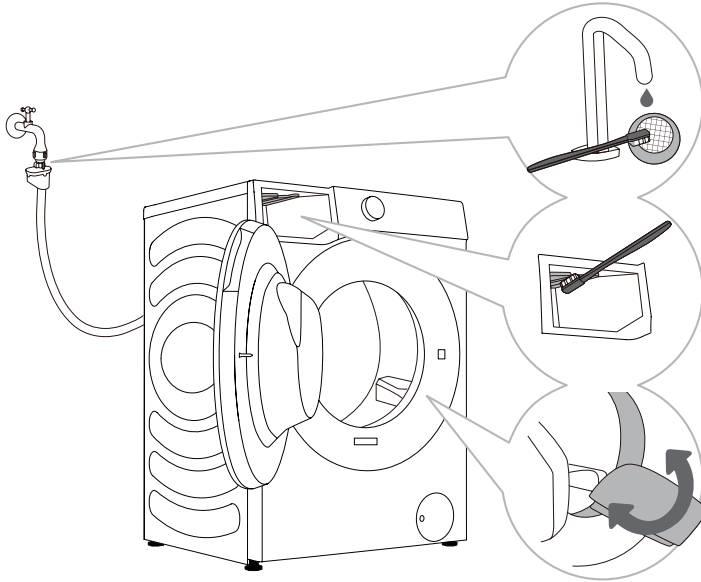

.....
1 Clean the mesh filter regularly under running water.
.....

2 Use a brush to clean the rinsing section, especially the nozzles on the upper side of the rinsing chamber.
.....

3 After every wash, wipe the rubber door seal to extend its use life.

CLEANING PUMP FILTER

⚠ During cleaning, some water may be spilled. It is therefore recommended to place an absorbent cloth on the floor.

Make sure the water has cooled down before you release it from the appliance.

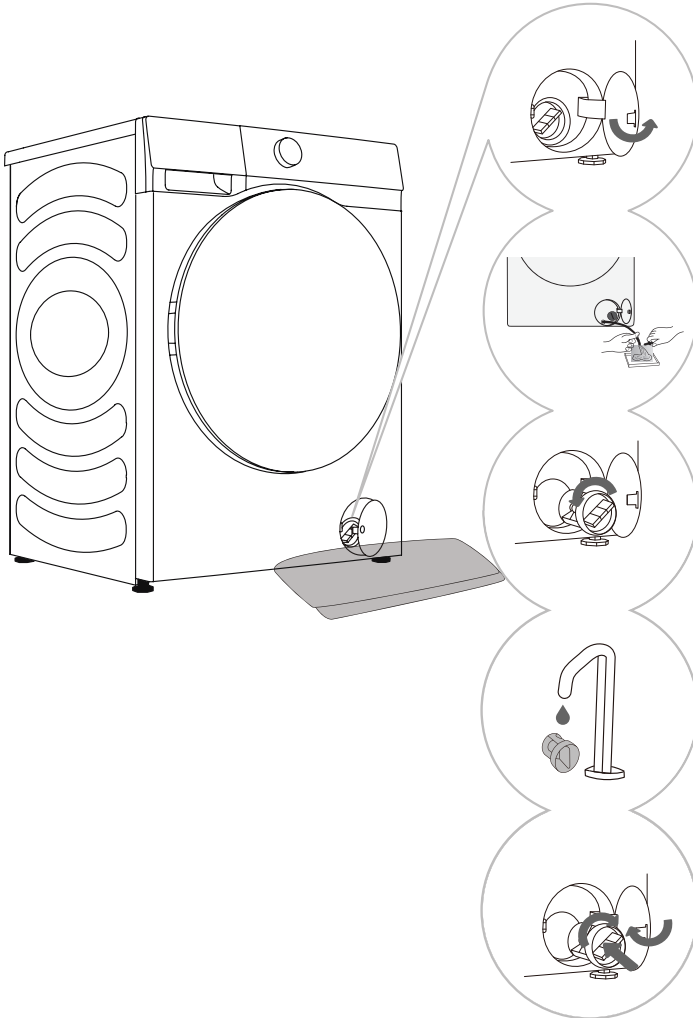

1 Open the pump filter cap using a suitable tool (press the door cover and the cap pops open).

2 Pull out emergency drain pipe of machine. Put end of emergency drain pipe into a container. Rotate emergency drain pipe plug and remove it after it becomes loose. Until water runs off naturally. Reinstall emergency drain pipe plug.

3 Rotate the pump filter slowly counter-clockwise. Pull out the pump filter to allow the water to drain slowly.

4 Clean the pump filter under running water.

5 Replace the pump filter as shown in the figure and fasten it by rotating it clockwise. For a good seal, the filter gasket surface should be clean.

⚠ The pump filter must be timely cleaned, especially after washing very fleecy, woolly, or very old laundry.

⚠ Also clean the pump filter if the appliance cannot start the spinning cycle or when there is debris in the pump (buttons, coins, hair pins or clips etc.).

CLEANING EXTERIOR

⚠ Always disconnect the washing machine from the power mains before cleaning.

Clean the washing machine exterior and display unit using a soft damp cotton cloth and water. Then, use a soft dry cloth to dry the appliance.

⚠ Do not use any solvents, abrasive cleaners, or cleaning agents that could damage the appliance (please observe the recommendations and warnings provided by the cleaning agent).

Wipe the drum door with a damp cloth, and then dry it with a soft dry cloth.

⚡ Do not clean the washing machine with a jet of water!

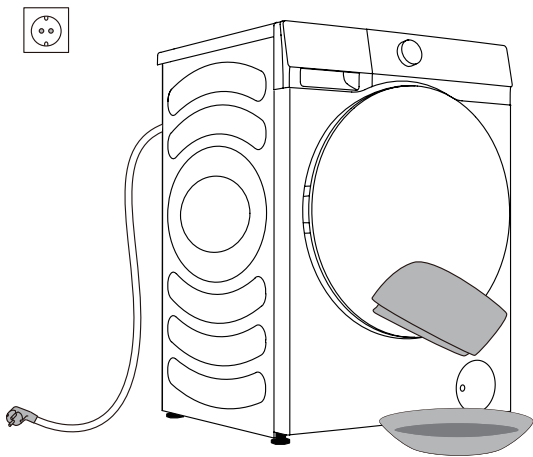

TROUBLESHOOTING

WHAT TO DO...?

The washing machine automatically controls the operation during the washing cycle. If any abnormality is identified, it will be indicated by a fault code (F:XX) on the display. The fault message will not disappear until the machine is shut down. External factors (e.g. the power grid) may cause various errors (see TROUBLESHOOTING TABLE). In such case:

- Switch off the washing machine and wait for a few seconds.
- Switch on the washing machine and repeat the washing program.
- Most errors during operation can be resolved by the user.
- If the error persists, call an authorized service unit.
- Repairs may only be carried out by an authorized technician.
- Repair or any warranty claim resulting from incorrect connection or use of the washing machine shall not be covered by the warranty. In such cases, the costs of repair shall be paid by the user.

⚡ The warranty does not cover the errors or failures resulting from disturbances from the environment (lightning strike, power grid failures, natural disasters etc.).

ERROR CODES AND TROUBLESHOOTING

Problem/error	Description	What to do?
F01	Water inflow fault	Check the following: <ul style="list-style-type: none"> • Is the water tap open? Is the pressure too low? • Is the water hose pinched? • Is the filter on the water hose clogged? • Is the hose frozen?
F03	Drainage fault	Check the following: <ul style="list-style-type: none"> • Is the hose pinched? Is water flowing through it? • Is the filter on the drain hose clogged? • Is the hose frozen?
F04/F05/F06/F07/ F23	Electronic module fault	Switch off the appliance by pressing the "POWER" button for 3 seconds. Press the "START/PAUSE" button again. If the error remains, call a service technician.
F24	Water reaches overflow level	Stop the program by pressing the START/PAUSE button. Restart the program. If the appliance continues to pump out water, close the water tap and call a service technician.
F13	Error in locking the door	Door is closed, but it cannot be locked. Turn off the appliance. Turn it on and restart the washing program. If the error remains, call a service technician.
F14	Error in unlocking the door	Door is closed, but it cannot be unlocked. Turn off the appliance, then turn it on. If the error remains, call a service technician.
Unb	Unbalance alarm	Solve Unbalance alarm in the following steps: <ol style="list-style-type: none"> 1. Laundry winding If articles have become tangled, press the "Power" button for 3 seconds to shut down, open the door, manually redistribute the load, and then select the single SPIN program to try again. 2. Too light-weighted laundry Press the "Power" button for 3 seconds to shut down the appliance, open the door, and add additional items, and then select the single SPIN program to try again.

RECOMMENDATIONS AND ECONOMIC USE

When washing colored clothes for the first time, separate them by color and wash them separately

Wash heavily soiled laundry in smaller amounts, with more powder detergent or with a pre-wash cycle.

Apply stain remover on stubborn stains before the wash. Refer to STAIN REMOVAL TIPS.

If you often wash laundry at low temperatures and with liquid detergents, bacteria may spawn which can cause odour in the washing machine. It is recommended to run the "Drum Clean" program to clean the drum.

Avoid washing very small load of laundry as this will lead to excessive use of energy and poor cleaning performance.

Loosen any folded laundry before putting it into the drum.

Only use detergents for washing machine.

If water hardness exceeds 14°dH, water softener should be used. Heater damage resulting from incorrect use of water softeners shall not be covered by the warranty. Check the information on water hardness with your local water supplier.

Use of chlorine-based bleaches is not recommended as they can damage the heater.

If you use a descaling agent, bleach, or dye, make sure it is suitable for use in the appliance.

Do not use solvents or similar chemicals (paint thinner, turpentine, gasoline, etc.)!

Do not add hardened clumpy powder detergent into the detergent dispenser as this may clog the piping in the washing machine.

Higher spinning speed will leave less residual moisture in the laundry. So it is more economical and faster to use a front-loading washing machine.

STAIN REMOVAL TIPS

Before using special-purpose stain removers, try using the natural methods that do not harm the environment to remove less stubborn stains.

Prompt action will make it easier to remove stains! Damp the stain and then rinse with cold (lukewarm) water - but never with hot water!

Stains	Stain removal
Mud	When the stain is dry, first scrape it off the garment before washing it in the washing machine. If the stain is stubborn, soak it with an enzyme-based stain remover before the wash. If the stain is not stubborn, remove it with liquid detergent or powder detergent manually before the wash.
Antiperspirant	Before washing in the washing machine, apply liquid detergent onto the laundry. Apply stain removers on any stubborn stains. Alternatively, use oxygen-based bleach for the wash.
Tea	Soak or rinse the laundry in cold water and add stain remover if necessary.
Chocolate	Soak or rinse the laundry with lukewarm soapy water. Then, apply lemon juice and rinse.
Ink	Before washing in the washing machine, apply stain removers on the stain. You may also use denatured alcohol. Turn the garment inside out and place a paper towel under the stain. Use the alcohol on the back side of the stain. At the end of the process, thoroughly rinse the garment.
Felt tip pens	Dilute some starch in water and apply it to the stain. When it dries, scrape it off with a brush; then, wash the garment in the washing machine.
Baby food (urine, mud, food stains)	Before washing in the washing machine, soak the stains in lukewarm water for at least half an hour. For easier stain removal, add an enzyme-based stain remover.
Grass	Before washing in the washing machine, soak the laundry in an enzyme-based stain remover. Grass stains can also be removed by soaking (for approx. 1 hour) in diluted lemon juice or distilled vinegar.
Eggs	Soak the garment in an enzyme-based stain remover. Soak in cold water for at least 30 minutes, or a few hours if the stains are stubborn. Then, wash in the washing machine.
Coffee	Soak the garment in salt water. If the stain is not fresh, soak it with a mixture of glycerine, ammonia and alcohol.
Shoe polish	Apply cooking oil to the stain and rinse.

Stains	Stain removal
Blood	Fresh stain - rinse the garment with cool water and wash it in the washing machine. Dried stain - soak the garment in an enzyme-based stain remover. Then, wash in the washing machine. If the stain does not vanish, try to remove it with a bleach suitable for your garment.
Glue, chewing gum	Place the garment in a bag and put it in the freezer until the stain hardens. Remove it with a blunt knife. Dilute the stain with a prewash stain remover and rinse thoroughly. Finally, wash in the washing machine.
Makeup	Use a stain remover for the prewash; then, wash in the washing machine.
Butter	Before washing in the washing machine, apply stain remover to the stain. Then, rinse with hot water (as hot as the fabric will allow).
Milk	Soak the garment in an enzyme-based stain remover. Soak for at least 30 minutes, or a few hours if the stains are stubborn. Then, wash in the washing machine.
Fruit juice	Apply a mixture of salt and water on the stain. Wait for a while and then rinse. You can also apply sodium bicarbonate, distilled vinegar or lemon juice on the stain before washing in the washing machine. For old stains, use glycerine, and after 20 minutes, rinse with cold water. Finally, wash in the washing machine.
Wine	Soak the laundry in cold water for at least 30 minutes. Also, use a stain remover. Then, wash in the washing machine.
Wax	Put the garment into the freezer until the wax hardens. Then, scrape it off. Place a paper towel onto the stain, remove the remaining wax by heating it with an iron until the paper absorbs the wax.
Sweat	Before washing in the washing machine, rub liquid detergent thoroughly into the stain.
Chewing gum	Put the garment into the freezer until the chewing gum hardens. Then, scrape it off. Then, wash in the washing machine.

DISPOSAL

The packaging is made of environmentally friendly materials that can be recycled, disposed of, or destroyed without hazard to the environment. To this end, packaging materials are labelled appropriately.



The symbol on the product or its packaging indicates that the product should not be treated as household waste. Take the product to your local recycling centre for waste electric and electronic equipment.

When **disposing** of the appliance at the end of its use life, remove all power cords, and destroy the door latch and switch to prevent the door from locking to ensure child safety.

This appliance is marked according to the European WEEE directive.

Correct **disposal** of the product will help prevent any negative effects on the environment and health of people, which could occur in case of improper disposal of the product. For detailed information on waste disposal, contact The relevant municipal body in charge of waste management, your waste disposal service, or the store where you bought the product.

TYPICAL CONSUMPTION TABLE

Programme Instructions

1. The Eco 40-60 programme is able to clean normally soiled cotton laundry declared to be washable about 40°C to 60°C together in the same cycle, and that this programme is used to assess the compliance with the EU ecodesign legislation.
2. The power consumption of the off-mode is 0.49W.
3. The most efficient programmes in terms of energy consumption are generally those that perform at lower temperatures and longer duration.
4. Loading the household washer dryer up to the capacity indicated by the manufacturer for the respective programmes will contribute to energy and water savings.
5. Correct use of detergent, softeners and other additives. Do not apply excessive detergent. This may affect the washing results adversely.
6. Periodic cleaning, including optimal frequency, and limescale prevention and procedure.
7. Noise and remaining moisture content are influenced by the spinning speed: the higher the spinning speed in the spinning phase the higher the noise and the lower the remaining moisture content.
8. The product information and QR code are reflected in the energy consumption label the product registration information can be obtained by scanning the QR code.
9. The information of standard programmes.

Program	Selected Temperature (°C)	Rated Capacity (kg)	Maximum temperature in drum (°C)	Program duration (h:min)	Energy consumption (kWh/cycle)	Water consumption (litres/cycle)	Remaining moisture content (%)	Maximum speed reached (rpm)
Eco40-60 full load	-	12.0	35	3:59	0.980	80.0	53.90	1400
Eco40-60 half load	-	6.0	26	3:00	0.430	48.0	53.90	1400
Eco40-60 1/4 load	-	3.0	24	2:20	0.210	34.0	53.90	1400
Cotton	20	12.0	20	2:18	0.400	140.0	55.00	1400
Cotton	60	12.0	58	3:38	2.140	140.0	55.00	1400
Synthetics	40	6.0	40	2:39	1.140	115.0	35.00	1400
Quick 15'	20	1.0	20	0:15	0.022	28.0	65.00	800

The values given for programmes other than the Eco 40-60 programme are indicative only.

 Maximum or nominal load applies to laundry prepared pursuant to the IEC 60456 standard.

 Due to deviations in terms of type and amount of laundry, spinning, power supply oscillation, and environment temperature and humidity, the programme duration and power consumption values measured at the end user may differ from the ones stated in the table.

We reserve the right to any changes and errors in the instructions for use.

Connecting your appliance to the application

ConnectLife

1. ConnectLife

ConnectLife is a smart home platform that connects people, devices, and services. The **ConnectLife** application includes advanced digital services and carefree solutions that allow users to monitor and control appliances, receive notifications from a smartphone, and update software (supported features vary depending on your appliance and your region/country).

To connect your smart device, you need a home Wi-Fi network and a smartphone with the application **ConnectLife**.



To download the **ConnectLife** application, scan the QR code or search for **ConnectLife** in your favorite app store.

1. Install the **ConnectLife** application and create an account.
2. In the **ConnectLife** application, go to the "+" menu and select the appropriate type of device. Then scan the SN code (it can be found on the upper part of the door frame; you can also enter the SN code manually).
3. The application then guides you through the entire process of connecting the appliance to your smartphone.
4. After a successful connection, the appliance can be operated remotely via the mobile application.

Do you have more questions? Visit us at www.connectlife.io or contact us at hello@connectlife.io.

2. WLAN

2.1 Enabling WLAN on the appliance

Click on the "**WLAN**" button in the top right corner of the dropdown menu to enable or disable the Wi-Fi Function.

2.2 Connection setup

For first start up: follow the boot to complete device Settings and App account binding.

If you have reject to finish the WLAN setting and binding ,you can start like below:

- 1) Click on the "**Settings**" button in the top right corner of the dropdown menu to enter the "**Settings**", and go to "**WLAN**" settings to set up the WLAN;
- 2) Or Long press on the "**WLAN**" button in the top right corner of the dropdown menu to enter the "**WLAN**" directly .

2.3 Pairing

Click on the "**Settings**" button in the top right corner of the dropdown menu to enter the "**Settings**" page.

- 1) Click on "**App and Pairing**" to enter the pairing page.
- 2) Click on "**Bind A New Account**" to start the pairing process for a new user.
- 3) Click "**Next**" and the dedicated QR code will be shown up for device pairing.

2.4 Unpairing

- 1) On the appliance side:
 - A. Click on the "**Settings**" button in the top right corner of the dropdown menu to enter the "**Settings**" page.
 - B. Click on "**App and Pairing**" to enter the pairing page.
 - C. Click on "**Unbind**" to unbind the connected account.
 - D. Tick the accounts that you want to unbind and click "**Unbind**" to disconnect.
- 2) On the smartphone side:
 - A. Select and click the device you want to unbind in "**Devices**" page.
 - B. Click "**Settings**" to enter the Settings page.
 - C. Click "**Remove Device**" to unbind the device on the **ConnectLife** app.

2.5 Remote start

Click on "**Remote Control**" button in the top right corner of the dropdown menu to enable or disable this function.

2.6 System Upgrade

Click on the "**Settings**" button in the top right corner of the dropdown menu to enter the "**Settings**" page. Then click to open "**System**" page. Chose "**System Upgrade**", then you can check whether new version have been released or not.

Hisense

life reimagined